

Walworth County
Tax Key Structure

- All Walworth County Tax Key Numbers have a minimum of 11 characters including spaces.
- For Example: GNLS_ _ 00028 = 11 characters
- Other Examples are shown in the table below.

Municipality (1- Character)	Subdivision (5 – Characters)	Sequence (5+ –Characters)
<u>G</u>	<u>N</u> <u>L</u> <u>S</u> _ _	<u>0</u> <u>0</u> <u>0</u> <u>2</u> <u>8</u>
<u>K</u>	_ <u>L</u> <u>F</u> _ <u>8</u>	<u>0</u> <u>0</u> <u>0</u> <u>0</u> <u>7</u>
<u>J</u>	<u>L</u> <u>C</u> <u>B</u> _ _	<u>0</u> <u>0</u> <u>0</u> <u>0</u> <u>1</u>
<u>E</u>	<u>T</u> _ _ <u>1</u> <u>3</u>	<u>0</u> <u>0</u> <u>0</u> <u>1</u> <u>4</u>

- **Municipality (1-Character) -**
 - Designates the municipality that the property is located in. For example the letter Z designates the City of Lake Geneva.
- **Subdivision (5-Characters) -**
 - Designates the Subdivision or Certified Survey Map that the property is part of. For example, Certified Survey Map (CSM) 4061, Lot 1 in the Town of Lafayette would look like this.
(Ex. KA406100001)
- **Sequence (5+ - Characters) -**
 - Generally, it designates the sequence that the property was platted. For example, Lot 7 of a subdivision would have the 7 designation at the end of the sequence (Ex. JLCB_ _ 00007)

Tax Key Structure Diagram -

Parcel Symbology

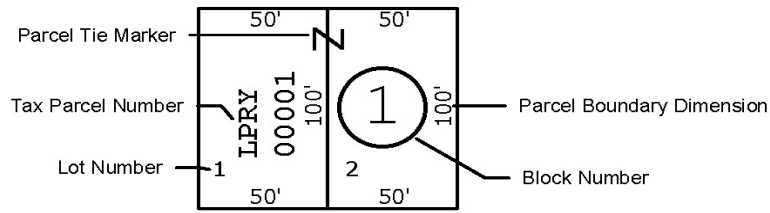

Walworth County Tax Key Structure

Tax Key Structure for Unplatted and Platted Lands Except Certified Survey Maps

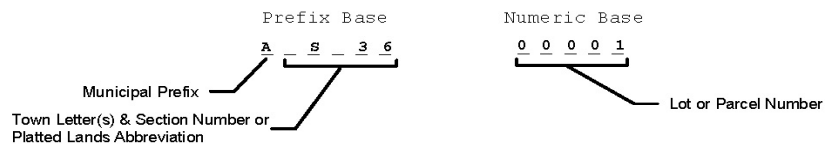

Tax Key Structure for Certified Survey Maps

