

524.59'

82.1'

524.59'

South line of Section 30, Town 4 north, Range 18 east.

DESCRIPTION:

Commencing at the intersection of the south line of Section 30, Town 4 north, Range 18 east of the 4th Principal Meridian and the centerline of County Trunk Highway "G"; thence N. 5° 36' E., 82.5 feet to a point, thence West 526.54 feet to an iron stake, thence South 82.1 feet to a point in the south line of the aforesaid Section 30, thence East 524.59 feet along the said section line to the place of beginning.

CERTIFICATE:

I, hereby certify that I have on this the 16th day of April 1952., surveyed the above described property according to the official records on file in the office of the Recorder of Deeds in and for Walworth County, Wisconsin, and find that the measurements and bearings of the boundary lines of said property as taken at the site on this day substantially agree with those in said official record and that no encroachments exist.

SIGNED AND SEALED ON THIS THE 17TH DAY OF APRIL 1952.

*Joseph M. Biagi*  
Joseph M. Biagi, Professional Engineer.  
Elkhorn Wisconsin.

ET-30-1B (part of)

418-94B

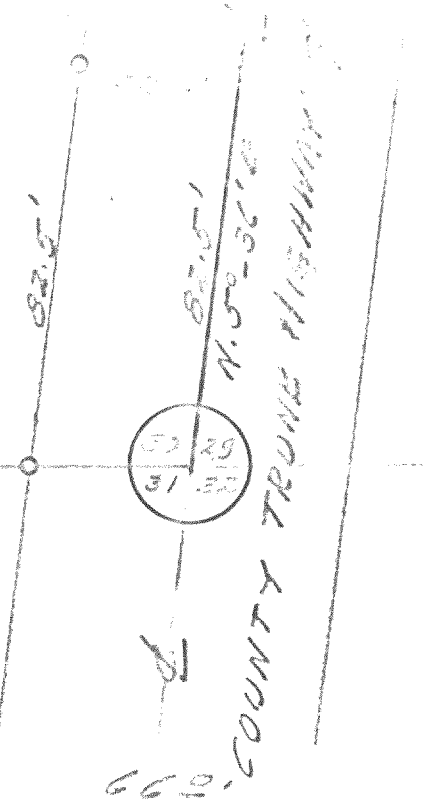

68-65