

NOTE:

BOUNDARIES OF PROPERTY DETERMINED FROM EVIDENCE OF OCCUPATION AND MONUMENTATION AS FOUND IN FIELD

NET AREA
127,475 SQ. FT.
2.9264 ACRES

SITUATED ON BEACH ROAD, IN THE TOWN OF EAST TROY, WISCONSIN.
PARCEL A: COMMENCING AT A POINT IN THE NORTH LINE OF SECTION 9, T 4 N, R 18 E, OF THE FOURTH PRINCIPAL MERIDIAN, 353.00 FT. WEST OF THE NORTHEAST CORNER OF SAID SECTION 9;
 THENCE SOUTH 01° 24' 00" WEST 537.58 FT. TO A POINT;
 THENCE SOUTH 80° 48' 00" WEST 115.58 FT. TO AN IRON STAKE;
 THENCE SOUTH 57° 40' 00" WEST 91.50 FT. TO A POINT IN THE CENTER LINE OF THE ROAD BORDERING UPON LAKE BEULAH;
 THENCE NORTH 19° 42' 00" WEST 24.25 FT. ALONG THE CENTER LINE OF SAID ROAD TO AN IRON PIPE;
 THENCE NORTH 55° 07' 00" WEST 15.75 FT. ALONG THE CENTER LINE OF SAID ROAD TO AN IRON STAKE;
 THENCE SOUTH 34° 53' 00" WEST 23.00 FT. TO A POINT IN THE SHORE OF BEULAH LAKE;
 THENCE NORTHWESTERLY ALONG THE SHORE OF SAID BEULAH LAKE TO A POINT THAT IS 22.62 FT. SOUTH 02° 34' 00" WEST OF AND 154.55 FT. NORTH 55° 07' 00" WEST OF THE LAST MENTIONED POINT IN THE CENTER OF THE ROAD;
 THENCE NORTH 02° 34' 00" EAST 139.84 FT. TO A POINT;
 THENCE SOUTH 84° 41' 00" EAST 60.95 FT. TO AN IRON STAKE;
 THENCE NORTH 05° 03' 00" WEST 96.44 FT. TO AN IRON STAKE IN THE SOUTH LINE OF SAID LOT 1 IN MC GRAMS PARK SUBDIVISION;
 THENCE NORTH 82° 45' 00" EAST 103.31 FT. ALONG THE SOUTH LINE OF SAID LOT 1 TO THE SOUTHEAST CORNER OF SAID LOT 1;
 THENCE NORTHWESTERLY ALONG THE EASTERLY LINE OF LOTS 1 AND 2 IN SAID MC GRAMS PARK SUBDIVISION 100.00 FT. TO THE NORTHEAST CORNER OF SAID LOT 2;
 THENCE NORTHEAST TO THE SOUTHEAST CORNER OF LOT 3 IN SAID SUBDIVISION;
 THENCE NORTH 03° 25' 00" WEST 174.75 FT. TO A POINT IN THE NORTH LINE OF SAID SECTION 9;
 THENCE EAST IN THE NORTH LINE OF SAID SECTION 190.00 FT. TO THE PLACE OF BEGINNING.

EXCEPTING THEREFROM THE FOLLOWING DESCRIBED PARCELS OF LAND:
PARCEL 1: COMMENCING AT A POINT IN THE NORTH LINE OF SECTION 9, T 4 N, R 18 E OF THE FOURTH PRINCIPAL MERIDIAN, 543.00 FT. WEST OF THE NORTHEAST CORNER OF SAID SECTION 9;
 THENCE SOUTH 03° 25' 00" EAST 124.75 FT. TO AN IRON STAKE;
 THENCE EAST 50.00 FT. TO AN IRON STAKE;
 THENCE NORTH 03° 25' 00" WEST 124.75 FT. TO A POINT IN THE NORTH LINE OF SAID SECTION 9;
 THENCE WEST IN THE NORTH LINE OF SAID SECTION 50.00 FT. TO THE PLACE OF BEGINNING.
PARCEL 2: COMMENCING AT A POINT IN THE NORTH LINE OF SECTION 9, T 4 N, R 18 E, OF THE FOURTH PRINCIPAL MERIDIAN, 493.00 FT. WEST OF THE NORTHEAST CORNER OF SAID SECTION 9;
 THENCE SOUTH 03° 25' 00" EAST 124.75 FT. TO AN IRON STAKE;
 THENCE EAST 50.00 FT. TO AN IRON STAKE;
 THENCE NORTH 03° 25' 00" WEST 124.75 FT. TO A POINT IN THE NORTH LINE OF SAID SECTION 9;
 THENCE WEST IN THE NORTH LINE OF SAID SECTION 50.00 FT. TO THE PLACE OF BEGINNING.
PARCEL 3: COMMENCING AT A POINT IN THE NORTH LINE OF SECTION 9, T 4 N, R 18 E, OF THE FOURTH PRINCIPAL MERIDIAN, 443.00 FT. WEST OF THE NORTHEAST CORNER OF SAID SECTION 9;
 THENCE SOUTH 03° 25' 00" EAST 124.75 FT. TO AN IRON STAKE;
 THENCE EAST 50.00 FT. TO AN IRON STAKE;
 THENCE NORTH 03° 25' 00" WEST 124.75 FT. TO A POINT IN THE NORTH LINE OF SAID SECTION 9;
 THENCE WEST IN THE NORTH LINE OF SAID SECTION 50.00 FT. TO THE PLACE OF BEGINNING, TOWN OF EAST TROY, WALWORTH COUNTY, WISCONSIN.
PARCEL B: OUTLOT 1 OF CERTIFIED SURVEY MAP NO. 784, ACCORDING TO THE PLAT THEREOF RECORDED MAY 04, 1978 IN VOLUME 3 OF CERTIFIED SURVEYS ON PAGES 319 AND 320 AS DOCUMENT NO. 32170.
 OCTOBER 14, 1991 TRI CITY NATIONAL BANK SURVEY NO. 154361-S

SCALE 1"=30'-00"

I Certify that I have surveyed the above described property (Property), and the above map is a true representation thereof and shows the size and location of the Property, its exterior boundaries, the location and dimensions of all visible structures thereon, boundary fences, apparent easements and roadways and visible encroachments, if any. This survey is made for the exclusive use of the present owners of the Property, and of all those who purchase, mortgage, or guarantee the title thereto, within one (1) year from date hereof.

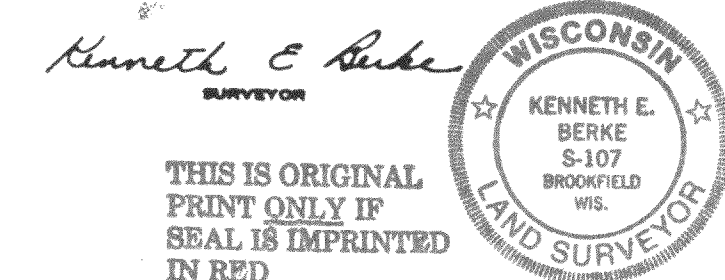

THIS IS ORIGINAL PRINT ONLY IF SEAL IS IMPRINTED IN RED

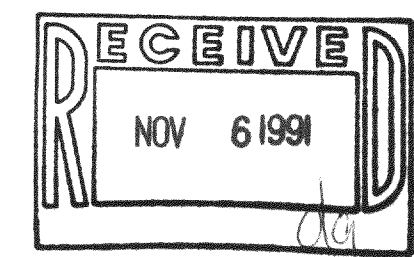

PET 90001D PA 7840000

418-743