

RECEIVED
FEB - 9 1969

PREPARED FOR: R J M Builders - KLUMB, Richard

LEGAL DESCRIPTION: Parcel 1 in Certified Survey Map No. 1584, being a part of the SW 1/4 of the NE 1/4 of Section 15, T 4 N, R 18 E, in the Town of East Troy, Walworth County, Wisconsin.

Survey No. 870145

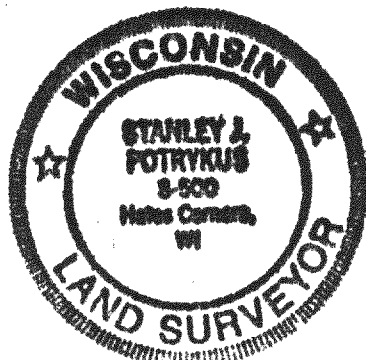

Signed

STANLEY J. POTRYKUS — REGISTERED LAND SURVEYOR S-500

418-659