

LAKE
BEULAH

PLAT OF SURVEY

EASTERLY 42' OF LOT 1 THE WHITE SUBDIVISION, BEING A PART OF THE WEST 1/2
OF SECTION 17, TOWN 4 NORTH, RANGE 18 EAST, IN THE TOWN OF EAST TROY,
WALWORTH COUNTY, WISCONSIN.

PROPERTY ADDRESS: W2056 KINGS LANE
CLIENT: PATRICK/KELLY MCGINNIS

FOUND IRON PIPE IS
N12°43'18"E 0.48'
OF ACTUAL CORNER

SCALE 1"=20'

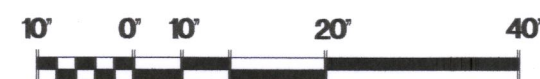

BEARINGS ARE REFERENCED TO THE WEST
LINE OF THE SOUTHWEST 1/4 OF SECTION
17-4-18 AND IS ASSUMED TO BEAR
N00°22'39"E, (NAD27).

- FOUND 1 1/4" O.D. IRON PIPE
- FOUND 3/4" PIN
- * FOUND MAG NAIL
- ✕ SET MAG NAIL
- () RECORDED AS DIMENSIONS

11364± SQ. FT.
0.26± ACRES



KINGS

LANE

"I hereby certify that I have surveyed the above property
and that the above map is a true representation thereof
and shows the size and location of the property, its exterior
boundaries, the location of all visible structures and dimensions
of all principal buildings thereon, boundary fences, apparent
easements, roadways and encroachments if any."

"This survey is made for the use of the present owners of
the property, and also those who purchase, mortgage or
guarantee the title thereto within one year from date hereof."

11/5/2020
DATE

TEP
FIELD WORK BY

TEP
DRAWN BY

20121
JOB NUMBER

Kettle Moraine Surveying Inc.
P.O. Box 357
Eagle WI. 53119
(262)594-3484
kettlemorainesurveying.com

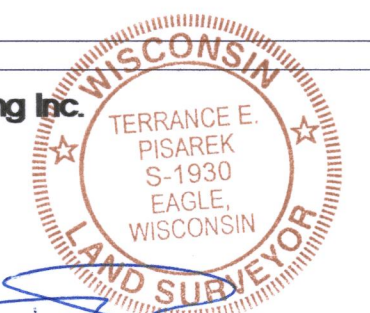

THIS IS NOT AN ORIGINAL SURVEY UNLESS THE SEAL IS RED.

PWH-4

418-2766

418-9100