



PLAT OF SURVEY
 -FOR-
 PROPOSED LOT LINE ADJUSTMENT
 -OF-

EXISTING PARCEL: TAX PARCEL NO. PET2800003

THE SOUTHWEST 1/4 OF THE NORTHEAST 1/4 AND THE NORTHWEST 1/4 OF SECTION 28, TOWNSHIP 4 NORTH, RANGE 18 EAST OF THE FOURTH PRINCIPAL MERIDIAN, IN THE TOWN OF EAST TROY, WALWORTH COUNTY, WISCONSIN. EXCEPTING THEREFROM: LOT 1 OF CERTIFIED SURVEY MAP NO. 4235, RECORDED IN VOLUME 27 OF CERTIFIED SURVEY MAPS, PAGE 77 AS DOCUMENT NO. 765816 IN THE OFFICE OF THE REGISTER OF DEEDS IN AND FOR WALWORTH COUNTY WISCONSIN, BEING LOCATED IN THE NORTHEAST 1/4 AND THE SOUTHEAST 1/4 OF SECTION 28, TOWNSHIP 4 NORTH, RANGE 18 EAST OF THE FOURTH PRINCIPAL MERIDIAN, IN THE TOWN OF EAST TROY, WALWORTH COUNTY, WISCONSIN.

PROPOSED LANDS TO BE ADDED BY LOT LINE ADJUSTMENT: PART OF TAX PARCEL NO PET2800002

THE SOUTHEAST 1/4 OF THE NORTHEAST 1/4 OF SECTION 28, TOWNSHIP 4 NORTH, RANGE 18 EAST OF THE FOURTH PRINCIPAL MERIDIAN, IN THE TOWN OF EAST TROY, WALWORTH COUNTY, WISCONSIN. EXCEPTING THEREFROM: THAT PART OF THE SOUTHEAST 1/4 OF THE NORTHEAST 1/4 OF SECTION 28, TOWNSHIP 4 NORTH, RANGE 18 EAST CONSISTING OF 1-1/4 ACRES, MORE OR LESS, WHICH STARTS AT A POINT ON THE EAST LINE OF SAID NORTHEAST 1/4 336 FEET AND 4 INCHES NORTH OF THE SOUTHEAST CORNER OF SAID NORTHEAST 1/4 AND RUNS 161 FEET WEST, THENCE NORTH 337 FEET AND 5 INCHES, THENCE EAST 161 FEET AND THEN SOUTH TO THE POINT OF BEGINNING. SAID LAND BEING IN THE TOWN OF EAST TROY, COUNTY OF WALWORTH COUNTY AND STATE OF WISCONSIN.

ALSO EXCEPTING THEREFROM: THAT PART OF THE SOUTHEAST 1/4 OF THE NORTHEAST 1/4 OF SECTION 28, TOWNSHIP 4 NORTH, RANGE 18 EAST OF THE FOURTH PRINCIPAL MERIDIAN, IN THE TOWN OF EAST TROY, WALWORTH COUNTY, WISCONSIN AND BEING MORE PARTICULARLY DESCRIBED AS FOLLOWS: COMMENCE AT THE EAST 1/4 CORNER OF SAID SECTION 28; THENCE SOUTH 89°02'35" WEST ALONG THE SOUTH LINE OF SAID NORTHEAST 1/4 SECTION 633.00 FEET TO THE PLACE OF BEGINNING OF THIS DESCRIPTION; THENCE CONTINUE SOUTH 89°02'35" WEST ALONG SAID SOUTH LINE 687.97 FEET; THENCE NORTH 00°16'25" WEST 738.72 FEET; THENCE NORTH 89°59'58" EAST 630.02 FEET; THENCE SOUTH 04°49'29" EAST 729.81 FEET TO THE PLACE OF BEGINNING. CONTAINING 11.06 ACRES OF LAND MORE OR LESS.

SURVEY FOR: RACHEL ANDERSON

(EXCEPT AS SHOWN)
 MONUMENTATION BY WRITTEN AGREEMENT
 WITH RACHEL ANDERSON HAS BEEN
 WAIVED IN ACCORDANCE WITH A-E 7.01(2)
 OF THE WISCONSIN ADMINISTRATIVE CODE.

RACHEL ANDERSON

B.W. SURVEYING, INC.

412 N. PINE STREET
 BURLINGTON, WI 53105
 (262)-767-0225

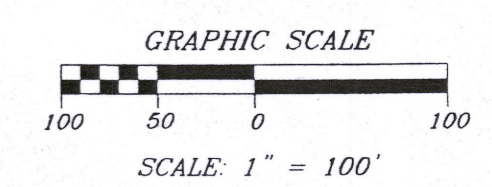
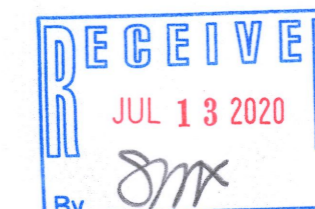
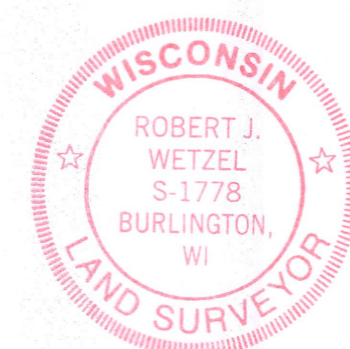
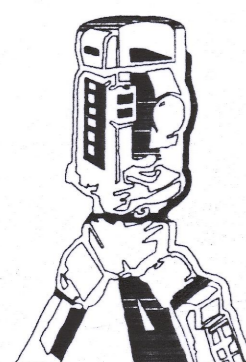

LEGEND

- FOUND RACINE COUNTY MONUMENT (CONCRETE/CAP)
- SET IRON PIPE
- SOIL BORING

"THIS LOT LINE ADJUSTMENT IS FOR THE PURPOSE OF A SALE OR EXCHANGE OF LAND BETWEEN ADJOINING LAND OWNERS THAT DOES NOT CREATE ADDITIONAL LOTS AND THE ORIGINAL PARCELS ARE NOT REDUCED BELOW THE MINIMUM SIZE REQUIRED BY THE WALWORTH COUNTY CODE OF ORDINANCES (ZONING/SHOARELAND ZONING)."

THIS IS NOT AN ORIGINAL PRINT UNLESS THIS SEAL IS RED.

Robert J. Wetzel
 ROBERT J. WETZEL
 S-1778

DRAWN BY:	bw	DATE:	FEBRUARY 24, 2020
CHECKED BY:	rw/dw	DRAWING NO.:	10053-LLA
JOB NO.:	10053	SHEET	1 OF 1

418-2111

PET 28-2B