

BOUNDARY & TOPOGRAPHIC SURVEY LOT 3 OF LAKE BEULAH CLUB SUBDIVISION

LOCATED IN THE NE 1/4 SECTION 18
TOWN 4 NORTH, RANGE 18 EAST
WALWORTH COUNTY, WI.



ORDERED BY:
THELEN TOTAL CONSTRUCTION
PO BOX 17
ELKHORN, WI. 53121

FARRIS, HANSEN & ASSOCIATES, INC.
ENGINEERING - ARCHITECTURE - SURVEYING
7 RIDGWAY COURT P.O. BOX 437
ELKHORN, WISCONSIN 53121
OFFICE: (262) 723-2098 FAX: (262) 723-5886

REVISIONS

PROJECT NO.
8939
DATE:
12-20-2013
SHEET NO.
1 OF 1

BENCH MARK
PK NAIL IN PAVEMENT
EL. = 866.66'

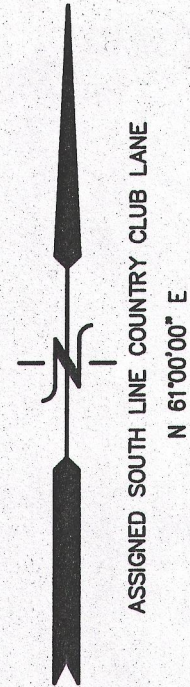

COUNTRY CLUB LANE
20' WIDE
N 61°00'00\"/>

EXISTING GARAGE
FLOOR EL. = 868.2'

LOT 3

LOT WIDTH @ SETBACK
82.42'
16% MIN SY = 13.18'

SEPTIC LID *

LOT 4

BENCH MARK
NAIL IN 30' OAK
EL. = 856.78'

EXISTING RESIDENCE
FLOOR EL. = 857.9'

EXISTING PORCH

AS BUILT
RESIDENCE

16.0

10.0

22.2

8.0

14.67

8.0

16.0

15.5'

14.9'

11.1'

18' +/-

100' +/- ALONG THE SHORE

ICE EL. = 808.0'

WOOD RET. WALLS

EXISTING BOAT HOUSE

CONCRETE STEPS

EXISTING RAILS FOR TRIM

CONCRETE WALK

PAVED DRIVE

WELL

WELL

WELL

WELL

WELL

LEGEND
O = FOUND IRON PIPE STAKE
* = FOUND PK NAIL
(XXX) = RECORDED AS
AREA = 24,565 S.F. 0.56 AC.

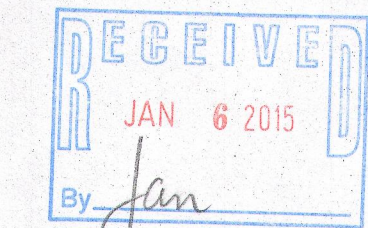

NOTE: COPIES OF THIS MAP TO WHICH THE FOLLOWING CERTIFICATE
WILL APPLY SHOW THE SURVEYOR'S ORIGINAL SEAL AND SIGNATURE
IN RED INK. COPIES BY ANY OTHER MEANS MAY HAVE ALTERATIONS
WHICH DO NOT REPRESENT THE SURVEYOR'S WORK PRODUCT.

I HEREBY CERTIFY THAT THE ABOVE DESCRIBED PROPERTY HAS BEEN
SURVEYED UNDER MY DIRECTION AND THAT THE ABOVE MAP IS A TRUE
REPRESENTATION THEREOF AND SHOWS THE SIZE AND LOCATION OF
THE PROPERTY AND ITS EXTERIOR BOUNDARIES. THIS SURVEY IS
MADE FOR THE USE OF THE PRESENT OWNERS OF THE PROPERTY, AND
ALSO THOSE WHO PURCHASE, MORTGAGE, OR GUARANTEE THE TITLE
THERETO WITHIN ONE YEAR FROM THE DATE HEREOF.

DATED: DECEMBER 26, 2013

REVISED 11-21-2014
TO SHW AS BUILT
RESIDENCE

PETER S. GORDON
R.L.S. 2101

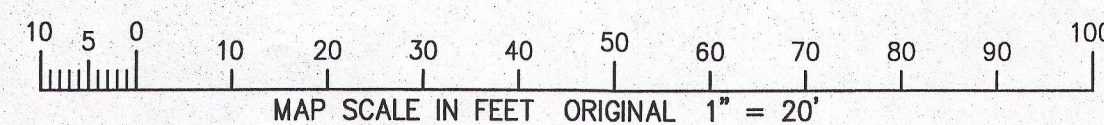
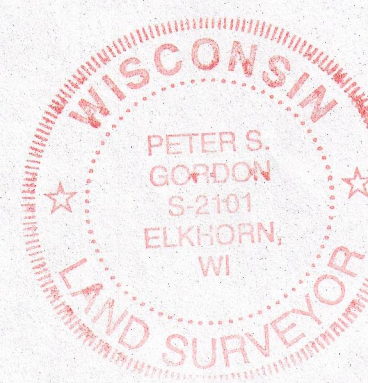

NOV 21 2014

11/21/2014 X:\Projects\8939\dcad\survey

PL-3 418-2431