

# PLAT OF SURVEY

FOR LOT 19 OF TROY HILL ESTATES, AND BEING A PART OF THE NE 1/4 OF THE SOUTHWEST QUARTER OF SECTION 30, TOWN 4 NORTH, RANGE 18 EAST, TOWN OF EAST TROY, WALWORTH COUNTY, WISCONSIN.

LOT 26

3/4" REBAR

S 89°-08'-32" W 166.02'

3/4" REBAR

30' DRAINAGE EASEMENT

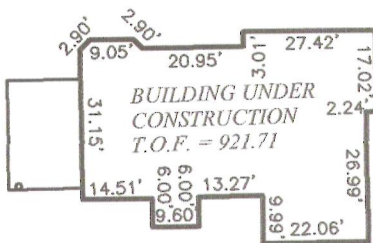

## DETAIL

LOT 20

LOT 19  
43,595 SQ. FT.

LOT 18

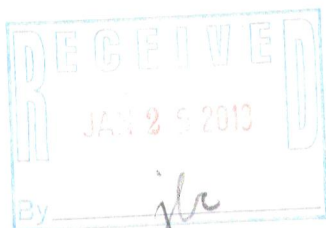

NOTE: PROPOSED GRADES ARE FROM THE MASTER GRADING PLAN AND ARE SUBJECT TO CHANGE BASED ON THE COUNTY REVIEW.

3/4" REBAR

N 89°-08'-32" E 166.02'

EDGE OF PAVEMENT

**TROY HILL COURT**

(66' R-O-W)

N 54°-34'-06" E 1396.18'

S.W. CORNER OF SECTION 30-04-18 MON. OF RECORD

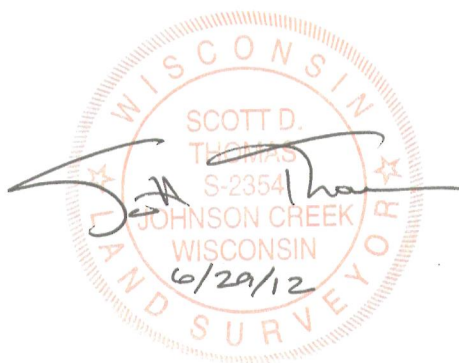

IF THE SURVEYOR'S SEAL IS NOT WET STAMPED IN RED AND SIGNED IN OPPOSABLE INK, THE PLAT IS A COPY THAT SHOULD BE ASSUMED TO CONTAIN UN-AUTHORIZED ALTERATIONS. THE CERTIFICATION CONTAINED ON THIS DOCUMENT DOES NOT APPLY TO COPIES INCLUDING DIGITAL REPRODUCTIONS.

BEARINGS ARE REFERENCED TO THE WEST LINE OF THE SOUTHWEST QUARTER OF SECTION 30-04-18, WHICH IS ASSUMED TO BEAR N 00°-07'-27" W.

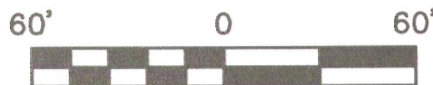

State of Wisconsin }  
County of Jefferson } SS.

We, Holland & Thomas, L.L.C., do hereby certify that we have made this survey and that the information as shown on the above Plat of Survey is a true and correct representation thereof. Lots are drawn from subdivision plats/C.S.M.s; unplatted lands from recorded deeds/surveys. Boundary survey plats reflect field-located information; consult a title attorney to discover all the legal encumbrances attached to any property.

### LEGEND: These standard symbols may be found in the drawing.

- P.L.S.S. Monument (w/desc.)
- Lot Corner (Found) w/desc.
- Lot Corner (Set) w/desc.
- Elec. Trans. Box
- Utility Pedestal
- Easement Boundary
- Building Setback Line

OWNER: Moskanos/Davidson

BUILDER: Victory Homes of Wisconsin  
N56 W16688 Ridgewood Drive  
Menomonee Falls, WI 53051  
PH: (262) 252-7100  
FAX: (262) 252-7109  
www.victoryhomesofwisconsin.com

PTHE 00019

418-2308