

Tax Parcel
PET 800008L

Lot 1
C.S.M. 1847

Tax Parcel
PA184700002

5.021 Acres
218,710 Sq.Ft.

Lot 2

Lot 127
Beulah Heights

Plat of Survey

of

Lot 2 and part of Lot 1 of Certified Survey Map No. 1847,

recorded in Vol. 8 of Certified Survey Maps of Walworth County on Page 357 and located in the Southwest 1/4 of Section 8, Town 4 North, Range 18 East, Town of East Troy, Walworth County, Wisconsin.

Said part of Lot 1 as described in a Quit Claim Deed recorded February 2, 2004 as Document No. 592028 as shown below:
The Southerly 3.5' of Lot 1 of Certified Survey Map No. 1847, recorded in Vol. 8 of Certified Survey Maps of Walworth County on Page 357 and located in the Southwest 1/4 of Section 8, Town 4 North, Range 18 East, Town of East Troy, Walworth County, Wisconsin, more particularly described as follows:

Begin at an iron pipe on the Westerly line of a 50' wide right-of-way, said pipe marking the Southeastern corner of said Lot 1; thence South 56°03'32" West, along the Southerly line of said Lot 1, 473.08 feet to an iron pipe on the meander line of a canal, said pipe being approximately 23.4 feet North 56°03'32" East of the shore of said canal; thence North 48°51'18" West, along said meander line, 3.62 feet to an iron rod, said rod being approximately 24.4 feet North 56°03'32" East of the shore of said canal; thence North 56°03'32" East 475.12 feet to an iron rod on the Westerly line of said 50' wide right-of-way; thence South 16°18'43" East, along said Westerly line, 3.67 feet to the Point of Beginning.

Also to include the lands lying between the above described meander line and the shore of the canal as encompassed by the above described bearings and distances from said meander line to the shore.
Said parcel contains 0.040 acre (1,743 sq. ft.) of land, more or less.

Surveyed for: **Estate of Odilia M. Zielinski**
1046 Ryans Run
Boothwyn, Pennsylvania. 19061

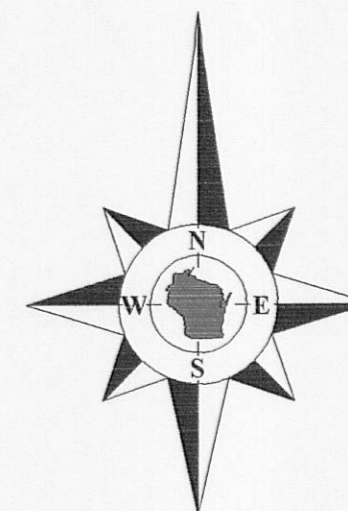

Bearings reference to Certified
Survey Map No. 1847.

Copyright 2010 by Jensen & Olson Land Surveying, LLC.

All rights reserved. No part of this survey plat may be reproduced or transmitted in any form by any means - graphic, electronic, or mechanical, including photocopying, tracing, or information storage and retrieval systems - without permission in writing from Douglas G. Olson, Jensen & Olson Land Surveying, LLC.

I hereby certify that I have surveyed the above described property and the map hereon is correct to the best of my professional knowledge and belief and shows the size and location of the property, its exterior boundaries, the location and dimensions of all visible structures thereon, boundary fences, apparent easements and roadways and visible encroachments, if any.

This survey is made for the exclusive use of the present owners of the property, and also those who purchase, mortgage or guarantee title thereto, within one year from the date hereof.

Douglas G. Olson
Wisconsin Registered Land Surveyor - 2093

Note from Certified Survey Map No. 1847.

Homesite shall be limited to the following:

Lot 2: Beginning with the northeasterly corner of said lot, 200' in a westerly direction along said property line, 175' south/southeasterly, 200' easterly back to said 50' wide roadway and 175' feet back to the place of origin.

This limitation on homesites shall be recorded along with the certified survey map and shall be binding upon all of the owners, successors and assigns of said properties.

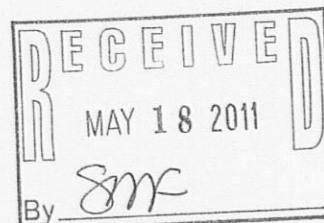

Notes:

- 1) This survey plat is not certified unless signed and sealed in red ink.
- 2) This survey is subject to Wisconsin lien laws. This Plat of Survey is the notice of intent to file lien. Lien waiver required.

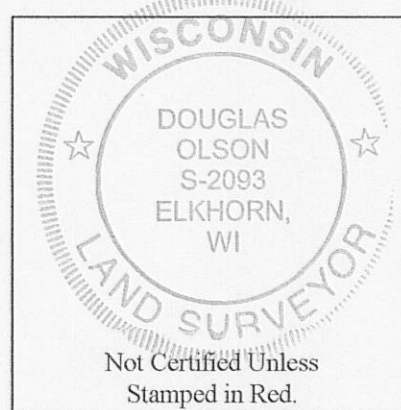

Survey Date: October 4, 2010.
Revisions:

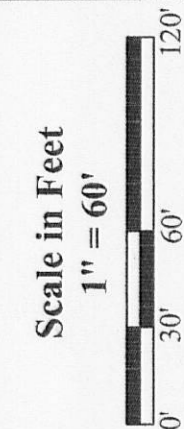

Jensen & Olson Land Surveying, LLC
45 South Wisconsin Street * P.O. Box 322 * Elkhorn, Wisconsin. 53121
Telephone: (262) 723-3434 * Facsimile: (262) 723-8044
Email: jensen.olson@elknet.net

Legend
Found Iron Pipe
Found Iron Rod
Recorded Information
Utility Pole
Utility Pedestal
Asphalt Surface
Gravel Surface

Sheet 1 of 1 Sheets
Job Reference Number
2010.068 A
2010.068 A