

PREPARED FOR  
LARRY PAYNE  
W1532 HONEY CREEK RD.  
EAST TROY WI 53120

# PLAT OF SURVEY

-OF-

**KROTT SURVEYING INC.**  
N3705 WILLOW BEND LANE  
LAKE GENEVA WI. 53147  
PHONE # (262)248-3697  
FAX # (262)249-0639

PARCEL "A" OF CERTIFIED SURVEY MAP NO. 766 LOCATED IN THE  
NORTHWEST 1/4 OF SECTION 33, TOWN 4 NORTH, RANGE 18 EAST,  
WALWORTH COUNTY, WISCONSIN.



**LEGEND**

- FOUND IRON PIPE
- FOUND IRON BAR
- ⊕ FOUND COUNTY MONUMENT
- ⊙ WELL
- ⊕ CONCRETE LID
- ⊙ SPOT ELV.
- × RECORDED AS

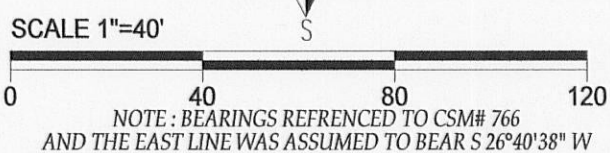

I have surveyed the above-described property and the above map is a true representation thereof and shows the size and location of the property, its exterior boundaries, the location and dimensions of all structures thereon, fences apparent easements and roadways and visible encroachments, if any.

This survey is made for the exclusive use of the present owners of the property, and also those who purchase, mortgage, or insure the title thereto within one (1) year from date hereof, and as to them I warrant the accuracy of said survey map.

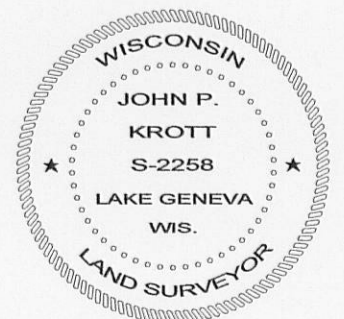
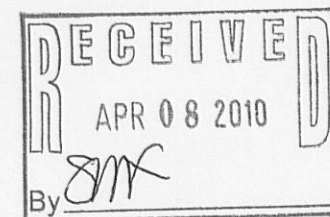

*John P. Krott*

JOHN KROTT S - 2258  
Wisconsin Registered Land Surveyor  
(original if signed in red)

DATED THIS 22nd DAY OF FEBRUARY 2010.

TAX ID # PA76600001  
JOB # 10-024

418-2176