

**PLAT OF SURVEY**  
-OF-

LOT 1 OF CERTIFIED SURVEY MAP NO. 3445 AS RECORDED IN VOLUME 20 OF CERTIFIED SURVEY MAPS ON PAGE 48 IN THE OFFICE OF THE REGISTER OF DEEDS IN AND FOR WALWORTH COUNTY, WISCONSIN, BEING LOCATED IN PART OF THE NORTHWEST 1/4 OF THE SOUTHEAST 1/4 OF SECTION 34, TOWNSHIP 4 NORTH, RANGE 18 EAST OF THE FOURTH PRINCIPAL MERIDIAN, IN THE TOWNSHIP OF EAST TROY, WALWORTH COUNTY, WISCONSIN.

SURVEY FOR: CINDY BRUINSMA      PROPOSED ADDRESS: \_\_\_\_\_ KOSSO DRIVE

PROPOSED DWELLING AND SHED WERE STAKED ON ACTUAL CORNERS WITH 7 FOOT CONTROL ON THE LONGEST HOUSE LINE AND WESTERLY SHED LINE. THE CONTRACTOR WILL BE RESPONSIBLE TO FIELD VERIFY ALL STAKES FOR LOCATION AND DIMENSION PRIOR TO CONSTRUCTION. THIS OFFICE SHOULD BE NOTIFIED IMMEDIATELY IF ANY DISCREPANCIES ARISE.

N89°49'12"E  
1308.07'  
CENTER OF SECTION 34-4-18      NORTH LINE OF THE SOUTHEAST 1/4 OF SECTION 34-4-18

BEARINGS HEREON RELATE TO THE NORTH LINE OF THE SOUTHEAST 1/4 OF SECTION 34-4-18, ASSUMED BEARING NORTH 89°49'12" EAST.

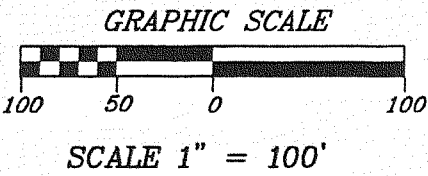

**CURVE DATA**  
Δ = 47°37'26"  
R = 202.45'  
CH = 163.47'  
N66°00'29"E

EMERGENCY VEHICLE TURNAROUND

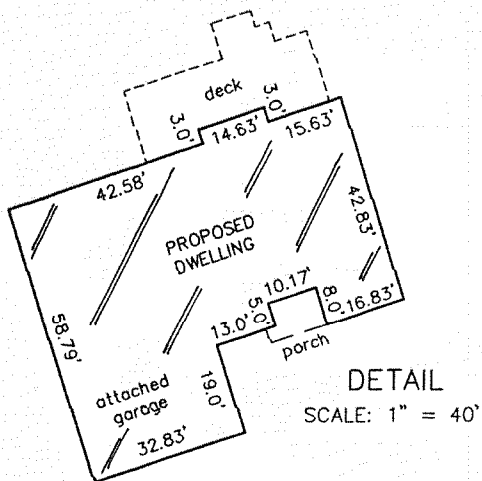

**LEGEND**

- PREVIOUSLY FOUND IRON ROD
- FOUND IRON PIPE
- ⊕ SET IRON ROD
- △ SOIL BORING

"I hereby certify that I have surveyed the above described property and that the above map is a correct representation thereof and shows the size and location of the property, its exterior boundaries, the location of all visible structures and dimensions of all principal buildings thereon, boundary fences, apparent easements, roadways and encroachments, if any."

"This survey is made for the use of the present owners of the property, and those who purchase, mortgage, or guarantee the title thereto within one year from date hereof."

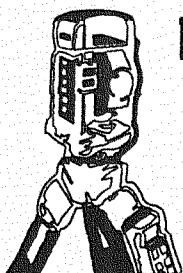

**B.W. SURVEYING, INC.**

LAND SURVEYS  
MAPPING AND PLANNING  
412 N. PINE STREET  
BURLINGTON, WI 53105  
(262)-767-0225

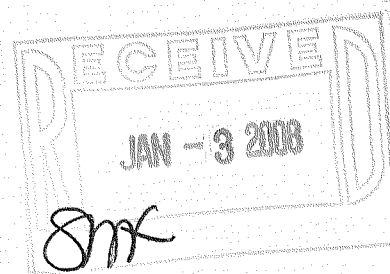
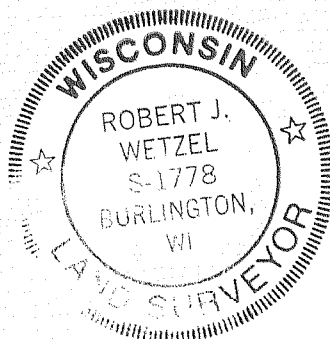

*Robert J. Wetzel*  
ROBERT J. WETZEL      S-1778

THIS IS NOT AN ORIGINAL PRINT UNLESS THIS SEAL IS RED.

AUGUST 20, 2007  
DATE

7657  
JOB NUMBER

PA 3445-1

418-2070