

Plat of Survey

Survey For: WOLTER BROS. BUILDERS
Location: HARMONY LANE

PATTERSON

Description: LOT 6 MIRAMAR ADDITION NO. 2, being a subdivision of the N.E.1/4 of Section 10 and the N.W. 1/4 of Section 11, Town 4 North, Range 18 East, in the Town of East Troy, Walworth County, Wisconsin.

N. 89°34'00"W.

155.00

3/4" I.P.F.D.

1" I.P.F.D.

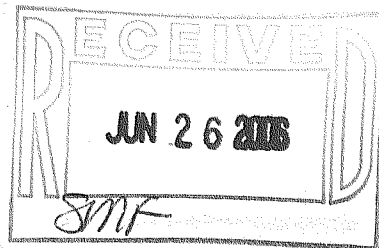

461.53

S. 00°10'00"W.

460.81

N. 00°10'00"E.

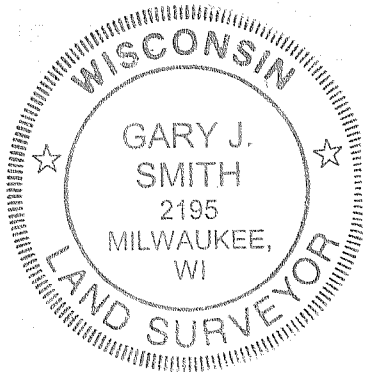

W858
EXIST. FR.
217Y
DWEL.

EXIST.
217Y
DWEL.

BENCHMARK
TRIPLE NAIL
IN E. SIDE OF TREE
EL. 100.00
(PERSONAL TITLE)

PROP. DWEL.

PROP. DWEL.

PROP. DWEL.

PROP. DWEL.

PROP. DWEL.

PROP. DWEL.

PROP. DWEL.

PROP. DWEL.

PROP. DWEL.

PROP. DWEL.

PROP. DWEL.

PROP. DWEL.

PROP. DWEL.

PROP. DWEL.

PROP. DWEL.

PROP. DWEL.

PROP. DWEL.

PROP. DWEL.

PROP. DWEL.

PROP. DWEL.

PROP. DWEL.

PROP. DWEL.

PROP. DWEL.

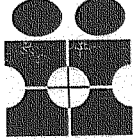

INTERLINE SURVEY
SERVICES, INC.

10521 W. FOREST HOME AVE. STE. 201
HALES CORNERS, WI 53130
PHONE 425-2060

SURVEY CERTIFICATE

State of Wisconsin ss
Milwaukee County

We, Interline Survey Services, Inc., certify that we have surveyed the above described property and the above map is a true representation thereof, and shows the size and location of the property, its exterior boundaries, the location and dimensions of all visible structures thereon, fences, apparent easements and roadways and visible encroachments, if any.

This survey is made for the exclusive use of the present owners of the Property, and also those who purchase, mortgage, or guarantee the title thereto, within one (1) year from date hereof.

Gary J. Smith
Wisconsin Registered Land Surveyor

Date: 12/7/04
Job No.: 30254

NOTE:
PROPOSED DWELLING
IS STAKED EXACT!
00.0 - DENOTES PROPOSED
FIN. YARD GRADES.
00.0 - DENOTES EXIST. GRADES.
Scale: 1" = 60'

N135207

PMR2-6

418-1929