

I HEREBY CERTIFY THAT I HAVE SURVEYED THE ABOVE DESCRIBED PROPERTY AND THE ABOVE MAP IS A TRUE REPRESENTATION THEREOF AND SHOWS THE SIZE AND LOCATION OF THE PROPERTY, ITS EXTERIOR BOUNDARIES, THE LOCATION OF ALL VISIBLE STRUCTURE AND DIMENSIONS OF ALL PRINCIPLE BUILDINGS THEREON, BOUNDARY FENCES, APPARENT EASEMENTS, ROADWAYS AND VISIBLE ENCROACHMENTS, IF ANY.

THIS SURVEY IS MADE FOR THE PRESENT OWNERS OF THE PROPERTY, AND ALSO THOSE WHO PURCHASE, MORTGAGE, OR GUARANTEE THE TITLE THEREOF WITHIN ONE (1) YEAR FROM THE DATE THEREOF.

DATED AT: NORTH CAPE, THIS 14TH DAY OF APRIL, 2003.

AMERICAN SURVEYING COMPANY, INC.  
PETE L. BAILEY, RLS NO. 1398  
RECEIVED this 17TH day of JULY, 2003.

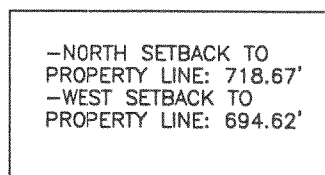
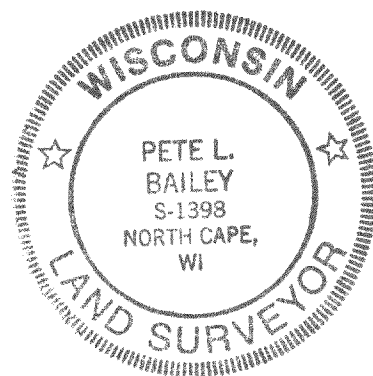

## PROPOSED DWELLING DETAIL

DRAWN BY:	PLB	REVISIONS:	DATE
CHECKED BY:	PLB	05/05/03:	MOVED DWELLING
PLOT SCALE:	1 = 100		
DATE:	04/13/2003		
JOB NO.:	03.026		
DWG. FILE:	JN203079B	CLIENT NO.	00010



AMERICAN  
SURVEYING  
COMPANY, INC.

2207 C.T.H. "K" FRANKSVILLE, WISCONSIN 53126  
TEL. (262) 835-4774 FAX: (262) 835-2379

## TOWN OF EAST TROY

PROJECT:

# PROJECT: **PLAT OF SURVEY/STAKE OUT SURVEY**

PREPARED FOR: BADGER HOME BUILDERS, INC.  
OWNER: JAMES TREFFERT

CLIENT NO. 00010

**Sheet**  
**1**  
**of**  
**1**

