

PROPOSED DWELLING DETAIL

STATE OF WISCONSIN
 COUNTY OF RACINE

I HEREBY CERTIFY THAT I HAVE SURVEYED THE ABOVE DESCRIBED PROPERTY AND THE ABOVE MAP IS A TRUE REPRESENTATION THEREOF AND SHOWS THE SIZE AND LOCATION OF THE PROPERTY, ITS EXTERIOR BOUNDARIES, THE LOCATION OF ALL VISIBLE STRUCTURES AND DIMENSIONS OF ALL PRINCIPAL BUILDINGS THEREON, BOUNDARY FENCES, APPARENT EASEMENTS, RIGHTS AND VISIBLE ENCROACHMENTS, IF ANY.

THIS SURVEY IS MADE FOR THE PRESENT OWNERS OF THE PROPERTY, AND ALSO THOSE WHO PURCHASE, MORTGAGE, OR GUARANTEE THE TITLE THEREOF WITHIN ONE (1) YEAR FROM THE DATE THEREOF.

DATED AT NORTH CAPE, THIS 14TH DAY OF APRIL, 2003.

Pete L. Bailey
 AMERICAN SURVEYING COMPANY, INC.
 PETE L. BAILEY, RLS NO. 1398
 RECERIFIED this _____ day of _____, 2003.

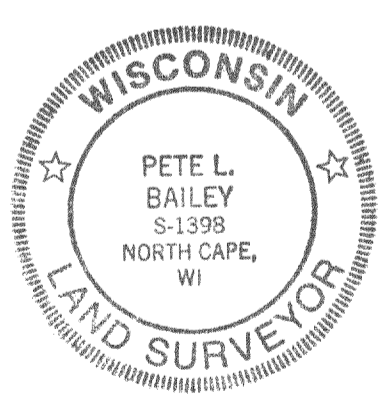

NOTE: SUGGESTED YARD GRADE MUST BE APPROVED BY THE OWNER AND MUNICIPALITY.

AMERICAN SURVEYING COMPANY, INC.		12207 C.T.H. "K" FRANKSVILLE, WISCONSIN 53126 TEL. (262) 835-4774 FAX: (262) 835-2379	
DRAWN BY:	PLB	REVISIONS:	DATE
CHECKED BY:	PLB	05/05/03:	MOVED DWELLING
PLOT SCALE: 1" = 100'		DATE:	04/13/2003
JOB NO.:	03-026	CLIENT NO.:	00010
DWG. FILE:	JN203079B		

TOWN OF EAST TROY

PROJECT:
PLAT OF SURVEY/STAKE OUT SURVEY

PREPARED FOR: BADGER HOME BUILDERS, INC.
 OWNER: JAMES TREFFERT

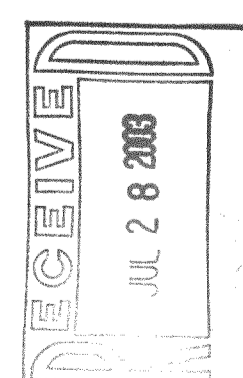

Sheet
1
 of
 1