

PLAT OF SURVEY
-OF-

LOT 1 OF CERTIFIED SURVEY MAP NO. 2076, AS RECORDED IN VOLUME 10 OF CERTIFIED SURVEY MAPS ON PAGE 43, IN THE OFFICE OF THE REGISTER OF DEEDS FOR WALWORTH COUNTY, WISCONSIN, AND BEING PART OF THE SOUTHEAST 1/4 OF THE NORTHWEST 1/4 AND THE NORTHEAST 1/4 OF THE NORTHWEST 1/4 OF SECTION 35, TOWNSHIP 4 NORTH, RANGE 18 EAST OF THE FOURTH PRINCIPAL MERIDIAN, IN THE TOWN OF EAST TROY, WALWORTH COUNTY, WISCONSIN.

SURVEY FOR: DAN & LAURA HEIDELMEIER
PROPOSED ADDRESS: _____ HONEY CREEK ROAD

PROPOSED DWELLING WAS STAKED ON ACTUAL CORNERS WITH 5 FOOT CONTROL ON THE LONGEST HOUSE LINE. THE CONTRACTOR WILL BE RESPONSIBLE TO FIELD VERIFY ALL STAKES FOR LOCATION AND DIMENSION PRIOR TO CONSTRUCTION. IF ANY DISCREPANCIES OCCUR, NOTIFY THIS OFFICE AT ONCE.

LEGAL DESCRIPTION
-OF-

(PROPOSED ADDITIONAL EASEMENT FOR INGRESS AND EGRESS)

BEING PART OF THE NORTHEAST 1/4 AND PART OF THE SOUTHEAST 1/4 OF THE NORTHWEST 1/4 OF SECTION 35, TOWNSHIP 4 NORTH, RANGE 18 EAST OF THE 4TH PRINCIPAL MERIDIAN IN THE TOWN OF EAST TROY, WALWORTH COUNTY, WISCONSIN AND BEING MORE PARTICULARLY DESCRIBED AS FOLLOWS: COMMENCE AT THE SOUTHEAST CORNER OF LOT 1 OF CERTIFIED SURVEY MAP NO. 2076; THENCE NORTH 48°26'34" WEST ALONG SOUTH LINE OF SAID LOT 1, 66.35 FEET TO THE WEST LINE OF AN EXISTING EASEMENT FOR INGRESS AND EGRESS; THENCE SOUTH 00°27'47" WEST ALONG SAID WEST LINE, 376.45 FEET TO THE PLACE OF BEGINNING OF THE FOLLOWING DESCRIBED EASEMENT FOR INGRESS AND EGRESS; THENCE CONTINUE SOUTH 00°27'47" WEST ALONG SAID WEST LINE, 134.77 FEET TO THE NORTH LINE OF HONEY CREEK ROAD; THENCE NORTH 48°26'34" WEST ALONG SAID NORTH LINE, 61.58 FEET; THENCE NORTH 26°39'57" EAST, 105.10 FEET TO THE PLACE OF BEGINNING.

DETAIL

SCALE: 1" = 30'

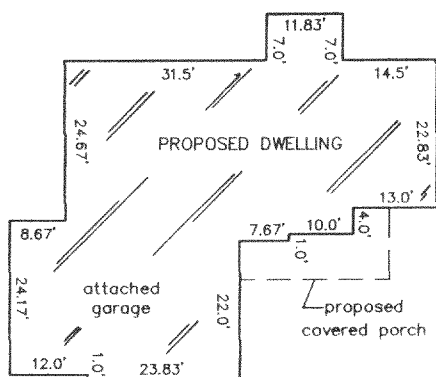

SCALE: 1" = 100'

LEGEND

- FOUND IRON PIPE
- 100.0 EXISTING ELEVATION

"I hereby certify that I have surveyed the above described property and that the above map is a correct representation thereof and shows the size and location of the property, its exterior boundaries, the location of all visible structures and dimensions of all principal buildings thereon, boundary fences, apparent easements, roadways and encroachments, if any."

"This survey is made for the use of the present owners of the property, and those who purchase, mortgage, or guarantee the title thereto within one year from date hereof."

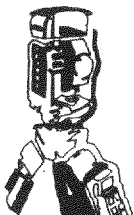

B.W. SURVEYING, INC.

412 N. PINE STREET
BURLINGTON, WI 53105
(262)-767-0225

APR - 3 2003

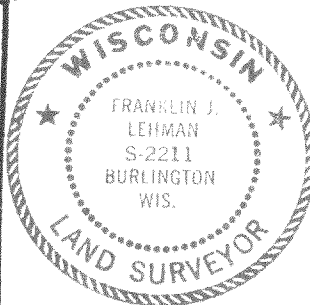

THIS IS NOT AN ORIGINAL PRINT
UNLESS THIS SEAL IS RED.

Franklin J. Lehman
FRANKLIN J. LEHMAN

S-2211

MARCH 27, 2003
DATE

5762
JOB NUMBER

PA2076-1

418-1638