

PLAT OF SURVEY -OF-

LOT 2 OF CERTIFIED SURVEY MAP NO. 2271, RECORDED IN VOLUME 11, PAGE 89, DOCUMENT NO. 252089, LOCATED IN PART OF THE SOUTHEAST 1/4 OF THE SOUTHEAST 1/4 OF SECTION 23, TOWN 4 NORTH, RANGE 18 EAST, TOWN OF EAST TROY, WALWORTH COUNTY, WISCONSIN.

SURVEY FOR: HACKBARTH BUILDERS

LOT 1
CERTIFIED SURVEY MAP NO. 2271

LOT 2
238,866 sq. ft.
5.48 acres

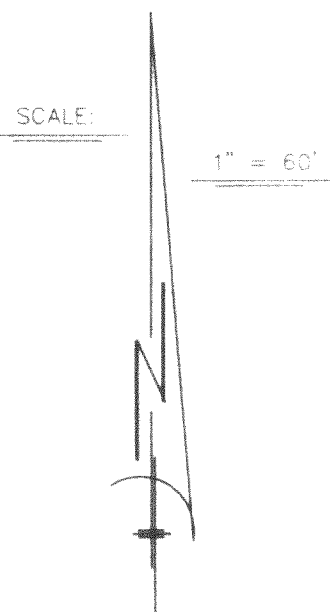
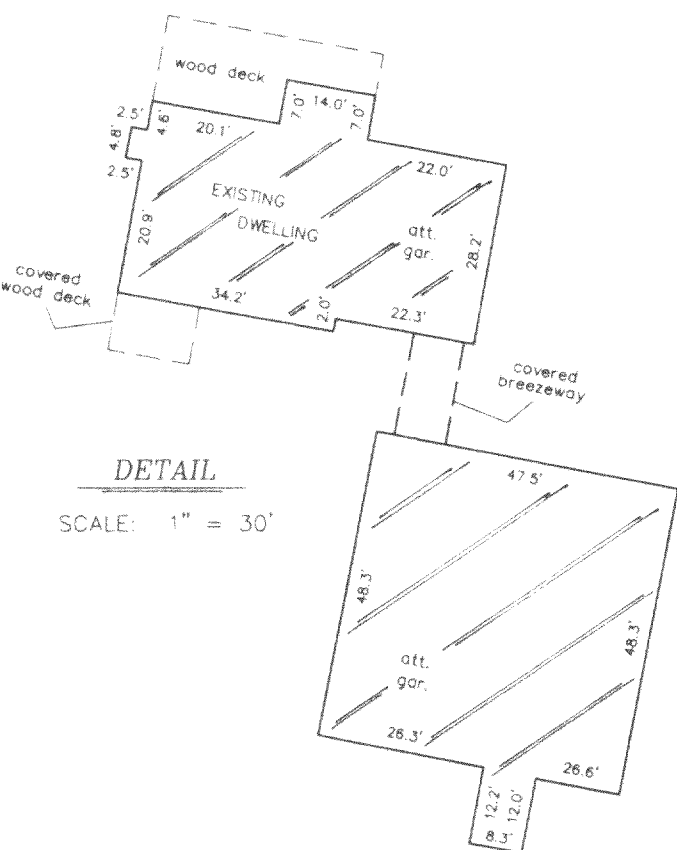

LEGEND

- FOUND WALWORTH COUNTY STANDARD MONUMENT
- FOUND IRON PIPE
- SET IRON PIPE

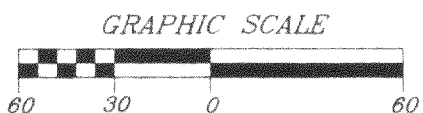

66' WIDE EASEMENT FOR INGRESS AND EGRESS TO S.T.H. "20"

66' WIDE EASEMENT FOR INGRESS AND EGRESS

LOT 3
CERTIFIED SURVEY MAP NO. 2271

SOUTH LINE OF SECTION 23 - 4 - 18 AS SHOWN ON PREVIOUS SURVEYS

SOUTHEAST CORNER
SECTION 23 - 4 - 18

"I hereby certify that I have surveyed the above described property and that the above map is a correct representation thereof and shows the size and location of the property, its exterior boundaries, the location of all visible structures and dimensions of all principal buildings thereon, boundary fences, apparent easements, roadways and encroachments, if any."

"This survey is made for the use of the present owners of the property, and those who purchase, mortgage, or guarantee the title thereto within one year from date hereof."

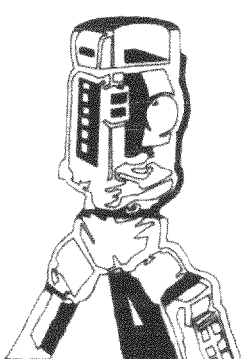

B.W. SURVEYING, INC.

412 N. PINE STREET
BURLINGTON, WI 53105
(262)-767-0225

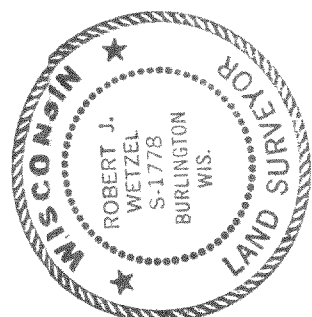

Robert J. Wetzel
ROBERT J. WETZEL S-1778

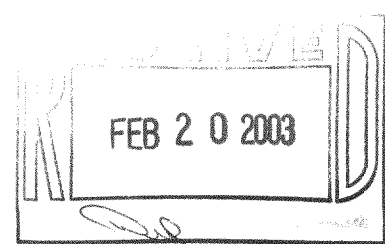

NOTE: BEARINGS HEREON RELATE TO THE EAST LINE OF CERTIFIED SURVEY MAP NO. 1698, ASSUMED BEARING N 00°10'28" W.

DRAWN BY:	bjw	DATE:	JANUARY 17, 2003
CHECKED BY:	jts	DRAWING NO.:	5721d1
JOB NO.:	5721A	SHEET	1 OF 1