

PLAT OF SURVEY

LOT 4 OF CERTIFIED SURVEY MAP NO.
2261 AS RECORDED IN VOL. 11 OF
CERTIFIED SURVEY MAPS AS PAGES 65
AND 66 AS DOCUMENT NO. 250969, BEING
LOCATED IN THE NORTHWEST 1/4 OF THE
NORTHWEST 1/4 OF SECTION 3, TOWN 4
NORTH, RANGE 18 EAST, TOWN OF EAST
TROY, WALWORTH COUNTY, WISCONSIN.

ORDERED BY: JIM STEMPER
10305 W. BROOKSIDE DR.
HALES CORNERS, WI. 53130

EXISTING RESIDENCE DETAIL

SCALE 1" = 10 feet

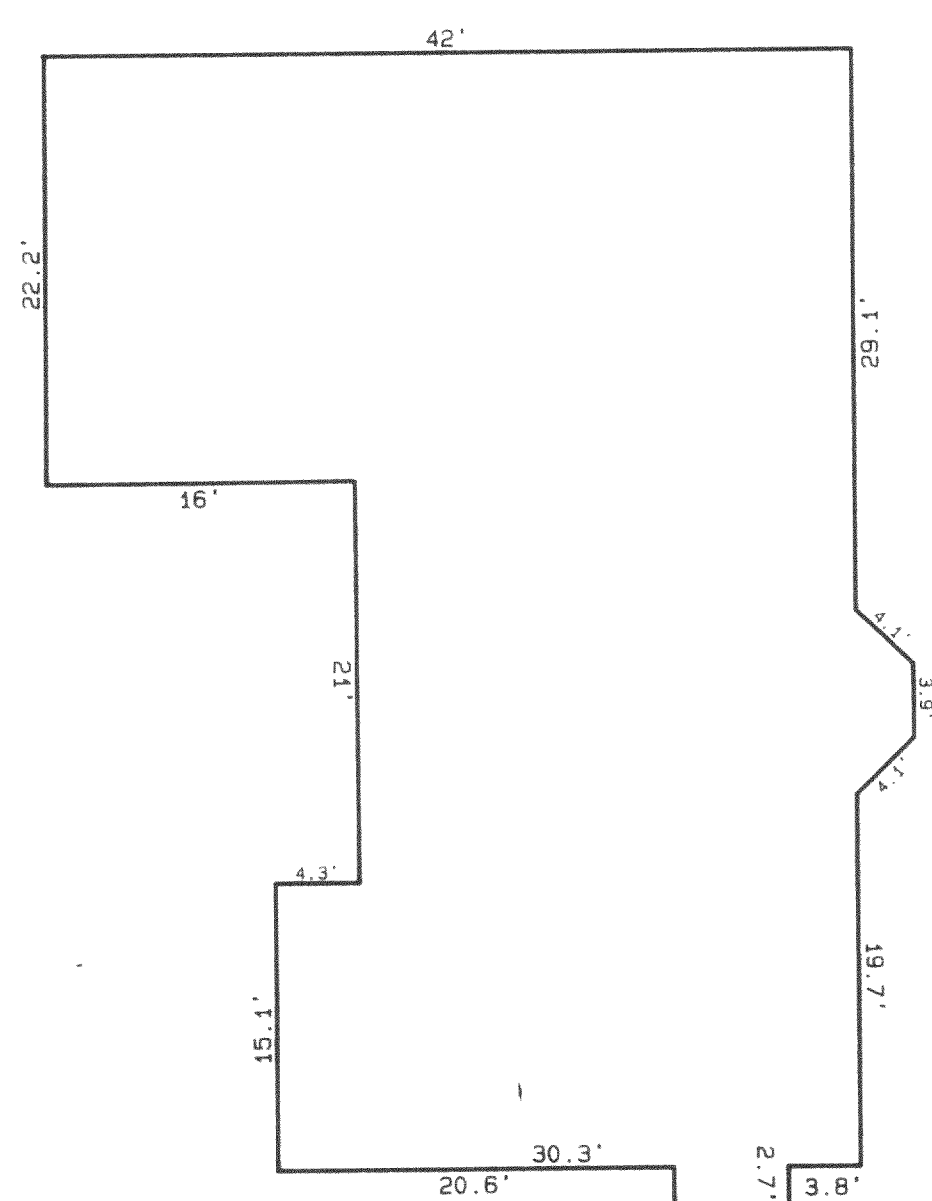

NORTHWEST CORNER
SEC. 3-4-18

N 88°36'41"E 40.00'

REFERENCE BENCHMARK: TOP OF
IRON PIPE EL. = 100' ASSUMED

COMMON DRIVEWAY EASEMENT
FOR LOTS 3 AND 4

LOT 3

N 89°23'33" E 684.05'

LOT 4
216, 236 S.F.

EXISTING RESIDENCE

SOIL TEST AREA

△ EL. = 100.8'

△ EL. = 99.0'

$$\Delta \text{ EL.} = 96.8'$$

▲ EL. 96.4'

6 EL. = 97.8'









S 89° 17' 44" W 590.71'

C. T. H. "J"
100' WIDE

NOTE:

WOOD STAKES OR 60 PENNY SPIKES HAVE BEEN PLACED AT BUILDING CORNERS. BUILDER IS TO VERIFY DIMENSIONS WHICH HAVE BEEN ROUNDED TO THE NEAREST TENTH OF A FOOT TO INSURE PROPER PLAN INTERPRETATION AND CONTACT THIS OFFICE IMMEDIATELY IF ANY DISCREPANCY EXISTS.

Legend

-  FOUND IRON PIPE
 FOUND IRON ROD
 FOUND BRASS CAPPED MONUMENT
 FOUND CONCRETE MONUMENT
 CHISEL CUT IN CONCRETE
 SET IRON ROD, 24" LONG, WEIGHING 1.5 LBS./LINEAL FT., 3/4" DIA.
 SET IRON ROD, 30" LONG, WEIGHING 4.5 LBS./LINEAL FT., 1-11/16" DIA.
 (xx) RECORDED AS DIMENSION
 EXISTING FENCE

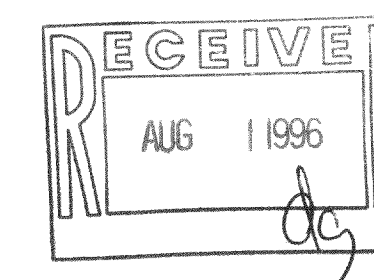

SCALE: 1" = 50 FEET

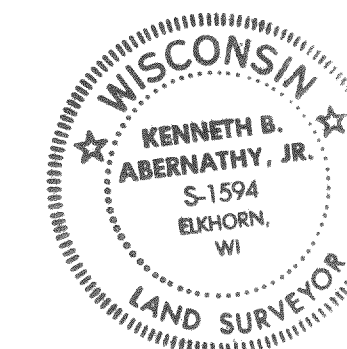

"I hereby certify that the above described property has been surveyed by me or under my direction and that the above map is a true representation thereof and shows the size and location of the property, its exterior boundaries, the location of all visible structures and dimensions of all principal buildings thereon, boundary fences, apparent easements, roadways and visible encroachments, if any.

"This survey is made for the use of the present owners of the property and also those who purchase, mortgage, or guarantee the title thereto within one year from date hereof."

KENNETH B. ABERNATHY, JR.
WISCONSIN REGISTERED LAND SURVEYOR

Date: 6-6-96 Job No. S-1594
96.218

AS BUILT REVISION DATED 6/6/96

PA-2261-4
418-1089

LOT 4 OF CERTIFIED SURVEY MAP NO. 2261 AS RECORDED IN VOL. 11 OF CERTIFIED SURVEY MAPS AS PAGES 65 AND 66 AS DOCUMENT NO. 250969, BEING LOCATED IN THE NORTHWEST 1/4 OF THE NORTHWEST 1/4 OF SECTION 3, TOWN 4 NORTH, RANGE 18 EAST, TOWN OF EAST TROY, WALWORTH COUNTY, WISCONSIN.

HALES CORNERS. WI. 53130



COMMON DRIVEWAY EASEMENT
FOR LOTS 3 AND 4

LOT 3

N 89°23'33" E 684.05'

LOT 4
216, 236 S.F.

PROPOSED RESIDENCE

SOIL TEST AREA

EL. = 100.8

△ EL. = 99.0'

EL. = 96.8'

▲ EL. 96.4'

Δ EL. = 97.8

S 89°17'44" W 590.71

C. T. H. "J"
100' WIDE

NOTE.

WOOD STAKES OR 60 PENNY SPIKES HAVE BEEN PLACED AT BUILDING CORNERS. BUILDER IS TO VERIFY DIMENSIONS WHICH HAVE BEEN ROUNDED TO THE NEAREST TENTH OF A FOOT TO INSURE PROPER PLAN INTERPRETATION AND CONTACT THIS OFFICE IMMEDIATELY IF ANY DISCREPANCY EXISTS.



BEARINGS ARE BASED ON GRID
NORTH OF THE WISCONSIN
STATE PLANE COORDINATE
SYSTEM, SOUTH ZONE.



- ✂ FOUND IRON PIPE
 - ✂ FOUND IRON ROD
 - ☐ FOUND BRASS CAPPED MONUMENT
 - FOUND CONCRETE MONUMENT
 - + CHISEL CUT IN CONCRETE
 - SET IRON ROD, 24" LONG, WEIGHING 1.5 LBS./LINEAL FT., 3/4" DIA.
 - SET IRON ROD, 30" LONG, WEIGHING 4.5 LBS./LINEAL FT., 1-1/16" DIA.
- (XX) RECORDED AS DIMENSION
EXISTING FENCE

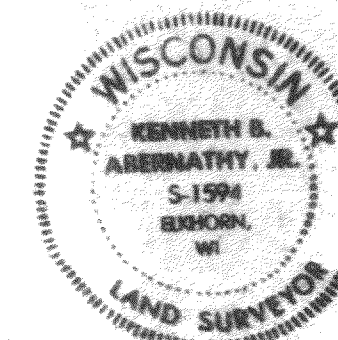

SCALE: 1" = 50 FEET

"I hereby certify that the above described property has been surveyed by me or under my direction and that the above map is a true representation thereof and shows the size and location of the property, its exterior boundaries, the location of all visible structures and dimensions of all principal buildings thereon, boundary fences, apparent easements, roadways and visible encroachments, if any."

Kenneth B. Smith

KENNETH B. ABERNATHY, JR.

WISCONSIN REGISTERED LAND SURVEYOR
S-1580

Date: 3-15-96 Job No. 96.21

Date: _____ Job No. _____