

PLAT OF SURVEY

-OF-

LOTS 1,2,4,5, AND 6 OF McGRAWS PARK, ACCORDING TO THE RECORDED PLAT THEREOF, LOCATED IN THE NORTHEAST 1/4 OF SECTION 9, TOWNSHIP 4 NORTH, RANGE 18 EAST, TOWN OF EAST TROY, WALWORTH COUNTY, WISCONSIN. ALSO THE USE OF A RIGHT OF WAY TO AND FROM THE PUBLIC HIGHWAY TO THE LAKE, ACROSS THE FOLLOWING PIECE OR PARCEL OF LAND. BEGINNING AT AN IRON STAKE LOCATED AT THE WATER'S EDGE ON EAST SIDE OF STOREHOUSE OWNED BY FRANK GRAFF; THENCE NORTH TO THE PUBLIC HIGHWAY; THENCE SOUTHEASTERLY ALONG THE SOUTH SIDE OF A PUBLIC HIGHWAY, 75 FEET TO A POINT ; THENCE SOUTH TO THE SHORE OF LAKE BEULAH; THENCE WESTERLY ALONG THE SHORE OF LAKE BEULAH, TO THE PLACE OF BEGINNING.

SURVEY FOR: ROGER AND PATRICIA COOK

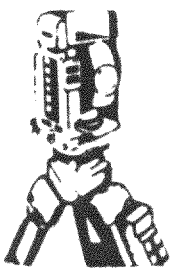

B.W. SURVEYING
 Land Surveys
 Mapping And Planning
 35117 Academy Road
 Burlington, Wisconsin 53105
 (414) 534-4109

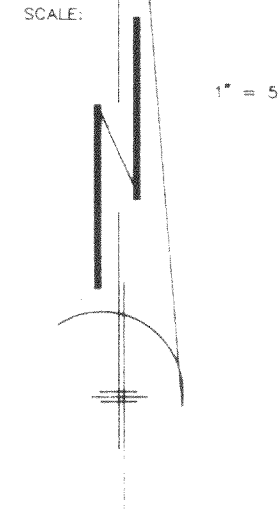

- o FOUND PK NAIL
- o FOUND IRON PIPE
- o FOUND RAILROAD SPIKE
- o SET IRON PIPE

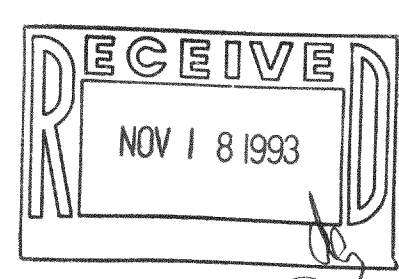
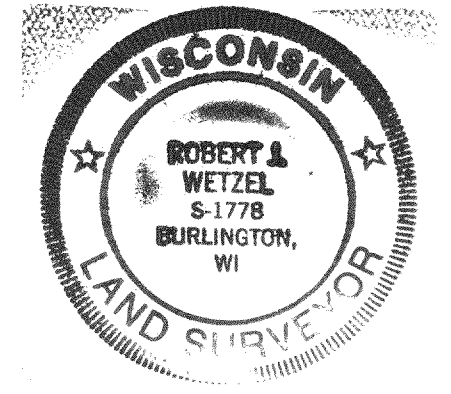

THIS IS NOT AN ORIGINAL PRINT UNLESS THIS SEAL IS RED
Robert J. Wetzel
 ROBERT J. WETZEL
 REGISTERED LAND SURVEYOR - 1778

6/18/93 DATE 1225 JOB NUMBER

"I hereby certify that I have surveyed the above described property and that the above map is a true representation thereof and shows the size and location of the property, its exterior boundaries, the location of all visible structures and dimensions of all principal buildings thereon, boundary fences, apparent easements, roadways and encroachments, if any."
 "This survey is made for the use of the present owners of the property, and those who purchase, mortgage, or guarantee the title thereto within one year from date hereof."

418-924

PMG-1
 PMG-2