

PLAT OF SURVEY
-OF-

LOT 3 AND OUTLOT 1 OF "OAK HILLS ESTATES", AS RECORDED IN CABINET C OF PLATS ON SLIDES 78 AND 79 AS DOCUMENT NO. 450785. SAID LAND BEING IN THE TOWN OF EAST TROY, COUNTY OF WALWORTH AND STATE OF WISCONSIN.

SURVEY FOR: ALAN QUICK OF ARCHITECTURAL HOMES
SURVEY ADDRESS: N8247 OAK HILLS DRIVE, EAST TROY, WI 53120

NOTE: REFER TO A CURRENT TITLE REPORT FOR EASEMENTS, RESTRICTIONS OR COVENANTS WHICH MAY AFFECT THIS PROPERTY.

CENTER OF
SECTION 23-4-18

S89°54'06"E 390.00'
140.33' 72.67' 177.00'

OUTLOT 1
meander line 317.97'
meander line 368.93'
N23°03'27"E
N23°39'34"E
CENTER OF SPRING CREEK IS PROPERTY LINE
(NOT LOCATED AS PART OF THIS SURVEY)
30.32' 66.96' 128.32' 131.44' 73.52' 840.2' 118.37' 860.8' 70.20' 911.93' 113.09' 179.71' 180.00' 157.15' 87.73' 889.97' 118.12' 831.7' 102.52' 50.3' 103' 849.8' 854.9' 75' 300' WIDTH

7.91 total acres

EXISTING TOP OF FOUNDATION
ELEVATION = 843.6'

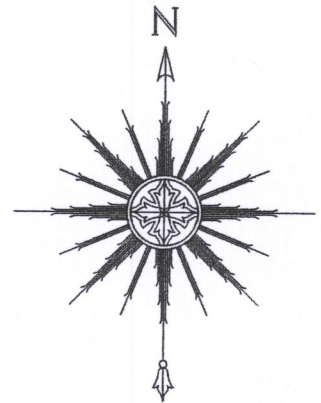

0 50' 100' 200'
SCALE: 1" = 100'

CURVE DATA

RADIUS = 503.00'
CENTRAL ANGLE = 20°30'12"
CHORD = 179.04'
CHORD BEARING = S54°04'07"W

DETAIL

SCALE: 1" = 30'

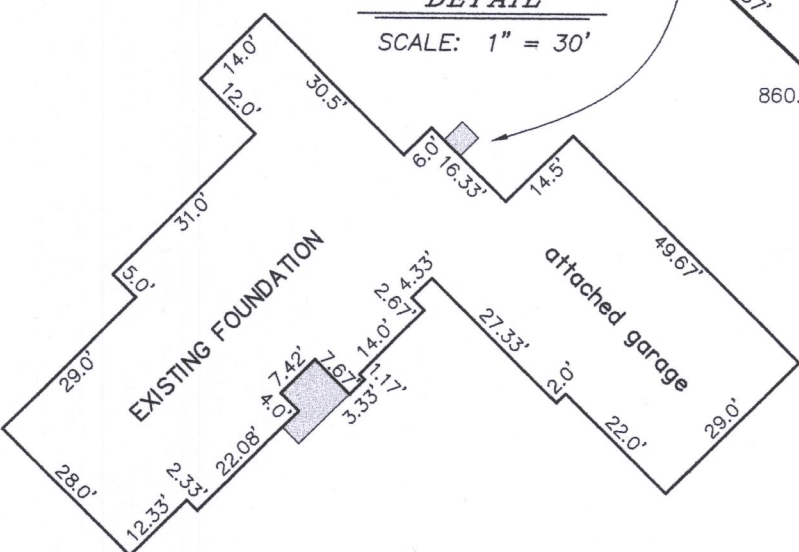

LEGEND

- ⊙ FOUND 2-3/8" O.D. IRON PIPE
- FOUND 1-5/16" O.D. IRON PIPE
- FOUND 3/4" O.D. IRON PIPE
- ✱ FOUND 3/4" IRON REBAR
- ⌘ FOUND LANDSCAPING NAIL

NOTE: MONUMENTATION HAS BEEN WAIVED FOR THE LOT CORNERS NOT INDICATED AS BEING FOUND OR SET BY WRITTEN AGREEMENT WITH THE ABOVE NAMED CLIENT IN ACCORDANCE WITH A-E 7.01 (2) OF THE WISCONSIN ADMINISTRATIVE CODE.

"I HEREBY CERTIFY THAT I HAVE SURVEYED THE ABOVE DESCRIBED PROPERTY AND THAT THE ABOVE MAP IS A CORRECT REPRESENTATION THEREOF AND SHOWS THE SIZE AND LOCATION OF THE PROPERTY, ITS EXTERIOR BOUNDARIES, THE LOCATION OF ALL VISIBLE STRUCTURES AND DIMENSIONS OF ALL PRINCIPAL BUILDINGS THEREON, BOUNDARY FENCES, APPARENT EASEMENTS, ROADWAYS AND ENCROACHMENTS, IF ANY."

"THIS SURVEY IS MADE FOR THE USE OF THE PRESENT OWNERS OF THE PROPERTY, AND THOSE WHO PURCHASE, MORTGAGE, OR GUARANTEE THE TITLE THERETO WITHIN ONE YEAR FROM DATE HEREOF."

SATTER SURVEYING, LLC
LAND SURVEYS, MAPPING AND PLANNING
272 ORIGIN STREET
BURLINGTON, WI 53105
262-661-4239

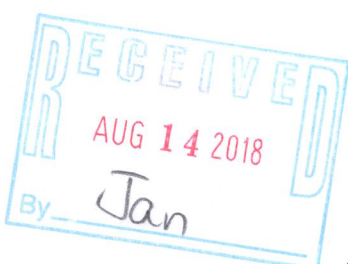

12" WIDE UTILITY EASEMENT
OAK HILLS DRIVE
S35°14'03"W 500.00'
S43°22'27"E 67.33'
N35°14'03"E
S.T.H. "20"

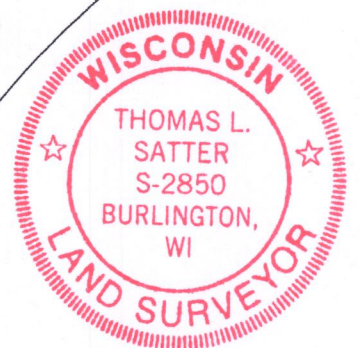

THIS IS NOT AN ORIGINAL PRINT
UNLESS THIS SEAL IS RED.

Thomas L. Satter
THOMAS L. SATTER S-2850

REVISED: 8/24/18
MAY 22, 2018
DATE

101506d2
JOB NUMBER

POHE-3

418-2625