

MONUMENTATION BY WRITTEN AGREEMENT  
WITH THE ABOVE NAMED CLIENT HAS BEEN  
WAIVED IN ACCORDANCE WITH A-E 7.01(2)  
OF THE WISCONSIN ADMINISTRATIVE CODE.



LEGEND

FOUND P.K. NAIL

BOOTH LAKE HEIGHTS ROAD

56.96'  
N02°47'07"E 57.00'  
48.87'

N87°56'28"E

93.3'

S86°14'11"W

236.34'

242.79'

BOOTH LAKE

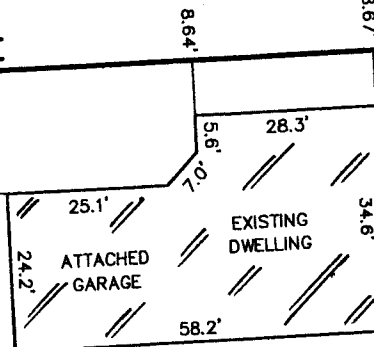

PLAT OF SURVEY  
-OF-

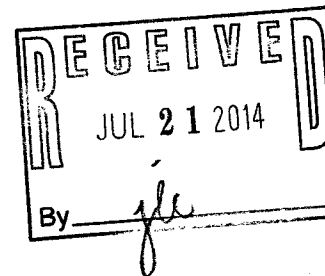

"This survey is made for the use of the present owners of the  
property, and those who purchase, mortgage, or guarantee the  
title thereto within one year from date hereof."

LOT 37 OF BOOTH LAKE HEIGHTS, A SUBDIVISION OF PART  
OF SECTIONS 13 AND 24, IN TOWNSHIP 3 NORTH, RANGE 17  
EAST, IN THE TOWNSHIP OF EAST TROY, WALWORTH COUNTY,  
WISCONSIN.

SURVEY FOR: CHRIS LINDBERG  
SURVEY LOCATION: N8512 BOOTH LAKE HEIGHTS ROAD

NOTE: THIS SURVEY IS BEING UPDATED TO LOCATE THE  
NORTH LINE OF THE EXISTING DWELLING AS SHOWN. NO  
OTHER IMPROVEMENTS WERE LOCATED.

THIS IS NOT AN ORIGINAL PRINT  
UNLESS THIS SEAL IS RED.

*Robert J. Wetzel*  
ROBERT J. WETZEL S-1778

MAY 28, 2014  
DATE

8769  
JOB NUMBER



B.W. SURVEYING, INC.

412 N. PINE STREET  
BURLINGTON, WI 53105  
(262)-767-0225

LBL-31

417-974