

LAND-MARK SURVEYING
Mark L. Miritz
Wisconsin Registered Land Surveyor S-2582

N9330 Knuteson Drive
Whitewater, WI 53190
Phone: (262) 495-3284
FAX : (262) 495-8421
LAND-MARKSURVEYING.COM

PLAT OF SURVEY

BRIGGS STREET

(60' WIDE)

2ND STREET

1ST STREET

OWNERS: ANDREW CURLER
JAMIE CURLER
W3321 2ND STREET
EAST TROY, WI 53120

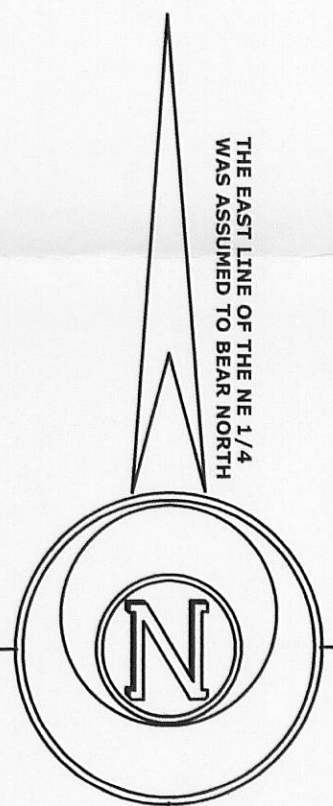

THE EAST LINE OF THE NE 1/4
WAS ASSUMED TO BEAR NORTH

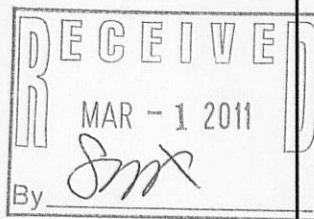

LEGEND

- FOUND IRON PIPE
- FOUND IRON ROD
- FOUND COUNTY MONUMENT
- SET IRON PIPE, 18" LONG, WEIGHING 1.5 LBS./LINEAL FT., 1 1/4" DIA.
- RECORDED AS DIMENSION

SCALE: 1 INCH = 30 FEET

"I hereby certify that the above described property has been surveyed by me or under my direction and that the above map is a true representation thereof and shows the size and location of the property, its exterior boundaries, the location of all visible structures and dimensions of all principal buildings thereon, boundary fences, apparent easements, roadways and visible encroachments, if any."

Mark L. Miritz
MARK L. MIRITZ
WISCONSIN REGISTERED
LAND SURVEYOR S-2582

DATE: NOV. 13, 2010 JOB NO. 09.702

LEGAL DESCRIPTION FROM DOC. NO. 766872 WALWORTH CO. RECORDS

The North 1/2 of the following described parcel: A strip or parcel of land approximately 75 feet in width adjoining Block 4 of the Map of Troy Center in Section 15, T4N, R17E, on the East side thereof and more particularly described as follows, to-wit: Beginning at a point on the centerline of First Street in said village of Troy Center located 125 feet West of the centerline of the main track of the railroad formerly operated by the Chicago, Milwaukee, St. Paul and Pacific Railroad Company, running thence Northerly parallel with said centerline of said main track to the centerline of Second Street in said Village, thence East along the centerline of Second Street 75 feet to a point 50 feet West of the centerline of said main track, thence Southerly parallel with said centerline 330 feet, more or less to the centerline of First Street in said Village, thence West in the centerline of said First Street to the point of beginning. Said land being located in the Northeast 1/4 of Section 15, T4N, R17E, Town of Troy, County of Walworth, State of Wisconsin, and being part of that portion of said Map of Troy Center depicted as a railroad right of way.

ALSO, the East one foot of Lots 1 and 2 and the East one foot of the North 26.4 feet of Lot 3, Block 4, of the Map of Troy Center, Town of Troy, County of Walworth, State of Wisconsin.

AND ALSO The East 4 feet of the South 26.4 feet of Lot 3, Block 4 of the Map of Troy Center in Section 15, Town 4 North, Range 17 East, Walworth County, Wisconsin.

Also, the South 1/2 of the following described parcel: A strip or parcel of land approximately 75 feet in width adjoining Block 4 of the Map of Troy Center in Section 15, Town 4 North, Range 17 East, on the East side thereof and more particularly described as follows, to-wit: Beginning, at a point on the center line of First Street in said village of Troy Center located 125 feet West of the center line of the main track of the railroad formerly operated by the Chicago, Milwaukee, St. Paul and Pacific Railroad Co., running thence Northerly parallel with said center line of said main track to the center line of Second Street in said Village, thence East along the center line of Second Street 75 feet to a point 50 feet West of the center line of said main track, thence Southerly parallel with said center line 330 feet, more or less, to the center line of First Street in Village, thence West in the center line of said First Street to the place of beginning. Said land being located in the NE 1/4 of Section 15, T4N, R17E, Town of Troy, County of Walworth, State of Wisconsin, and being part of that portion of said Map of Troy Center depicted as a railroad right of way.

LEGAL DESCRIPTION FROM VOL. 543, PAGE 265, DOC. NO. 222295 RECORDS

The West 10 feet of the following described premises:
A parcel of land located in the Southeast 1/4 of the Northeast 1/4 of Section 15, Town 4 North, Range 17 East, Town of Troy, Walworth County, Wisconsin, described as follows: Commence at the East 1/4 corner of said Section 15; thence North, along the East line of said Section 15, 165.69 feet to the centerline of 1st Street; thence S 89° 59' 21" W along said centerline, 185.78 feet; thence N 0° 05' 09" E 33.00 feet to the North line of said 1st Street and the point of beginning; thence S 89° 59' 21" W along said North line, 100.48 feet; thence N 0° 08' 39" E 265.33 feet to the South line of 2nd Street; thence S 89° 59' 48" E along said South line, 100.21 feet; thence S 0° 05' 09" W 265.30 feet to the point of beginning, and being a part of that portion of said Map of Troy Center depicted as a railroad right of way.

FOUND IRON ROD IS
N 13°05'20" E 0.49'
FROM CORNER

FOUND IRON PIPE IS
N 00°00'52" E 0.24'
AGAINST TREE ROOT

FOUND IRON PIPE IS
S 00°12'12" E 132.31'
(132')

FOUND IRON PIPE IS
S 00°16'35" E 26.60'
(26.4')

FOUND IRON PIPE IS
S 00°12'12" E 132.31'
(132')

FOUND IRON PIPE IS
S 00°16'35" E 26.60'
(26.4')

FOUND IRON PIPE IS
S 00°12'12" E 132.31'
(132')

FOUND IRON PIPE IS
S 00°16'35" E 26.60'
(26.4')

FOUND IRON PIPE IS
S 00°12'12" E 132.31'
(132')

FOUND IRON PIPE IS
S 00°16'35" E 26.60'
(26.4')

FOUND IRON PIPE IS
S 00°12'12" E 132.31'
(132')

FOUND IRON PIPE IS
S 00°16'35" E 26.60'
(26.4')

FOUND IRON PIPE IS
S 00°12'12" E 132.31'
(132')

FOUND IRON PIPE IS
S 00°16'35" E 26.60'
(26.4')

FOUND IRON PIPE IS
S 00°12'12" E 132.31'
(132')

FOUND IRON PIPE IS
S 00°16'35" E 26.60'
(26.4')

FOUND IRON PIPE IS
S 00°12'12" E 132.31'
(132')

FOUND IRON PIPE IS
S 00°16'35" E 26.60'
(26.4')

FOUND IRON PIPE IS
S 00°12'12" E 132.31'
(132')

FOUND IRON PIPE IS
S 00°16'35" E 26.60'
(26.4')

FOUND IRON PIPE IS
S 00°12'12" E 132.31'
(132')

FOUND IRON PIPE IS
S 00°16'35" E 26.60'
(26.4')

FOUND IRON PIPE IS
S 00°12'12" E 132.31'
(132')

FOUND IRON PIPE IS
S 00°16'35" E 26.60'
(26.4')

FOUND IRON PIPE IS
S 00°12'12" E 132.31'
(132')

FOUND IRON PIPE IS
S 00°16'35" E 26.60'
(26.4')