

# PLAT OF SURVEY

LOCATION: Otto Court, Troy, Wisconsin

**LEGAL DESCRIPTION:** Lot 29 in ANNTROYEEN ESTATES, unrecorded subdivision in Section 12 & 13 in Town 4 North, Range 17 East, in the Town of Troy, Walworth County, Wisconsin, and being described as follows: Commencing at the East 1/4 corner of Section 12, Town 4 North, Range 17 East, thence North 89° 38' 11" W, along the East 1/4 line of Section 12, 1265.83 feet to the point of beginning; thence S 0° 34' 20" W, 569.95 feet to point on the Northerly right-of-way line of Otto Court; thence Westerly along said Northerly right-of-way line, the arc of 395.04 feet, the radius of 2033.00 feet the central angle of 11° 08' 00" and the center of which is in a Southerly direction, the chord of which bears S 86° 16' 34" W, 394.42 feet; thence N 0° 34' 20" E, 598.07 feet to a point on the East 1/4 line of Section 12; thence S 89° 38' 11" e, along the East 1/4 line of Section 12, 393.31 feet to the point of beginning.

August 29, 1991

Survey No. 79519

S 89° 38' 11" E  
393.31

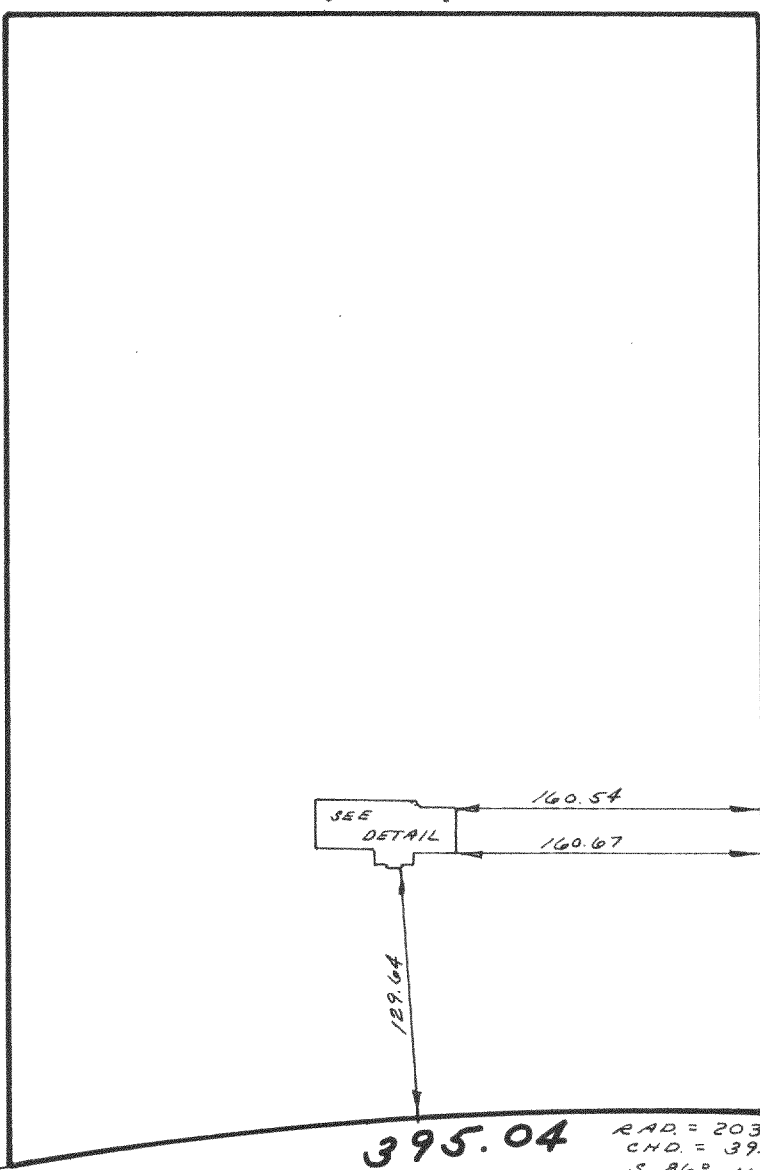
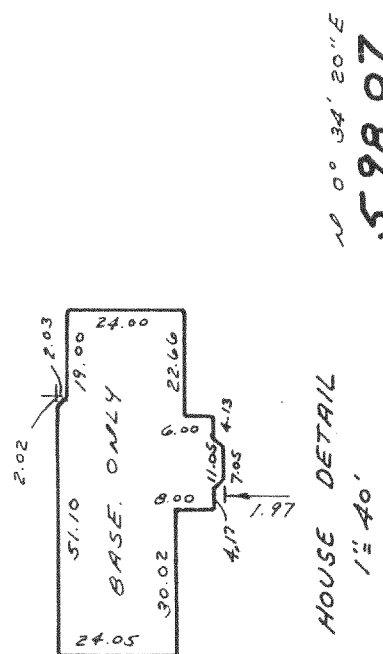
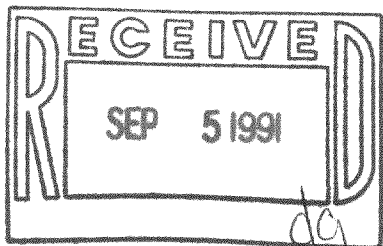

N 89° 38' 11" W  
1265.83  
EAST 1/4 COR.  
SECT. 12-4-17

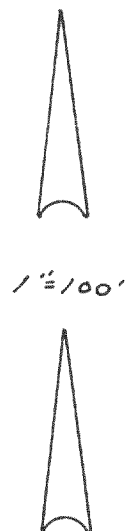

569.95  
S 0° 34' 20" W

SEE DETAIL  
160.54  
160.67

395.04  
RAD. = 2033.00  
CHD. = 394.42  
S 86° 16' 34" W

OTTO COURT

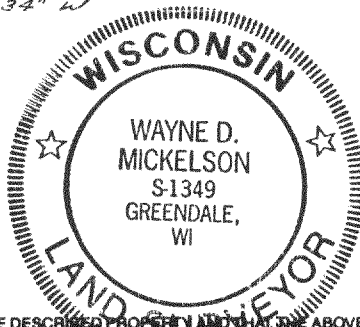

**METROPOLITAN SURVEY SERVICE, INC.**  
REGISTERED LAND SURVEYORS  
9415 W. FOREST HOME AVE., SUITE 107 HALES CORNERS, WI 53130  
529-5380

I HEREBY CERTIFY THAT I HAVE SURVEYED THE ABOVE DESCRIBED PROPERTY AND THAT THE ABOVE MAP IS A TRUE REPRESENTATION THEREOF AND SHOWS THE SIZE AND LOCATION OF THE PROPERTY, ITS EXTERIOR BOUNDARIES, THE LOCATION OF ALL VISIBLE STRUCTURES AND DIMENSIONS OF ALL PRINCIPAL BUILDINGS THEREON, BOUNDARY FENCES, APPARENT EASEMENTS AND ROADWAYS AND VISIBLE ENCROACHMENTS, IF ANY.

THIS SURVEY IS MADE FOR THE EXCLUSIVE USE OF THE PRESENT OWNERS OF THE PROPERTY, AND ALSO THOSE WHO PURCHASE, MORTGAGE, OR GUARANTEE THE TITLE THERETO WITHIN ONE (1) YEAR FROM DATE HEREOF.

SIGNED Wayne D. Mickelson  
Wayne D. Mickelson  
Registered Land Surveyor S-1349

417-279

LAN 00029