

ABERNATHY and ASSOCIATES**Kenneth B. Abernathy Jr.****Wisconsin Registered Land Surveyor S-1594**

Rt. 3, Box 273

Elkhorn, Wisconsin 53121

Phone: (414) 723-4260 (office)

(414) 723-4813 (residence)

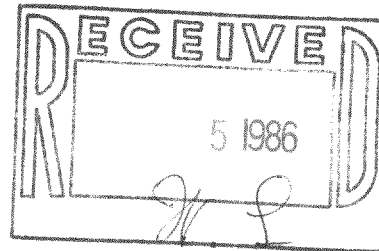
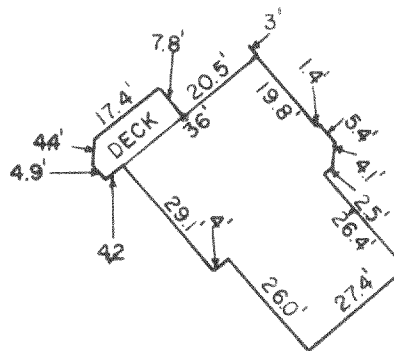
PLAT OF SURVEY**DETAIL:**TWO STORY BRICK DWLG. AND
ATTACHED GARAGE.

SCALE: 1"=40'

PROPERTY LOCATED AT
5315 COUNTY "HWY. A"**LEGAL DESCRIPTION:**LOT 1 CSM. # 885, VOL. 4 OF
CERTIFIED SURVEYS, PAGE 100.Located in the Northeast $\frac{1}{4}$ of the Southeast $\frac{1}{4}$ of Section 34, Town 4 North, Range 17
East, Town of Lafayette, Walworth County, Wisconsin.Ordered By: Mortgage Specialists, Inc.
N 88 W 15125 Main St.
Menominee Falls, WI. 53051

Buyer: Frederick R. Knack

Note: previous survey done by E.A. Blomquist dated Nov. 8, 1978

Legend

- FOUND IRON PIPE
- FOUND IRON ROD
- FOUND BRASS CAPPED MONUMENT
- ⊗ FOUND CONCRETE MONUMENT
- + CHISEL CUT IN CONCRETE
- SET IRON ROD, 24" LONG, WEIGHING
1.5 LBS./LINEAL FT., 3/4" DIA.
- SET IRON ROD, 30" LONG, WEIGHING
4.5 LBS./LINEAL FT., 1-11/16" DIA.
- (xx) RECORDED AS DIMENSION
- x-x- EXISTING FENCE
- OH. ELEC. OVERHEAD ELECTRIC



SCALE: 1"=100 FEET

"I hereby certify that I have surveyed the above described property and that the above map is a true representation thereof and shows the size and location of the property, its exterior boundaries, the location of all visible structures and dimensions of all principal buildings thereon, boundary fences, apparent easements, roadways and visible encroachments, if any."

"This survey is made for the use of the present owners of the property, and also those who purchase, mortgage, or guarantee the title thereto within one year from date hereof."

KENNETH B. ABERNATHY, JR.
WISCONSIN REGISTERED LAND SURVEYOR
S-1594

Date: 5/1/86 Job No. 501