

Plat of Survey

of

Lot 2 of Certified Survey Map No. 770,

recorded in Vol. 3 of Certified Survey Maps of Walworth County on Page 298 and located in the Northeast 1/4 of the Southeast 1/4 of Section 26, Town 4 North, Range 17 East, Town of Troy, Walworth County, Wisconsin.

Surveyed for: **Scott Pontel**
W2935 County Road ES
Elkhorn, Wisconsin. 53121

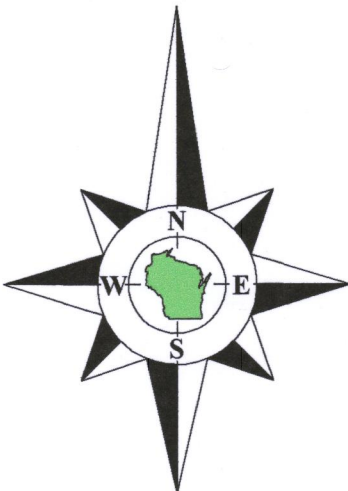

Bearings referenced to the East line of Certified Survey Map No. 1926, recorded as S22°45'20"E.

County Trunk Highway ES
(66' Wide)

Lot 2
Tax Parcel
LA 77000002
1.249 Acres
54,403 Sq.Ft.

Lot 1
C.S.M. 1301

Lot 1
C.S.M. 1730

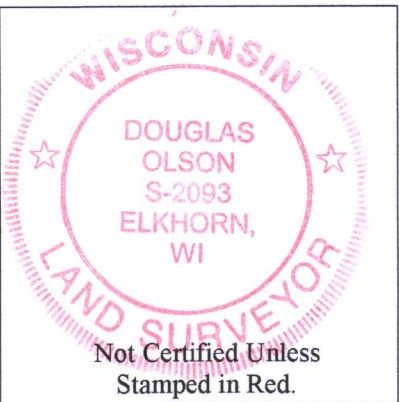

- Notes:**
- 1) This Plat of Survey is not certified unless signed and sealed in red ink.
 - 2) This survey is subject to Wisconsin lien laws. This Plat of Survey is the notice of intent to file lien. Lien waiver required.
 - 3) The Survey Date shown on this Plat of Survey is the completion date of the field work.

Copyright © 2017 by Olson Land Surveying, LLC.

All rights reserved. No part of this survey plat may be reproduced or transmitted in any form by any means - graphic, electronic, or mechanical, including photocopying, tracing, or information storage and retrieval systems - without permission in writing from Douglas G. Olson, Olson Land Surveying, LLC.

I hereby certify that I have surveyed the above described property in compliance with Chapter A-E 7 of the Wisconsin Administrative Code and that the map hereon is correct to the best of my knowledge and belief.

Douglas G. Olson
Wisconsin Professional Land Surveyor - 2093

Sheet 1 of 1 Sheets

Job Reference Number
2017.007

Legend of Symbols & Abbreviations

- Found Iron Pipe
- Recorded Information
- Utility Pole
- Utility Pedestal
- Concrete Cover
- Septic Vent
- Asphalt Surface
- Concrete Surface
- Gravel Surface

- N North
- S South
- E East
- W West
- In Bearings
- ° Degrees
- ' Minutes
- " Seconds
- In Distances
- Feet
- Inches



45 South Wisconsin Street | P.O. Box 322
Elkhorn, Wisconsin. 53121
Telephone: (262) 723-3434
Facsimile: (262) 723-8044
Email: doug@olsonsurveying.com
Website: www.olsonsurveying.com

Scale in Feet
1" = 20'



Survey Date: March 23, 2017.

- Revisions:
- No. 1 - Proposed Shed
 - No. 2 - New Location of Proposed Shed
 - No. 3 - Size & Location of Proposed Shed
 - No. 4 - Shed under construction

LA 770-2 417-1100