

NOTE: THE ORDINARY HIGH WATER MARK WAS APPROXIMATED BY THIS OFFICE AND IS SHOWN FOR REFERENCE ONLY.

PLAT OF SURVEY
-OF-

LOT 1 OF CERTIFIED SURVEY MAP NO. 4710, AS RECORDED IN THE OFFICE OF THE REGISTER OF DEEDS FOR WALWORTH COUNTY, WISCONSIN ON MAY 23, 2017 IN VOLUME 31 OF CERTIFIED SURVEY MAPS ON PAGES 117-120 AS DOCUMENT NO. 946883 AND BEING A PART OF LOT 1 OF HULTQUISTS SUBDIVISION AND UNPLATTED LAND IN GOVERNMENT LOT 1 OF SECTION 24, TOWNSHIP 4 NORTH, RANGE 17 EAST, ALL OF SAID LANDS BEING A PART OF GOVERNMENT LOT 1 AND GOVERNMENT LOT 2 OF SECTION 24, TOWNSHIP 4 NORTH, RANGE 17 EAST OF THE FOURTH PRINCIPAL MERIDIAN, IN THE TOWN OF TROY, COUNTY OF WALWORTH AND STATE OF WISCONSIN.

SURVEY FOR: MICK & TRICIA MITTEN
SURVEY ADDRESS: W2598 BOOTH LAKE LANE

NOTE: REFER TO A CURRENT TITLE REPORT FOR EASEMENTS, RESTRICTIONS OR COVENANTS WHICH MAY AFFECT THIS PROPERTY.

BEARINGS HEREON RELATE TO GRID NORTH OF THE WISCONSIN STATE PLANE COORDINATE SYSTEM, SOUTH ZONE (NAD-1927). ASSUMED BEARING OF SOUTH 89°33'48" EAST ALONG THE NORTH LINE OF THE NORTHEAST 1/4 OF SECTION 24-4-17.

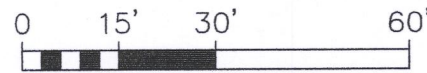
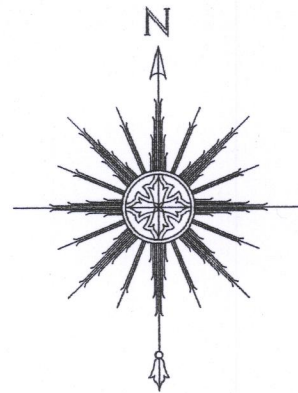

SCALE: 1" = 30'

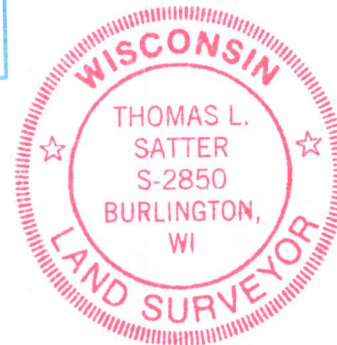
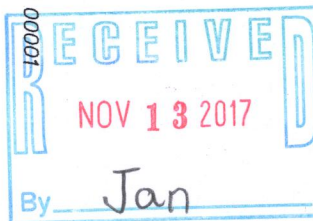

THIS IS NOT AN ORIGINAL PRINT
UNLESS THIS SEAL IS RED.

Thomas L. Satter

THOMAS L. SATTER

S-2850

"I HEREBY CERTIFY THAT I HAVE SURVEYED THE ABOVE DESCRIBED PROPERTY AND THAT THE ABOVE MAP IS A CORRECT REPRESENTATION THEREOF AND SHOWS THE SIZE AND LOCATION OF THE PROPERTY, ITS EXTERIOR BOUNDARIES, THE LOCATION OF ALL VISIBLE STRUCTURES AND DIMENSIONS OF ALL PRINCIPAL BUILDINGS THEREON, BOUNDARY FENCES, APPARENT EASEMENTS, ROADWAYS AND ENCROACHMENTS, IF ANY."

"THIS SURVEY IS MADE FOR THE USE OF THE PRESENT OWNERS OF THE PROPERTY, AND THOSE WHO PURCHASE, MORTGAGE, OR GUARANTEE THE TITLE THERETO WITHIN ONE YEAR FROM DATE HEREOF."

SATTER SURVEYING, LLC
LAND SURVEYS, MAPPING AND PLANNING
272 ORIGIN STREET
BURLINGTON, WI 53105
262-661-4239

BOOTH LAKE LANE

OCTOBER 18, 2017
DATE

101606d2
JOB NUMBER

LA4710-1

417-1056