

Plat of Survey

of

Lot 8 of Surrey Ridge,

a subdivision located in the Northwest 1/4 of Section 31, Town 4 North, Range 17 East, Town of Troy, Walworth County, Wisconsin.

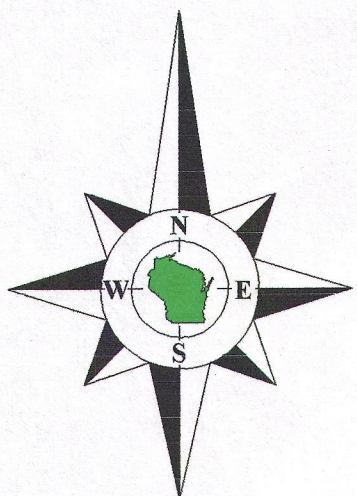

Bearings reference to the plat of Surrey Ridge.

Surveyed for: **Brett Getzen**
N7560 Carriage Drive
Elkhorn, Wisconsin. 53121

Lot 7
Surrey Ridge

S88°05'00"E 1132.87'

Lot 8
Tax Parcel
LSR 00008

7.881 Acres
343,291 Sq.Ft.

Rod is ±9'
W. of fence.

East line of the Northwest 1/4 of Section 31-4-17.

S1°05'55"W 300.74'

Tax Parcel
LT 3100003

Rod is ±4.5'
W. of fence.

Lot 9
Surrey Ridge

N88°05'00"W 1150.32'

671.13'

Copyright 2015 by Olson Land Surveying, LLC.

All rights reserved. No part of this survey plat may be reproduced or transmitted in any form by any means - graphic, electronic, or mechanical, including photocopying, tracing, or information storage and retrieval systems - without permission in writing from Douglas G. Olson, Olson Land Surveying, LLC.

I hereby certify that I have surveyed the above described property and the map hereon is correct to the best of my professional knowledge and belief and shows the size and location of the property, its exterior boundaries, the location and dimensions of all visible structures thereon, boundary fences, apparent easements and roadways and visible encroachments, if any.

This survey is made for the exclusive use of the present owners of the property, and also those who purchase, mortgage or guarantee title thereto, within one year from the date hereof.

Douglas G. Olson
Wisconsin Professional Land Surveyor - 2093

Center 1/4 Corner
Section 31-4-17

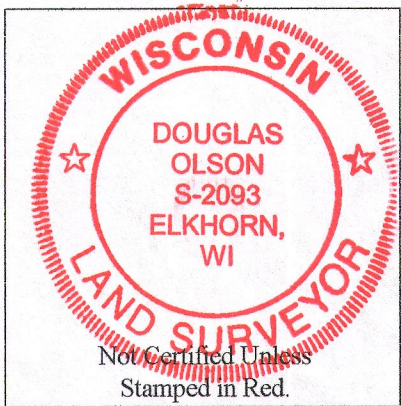

Notes:

- 1) This survey plat is not certified unless signed and sealed in red ink.
- 2) This survey is subject to Wisconsin lien laws. This Plat of Survey is the notice of intent to file lien. Lien waiver required.

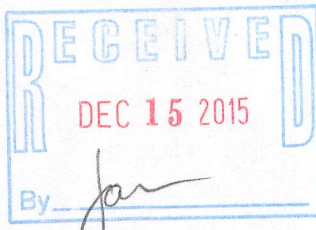

Survey Date: November 5, 2015.

Revisions:

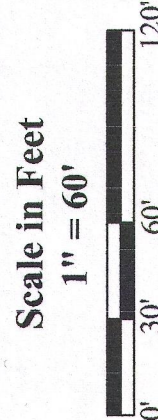

Olson Land Surveying, LLC



45 South Wisconsin Street * P.O. Box 322 * Elkhorn, Wisconsin. 53121
Telephone: (262) 723-3434 * Facsimile: (262) 723-8044
Email: doug@olsonsurveying.com

Legend

- Found County Section Corner
- Found Iron Rod 1" dia.
- Staked Boundary
- Recorded Information
- Utility Pedestal
- Asphalt Surface

Sheet 1 of 1 Sheets

Drawing Name:

Job Reference Number

2015.096

2015.096

L 8 R - 8 417- 1010