

PLAT OF SURVEY

LOT 31 AND 32 OF CALI ACRES  
SUBDIVISION LOCATED IN THE SOUTHWEST  
1/4 OF SECTION 35, TOWN 4 NORTH,  
RANGE 16 EAST, WALNORTH COUNTY,  
WISCONSIN.



ORDERED BY: T L C REALTY  
RT. 5 BOX 5  
ELKHORN, WI. 53121

BUYERS: MR AND MRS. JIM HYLAND

- Legend
- FOUND IRON PIPE
  - FOUND IRON ROD
  - FOUND BRASS CAPPED MONUMENT
  - FOUND CONCRETE MONUMENT
  - CHISEL CUT IN CONCRETE
  - SET IRON ROD, 24" LONG, WEIGHING 1.5 LBS., LINEAL FT., 3/4" DIA.
  - SET IRON ROD, 30" LONG, WEIGHING 4.5 LBS., LINEAL FT., 1-11/16" DIA.
  - (xx) RECORDED AS DIMENSION
  - EXISTING FENCE

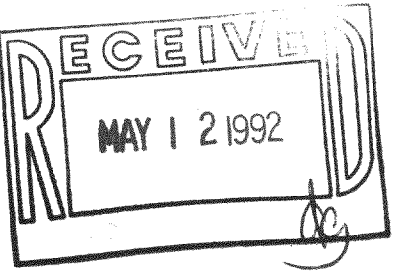

SCALE: 1" = 40 FEET

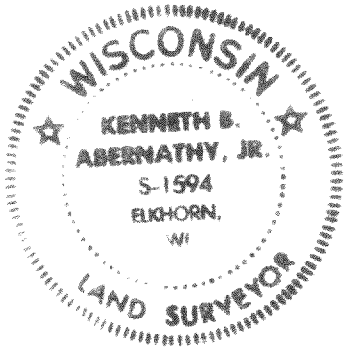

"I hereby certify that I have surveyed the above described property and that the above map is a true representation thereof and shows the size and location of the property, its exterior boundaries, the location of all visible structures and dimensions of all principal buildings thereon, boundary fences, apparent easements, roadways and visible encroachments, if any."

"This survey is made for the use of the present owners of the property, and also those who purchase, mortgage, or guarantee the title thereto within one year from date hereof."

*Kenneth B. Abernathy, Jr.*  
KENNETH B. ABERNATHY, JR.  
WISCONSIN REGISTERED LAND SURVEYOR,  
S-1594

Date: 11-6-91 Job No. 911003