

GEORGE T. DUNHAM  
SURVEYING & SUBDIVIDING  
DELAVER, WISCONSIN

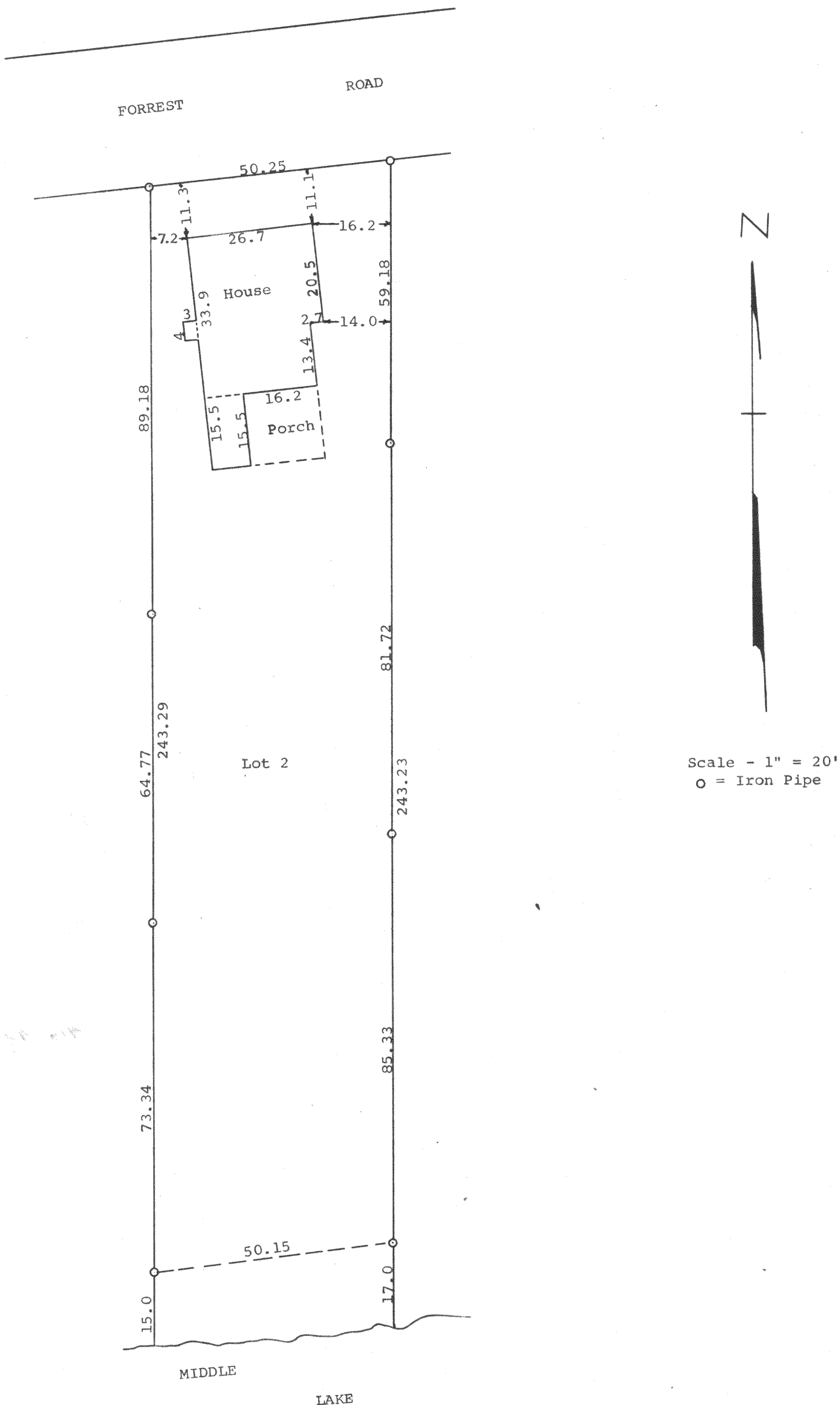

STATE OF WISCONSIN)  
COUNTY OF WALWORTH) SS

I, George T. Dunham, Surveyor, certify that I have surveyed the property described as follows, 416-42

Lot 2 in Block 2 of Cooper's Mid-Lakes Subdivision, as per plat recorded in the office of the Register of Deeds in Volume 8 of Plats on Page 42, Walworth County records and located in the Northwest  $\frac{1}{4}$  of Section 35, T 4 N, R 16 E, Walworth County, Wisconsin,

and that the above plat is an accurate survey and a true representation thereof and correctly shows the exterior boundary lines and location of the house on said property and the correct measurements thereof.

March 27, 1970

George T. Dunham  
George T. Dunham, Surveyor

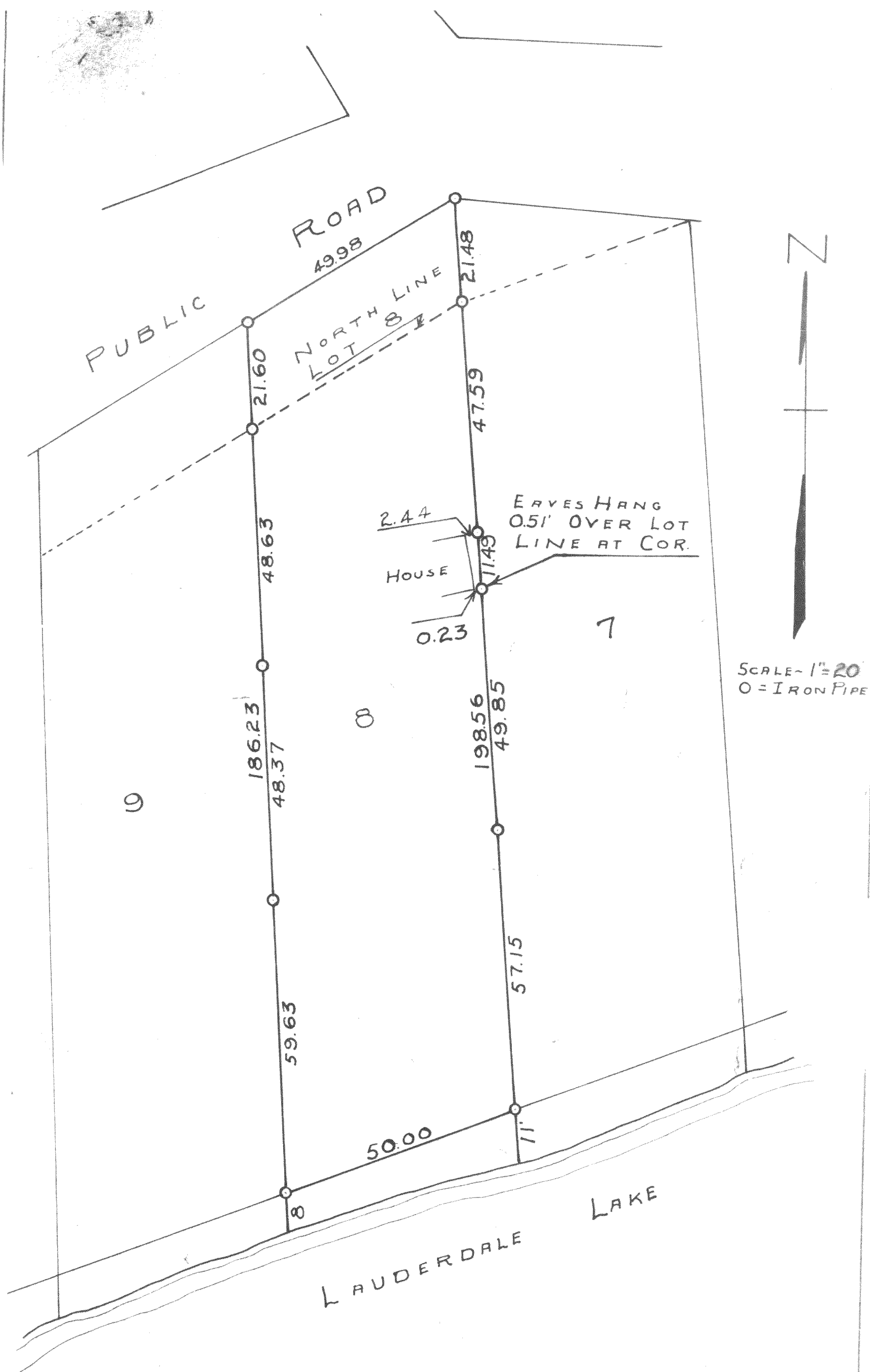

PLAT OF SURVEY OF LOT 8 BLOCK 3 OF  
 CARSWELL PARK AND A PARCEL OF LAND  
 ON THE NORTH END OF LOT 8 EXTENDING  
 TO THE PUBLIC ROAD, LOCATED IN  
 SECTION 35, T4NR16E WALWORTH COUNTY  
 WISCONSIN  
 OCT 1948

Lloyd L. Jensen  
 COUNTY SURVEYOR

416-42.

416-42

\*CA-30