

LEGEND: These standard symbols may be found in the drawing.

- Lot Corner (Found) w/desc.
- Elec. Trans. Box
- Utility Pedestal
- ⊕ Man Hole
- ⊗ Water Valve
- ⊗ Natural Gas Sign
- Setback Line
- - - Easement Boundary

PLAT OF SURVEY

FOR LOT 12 OF GLADHURST, AND BEING A PART OF THE SE 1/4 OF THE SOUTHEAST QUARTER OF SECTION 23, TOWN 4 NORTH, RANGE 16, EAST, TOWN OF LAGRANGE, WALWORTH COUNTY, WISCONSIN.

LOT 11
EXISTING BUILDING
T.O.F. = 946.6

C1
RAD = 196.21'
ARC = 40.28'
CHD = 40.21'
C.B. = S 04°-04'-46" E

S 88°-53'-05" E 350.88'

72.0'

TEMP. #2
STONE DRIVE

100.3'

LOT 12
72,720 SQ. FT.
1.6694 ACRES

180.8'

S 88°-53'-05" E 355.00'

LOT 13
EXISTING BUILDING
T.O.F. = 948.9

ROSE TERRACE
(66' PRIVATE R-O-W)

BEARINGS ARE REFERENCED TO THE EAST LINE OF THE SOUTHWEST QUARTER OF SECTION 23-04-16, WHICH IS ASSUMED TO BEAR N 01°-06'-55" E.

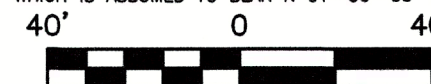

State of Wisconsin }
County of Jefferson } SS.

I, Scott D. Thomas, L.P.L.S., do hereby certify that I have made this survey and that the information as shown on the above Plat of Survey is a true and correct representation thereof. Lots are drawn from subdivision plats/C.S.M.s; unplatted lands from recorded deeds/surveys. Boundary survey plats reflect field-located information; consult a title attorney to discover all the legal encumbrances attached to any property.

IF THE SURVEYOR'S SEAL IS NOT WET STAMPED IN RED AND SIGNED IN OPPOSABLE INK, THE PLAT IS A COPY THAT SHOULD BE ASSUMED TO CONTAIN UN-AUTHORIZED ALTERATIONS. THE CERTIFICATION ON THIS DOCUMENT DOES NOT APPLY TO ANY COPIES NOR DIGITAL FORMATS UNLESS VERIFIED DIGITAL CERTIFICATE BY SAME EXISTS UN-ALTERED.

OWNER: Christansen
BUILDER: Espire Homes, Inc.
530 Hartbrook Dr.
Hartland, WI 53029
PH: (262) 746-2000

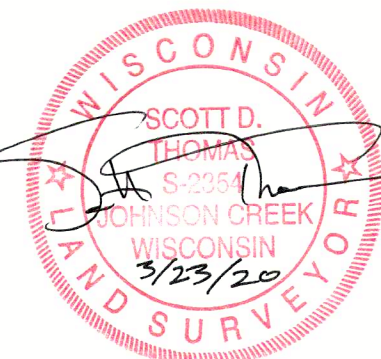

416-3553