

Lot 2
C.S.M. 2938

Lot 117

Plat of Survey

of

Lot 106 of Mariner Hills,

a subdivision located in the Northwest 1/4 of the Southwest 1/4 of Section 34,
Town 4 North, Range 16 East, Town of LaGrange, Walworth County, Wisconsin.

Surveyed for:

S&S Concrete of Walworth County, LLC

N6719 Walnut Road
Elkhorn, Wisconsin. 53121

Survey Date: June 10, 2022.
Revisions: No. 1 - Proposed House
As Staked
No. 2 - As-Built

Scale in Feet
1" = 20'



45 South Wisconsin Street | P.O. Box 322
Elkhorn, Wisconsin. 53121
Telephone: (262) 723-3434
Facsimile: (262) 723-8044
Email: doug@olsonsurveying.com
Website: www.olsonsurveying.com

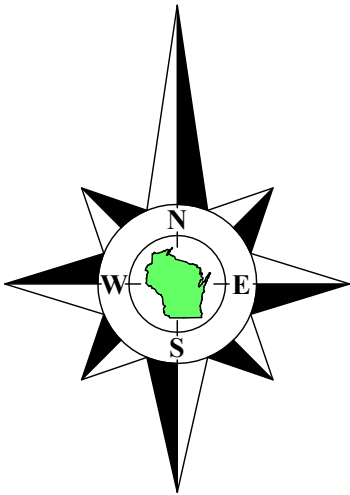

Bearings referenced to the East line of Lot 106,
recorded as North on the plat of Mariner Hills.

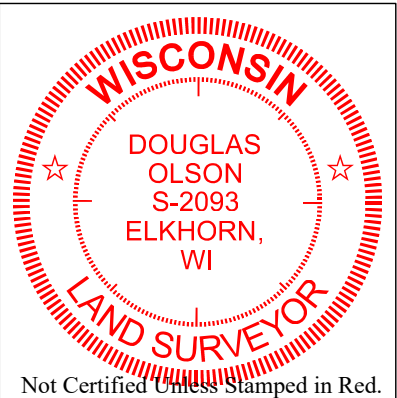

Notes:

- 1) This Plat of Survey is not certified unless signed and sealed in red ink.
- 2) This survey is subject to Wisconsin lien laws. This Plat of Survey is the notice of intent to file lien. Lien waiver required.
- 3) The Survey Date shown on this Plat of Survey is the completion date of the field work.

Copyright ©2022 by Olson Land Surveying, LLC.

All rights reserved. No part of this survey plat may be reproduced or transmitted in any form by any means - graphic, electronic, or mechanical, including photocopying, tracing, or information storage and retrieval systems - without permission in writing from Douglas G. Olson, Olson Land Surveying, LLC.

I hereby certify that I have surveyed the above described property in compliance with Chapter A-E 7 of the Wisconsin Administrative Code and that the map hereon is correct to the best of my professional knowledge and belief and shows the size and location of the property, its exterior boundaries, the location and dimensions of all visible structures thereon, boundary fences, apparent easements and roadways and visible encroachments, if any.

This survey is made for the exclusive use of the present owners of the property, and also those who purchase, mortgage or guarantee title thereto, within one year from the date hereof.

Douglas G. Olson
Wisconsin Professional Land Surveyor - 2093

OLSON
LAND SURVEYING, LLC
Rural | Residential | Commercial

Legend of Symbols & Abbreviations
Found County Section Corner
Found Iron Pipe
Set Iron Pipe, 1" dia.
Recorded Information
Utility Box or Pedestal
Septic Vent
Asphalt Surface
Concrete Surface
North
South
East
West
Bearing
Distance
Feet
Inches

Sheet 1 of 1 Sheets

Job Reference Number
2022.066

2022.066