

# Plat of Survey

of

## Lot 1 of Certified Survey Map No. 36,

recorded in Vol. 1 of Certified Survey Maps of Walworth County on Page 36 and located in the Southwest 1/4 of Section 35, Town 4 North, Range 16 East, Town of LaGrange, Walworth County, Wisconsin.

Surveyed for: **d'aprile properties**

104 West Main Street  
Fontana, Wisconsin. 53125



Bearings referenced to the East line of the Southwest 1/4 of Section 35-4-16, recorded as S1°28'39"E in the Wisconsin State Plane Coordinate System, South Zone, (NAD-27).

Coordinates are referenced to the Wisconsin State Plane Coordinate System, South Zone, (NAD-27).

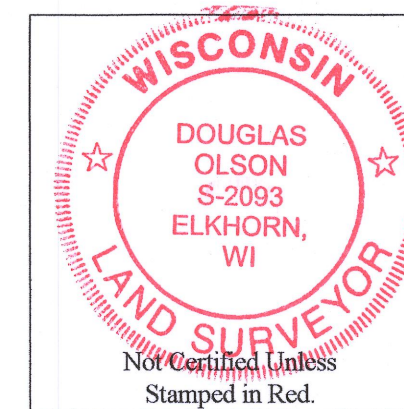

### Notes:

- 1) This Plat of Survey is not certified unless signed and sealed in red ink.
- 2) This survey is subject to Wisconsin lien laws. This Plat of Survey is the notice of intent to file lien. Lien waiver required.
- 3) The Survey Date shown on this Plat of Survey is the completion date of the field work.

Copyright ©2020 by Olson Land Surveying, LLC.

All rights reserved. No part of this survey plat may be reproduced or transmitted in any form by any means - graphic, electronic, or mechanical, including photocopying, tracing, or information storage and retrieval systems - without permission in writing from Douglas G. Olson, Olson Land Surveying, LLC.

I hereby certify that I have surveyed the above described property in compliance with Chapter A-E 7 of the Wisconsin Administrative Code and that the map hereon is correct to the best of my professional knowledge and belief and shows the size and location of the property, its exterior boundaries, the location and dimensions of all visible structures thereon, boundary fences, apparent easements and roadways and visible encroachments, if any.

This survey is made for the exclusive use of the present owners of the property, and also those who purchase, mortgage or guarantee title thereto, within one year from the date hereof.

Douglas G. Olson  
Wisconsin Professional Land Surveyor - 2093

Survey Date: October 6, 2020.  
Revisions:

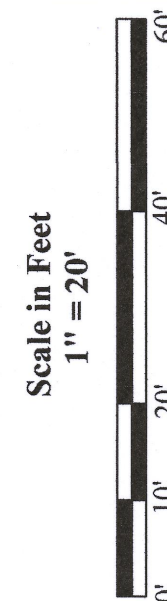

45 South Wisconsin Street | P.O. Box 322  
Elkhorn, Wisconsin 53121  
Telephone: (262) 723-3434  
Facsimile: (262) 723-8044  
Email: doug@olsonsurveying.com  
Website: www.olsonsurveying.com

**OLSON**  
LAND SURVEYING, LLC  
Rural | Residential | Commercial

**Legend of Symbols & Abbreviations**

N	North
S	South
E	East
W	West
°	in Degrees
'	in Minutes
"	in Seconds
+	in Distances
+	in Feet

Found County Section Corner  
Found Iron Pipe, 2" dia.  
Found Iron Rod, 3/4" dia.  
Set Iron Pipe, 1" dia.  
Recorded Information  
Utility Pole  
Asphalt Surface

Sheet 1 of 1 Sheets

Drawing Name

Job Reference Number

2020.127

2020.127

Lot 3

Lot 16  
Block 4  
Cool Hill Park

Screen  
Porch

recorded as (S88°27'W 256.31')  
**N86°44'44"E 256.25'**

Intermittent remains of Woven Wire Fence along line as shown

118.25'

Fence Post  
1.4' S. of line

Fence Post  
1.0' S. of line

Fence Post  
0.8' S. of line

138.00'

24.67'

recorded as (S0°15'W 712.28')  
**S1°28'39"E 718.39'**

vert

Entrance

recorded as (N0°15'E 200.00')  
**S1°28'33"E 199.93'**

Culvert

**Lost Nation Road**  
(49.5' Wide)

East line of the Southwest 1/4 of Section 35-4-16.  
recorded as (S1°28'39"E 2081.60')  
**S1°28'39"E 2081.60'**

recorded as (S1°28'39"E 2081.35') State Plane

Meander Corner  
Section 35-4-16  
N. 279.419.92  
E. 2,383,128.82

**Lot 1**  
**Tax Parcel**  
**HA 3600001**  
1.178 Acres  
51,317 Sq.Ft.

76' Building Setback Line  
As shown on Certified Survey Map No. 36

**S86°41'33"W 257.05'**  
recorded as (S88°27'W 257.12')

Woven Wire Fence

Fence 1.0'  
N. of line

Fence 1.7'  
N. of line

Fence 0.8'  
N. of line

Fence 0.3'  
N. of line

(N0°15'E 150.00')  
**N1°27'16"W 150.08'**

Lot 4

recorded as (S0°29'W 200.00')  
**N1°15'00"W 200.19'**

Woven Wire Fence

Fence 1.2'  
N. of line

Fence 0.3'  
N. of line

Fence 0.4'  
N. of line

1.8'

Lot 5

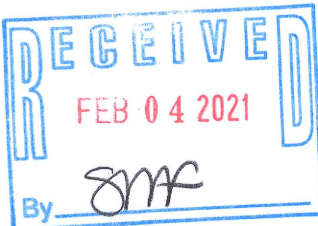

Lot 2  
C.S.M. 36

HA 36-1

416-3227