

Lauderdale

Lake

Plat of Survey

of

Lot 1 of Baywood Estates,

a subdivision located in the Northeast 1/4 of the Northwest 1/4 of Section 1, Town 3 North, Range 16 East, Town of Sugar Creek, and the Southeast 1/4 of the Southwest 1/4 of Section 36, Town 4 North, Range 16 East, Town of LaGrange, Walworth County, Wisconsin.

Surveyed for: **Gregory Gesualdo**

2777 Marden Court
Northbrook, Illinois. 60062

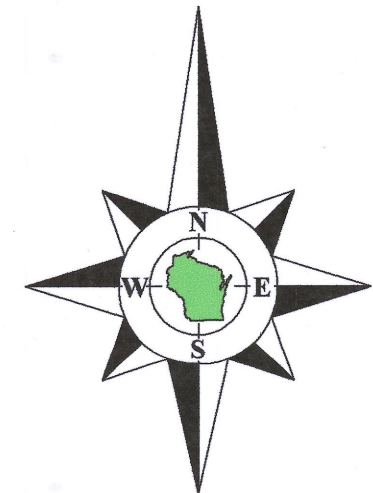

Bearings referenced to the South line of Lots 11 & 12, of Strawberry Banke Plantation, recorded as N44°47'E on the plat of Strawberry Banke Plantation, which produces a bearing of S89°24'46"W on the North line of the Northwest 1/4 of Section 1-3-16. A rotation of 2°10'22" from the Wisconsin State Plane Coordinate System, South Zone, (NAD-27).

Coordinates are referenced to the Wisconsin State Plane Coordinate System, South Zone, (NAD-27).

Lot 10
Strawberry Banke
Plantation

Tax Parcel
HBE 00001

Lot 1
0.749 Acre
32,614 Sq.Ft.

House
W5182

Lot 2

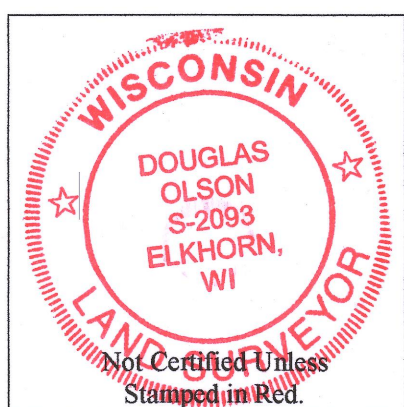
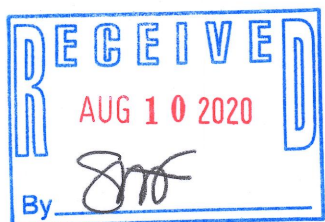

Notes:

- 1) This Plat of Survey is not certified unless signed and sealed in red ink.
- 2) This survey is subject to Wisconsin lien laws. This Plat of Survey is the notice of intent to file lien. Lien waiver required.
- 3) The Survey Date shown on this Plat of Survey is the completion date of the field work.

Witness Corner
Section 1-3-16
(N. 279,108.37)
(E. 2,386,966.78)

recorded as (S87°14'24"W 1447.73') State Plane
S89°24'46"W 1447.62'
South line of the Southwest 1/4 of Section 36-4-18.
North line of the Northwest 1/4 of Section 1-3-16.

Copyright © 2020 by Olson Land Surveying, LLC.

All rights reserved. No part of this survey plat may be reproduced or transmitted in any form by any means - graphic, electronic, or mechanical, including photocopying, tracing, or information storage and retrieval systems - without permission in writing from Douglas G. Olson, Olson Land Surveying, LLC.

I hereby certify that I have surveyed the above described property in compliance with Chapter A-E 7 of the Wisconsin Administrative Code and that the map hereon is correct to the best of my professional knowledge and belief and shows the size and location of the property, its exterior boundaries, the location and dimensions of all visible structures thereon, boundary fences, apparent easements and roadways and visible encroachments, if any.

This survey is made for the exclusive use of the present owners of the property, and also those who purchase, mortgage or guarantee title thereto, within one year from the date hereof.

Douglas G. Olson
Wisconsin Professional Land Surveyor - 2093

Sheet 1 of 1 Sheets

Drawing Name:

Job Reference Number
2020.068

Legend of Symbols & Abbreviations

Found County Section Corner	N North
Found Iron Pipe, 1" dia.	S South
Recorded Information	E East
Utility Pole	W West
Utility Pedestal	In Bearings
Concrete Cover	Degrees
Asphalt Surface	Minutes
Sand Surface	Seconds
Drain	In Distances
Lamp	Feet
Septic Vent	Inches
Concrete Surface	
Brick Pavers	



45 South Wisconsin Street | P.O. Box 322
Elkhorn, Wisconsin. 53121
Telephone: (262) 723-3434
Facsimile: (262) 723-8044
Email: doug@olsonsurveying.com
Website: www.olsonsurveying.com

Scale in Feet
1" = 20'



Survey Date: June 24, 2020.

Revisions:

North 1/4 Corner
Section 1-3-16
(N. 279,178.07)
(E. 2,386,412.76)

Town of LaGrange
Town of Sugar Creek

Plantation Road
(Width Varies)

Strawberry
Hill Road

2020.068