

# Plat of Survey

of

## Unit 3B of Lauderdale Shores

### A Recreational Vehicle

#### Condominium, Fourth Amendment,

located in Government Lot 3 in the Northwest 1/4 of Section 25, Town 4 North, Range 16 East, Town of LaGrange, Walworth County, Wisconsin.

Fourth Amendment to Declaration of Condominium of Lauderdale Shores Condominium, Town of LaGrange, Walworth County, Wisconsin, recorded in Vol. 611, Page 763, Doc. No. 251421.

Surveyed for: **Tim Gallagher**

375 Holly Avenue  
Elmhurst, Illinois. 60126



Bearings reference to the plat of Lauderdale Shores A Recreational Vehicle Condominium.

Overhead Wires

**Luebke Drive**  
(22' Wide)

Common Element

recorded as (S84°45'33"W 37.49')  
N84°48'01"E 37.33'

Shed

**Unit 3B**  
**Tax Parcel**  
**HLAS 00003B**  
Portion South of Road  
0.095 Acre  
4,131 Sq.Ft.

"Cabin"

Common Element

Playground

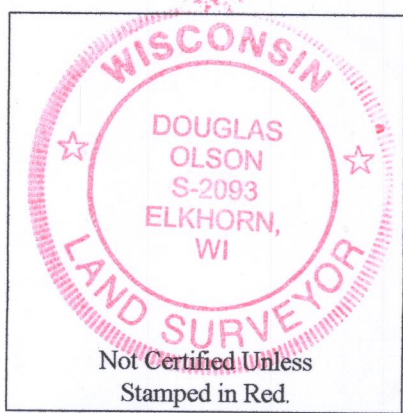

#### Notes:

- 1) This Plat of Survey is not certified unless signed and sealed in red ink.
- 2) This survey is subject to Wisconsin lien laws. This Plat of Survey is the notice of intent to file lien. Lien waiver required.
- 3) The Survey Date shown on this Plat of Survey is the completion date of the field work.

Copyright ©2018 by Olson Land Surveying, LLC.

All rights reserved. No part of this survey plat may be reproduced or transmitted in any form by any means - graphic, electronic, or mechanical, including photocopying, tracing, or information storage and retrieval systems - without permission in writing from Douglas G. Olson, Olson Land Surveying, LLC.

I hereby certify that I have surveyed the above described property in compliance with Chapter A-E 7 of the Wisconsin Administrative Code and that the map hereon is correct to the best of my professional knowledge and belief and shows the size and location of the property, its exterior boundaries, the location and dimensions of all visible structures thereon, boundary fences, apparent easements and roadways and visible encroachments, if any.

This survey is made for the exclusive use of the present owners of the property, and also those who purchase, mortgage or guarantee title thereto, within one year from the date hereof.

Douglas G. Olson  
Wisconsin Professional Land Surveyor - 2093

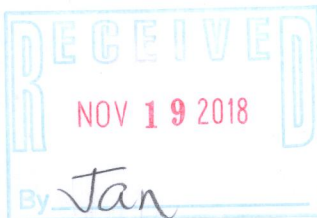

**Green Lake**

Sheet 1 of 1 Sheets

Drawing Name:

Job Reference Number

2017.147

#### Legend of Symbols & Abbreviations

- |                             |                  |           |
|-----------------------------|------------------|-----------|
| ● Found Iron Rod            | ✱ Found Mag Nail | N North   |
| ○ Found Railroad Spike      | ✱ Set Cut Cross  | S South   |
| ○ Set Iron Pipe, 1" dia.    | □ Set Mag Nail   | E East    |
| ○ Recorded Information      | ○ Bollard        | W West    |
| ○ Utility Pole              | ○ In Bearings    | ° Degrees |
| ○ Concrete Cover or Manhole | ○ Minutes        | ' Minutes |
| ○ Asphalt Surface           | ○ PVC Cap        | " Seconds |
| ○ Concrete Surface          | ○ Distances      | ' Feet    |
| ○ Brick Pavers              | ○ Inches         |           |



45 South Wisconsin Street | P.O. Box 322  
Elkhorn, Wisconsin. 53121  
Telephone: (262) 723-3434  
Facsimile: (262) 723-8044  
Email: doug@olsonsurveying.com  
Website: www.olsonsurveying.com

Scale in Feet  
1" = 10'

0' 5' 10' 20' 30'

Survey Date: June 15, 2018.  
Revisions: No. 1 - Legal Desc.

HLAS - 43 416/ 30.54