

Plat of Survey

of

Lots 3 & 4 of Certified Survey Map No. 36,

recorded in Vol. 1 of Certified Survey Maps of Walworth County on Page 36 and located in the Southwest 1/4 of Section 35, Town 4 North, Range 16 East, Town of LaGrange, Walworth County, Wisconsin.

Surveyed for:

Godfrey, Leibsle, Blackbourn & Howarth, S.C.

354 Seymour Court
Elkhorn, Wisconsin. 53121

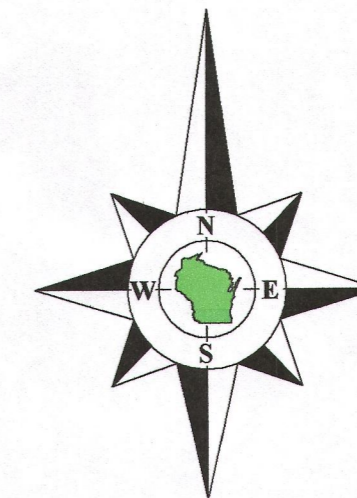

Bearings reference to the Wisconsin State Plane Coordinate System, South Zone.

Legal Description of Proposed Lot Line Adjustment

Part of Lot 4 of Certified Survey Map No. 36, recorded in Vol. 1 of Certified Survey Maps of Walworth County on Page 36 and located in the Southwest 1/4 of Section 35, Town 4 North, Range 16 East, Town of LaGrange, Walworth County, Wisconsin, described as follows: Begin at the Northeast corner of said Lot 4; thence South 1°27'16" East, along the East line of said Lot 4, 20.00 feet to an iron pipe; thence North 83°26'19" West 30.00 feet to an iron pipe; thence North 48°06'25" West 21.00 feet to an iron pipe on the North line of said Lot 4; thence North 86°45'38" East, along said North line, 45.00 feet to the Point of Beginning.

Said parcel contains 0.015 acre (632 sq.ft.) of land, more or less.

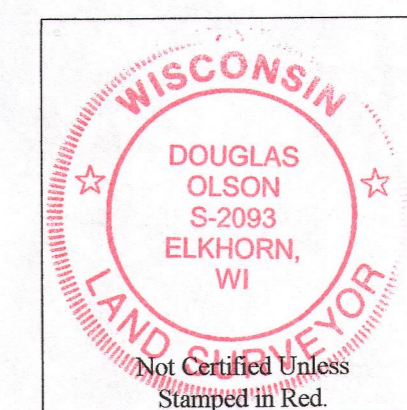

Notes:

- 1) This survey plat is not certified unless signed and sealed in red ink.
- 2) This survey is subject to Wisconsin lien laws. This Plat of Survey is the notice of intent to file lien. Lien waiver required.

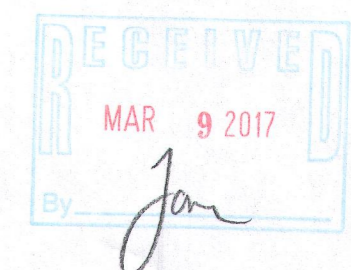

Survey Date: November 8, 2016.
Revisions: No. 1 - Lot Line Adjustment

Scale in Feet
1" = 30'
0' 15' 30' 60'

Olson Land Surveying, LLC

45 South Wisconsin Street * P.O. Box 322 * Elkhorn, Wisconsin. 53121
Telephone: (262) 723-3434 * Facsimile: (262) 723-8044
Email: doug@olsonsurveying.com

Legend

- Found County Section Corner
- Found Iron Rod, 1-3/4" dia.
- Found Iron Rod, 3/4" dia.
- Set Road Information
- Utility Pole
- Concrete Cover per owner
- Septic Vent
- Asphalt Surface
- Concrete Sign
- Brick Pavers or Stone

Sheet 1 of 1 Sheets

Job Reference Number
2016.124

2016.124

HA 36-3
HA 36-4
416-2905