

LAND-MARK SURVEYING
Mark L. Miritz

Wisconsin Professional Land Surveyor S-2582

N9330 Knuteson Drive
Whitewater, WI 53190
Phone: (262) 495-3284
MARKMIRITZ@
LAND-MARKSURVEYING.COM

PLAT OF SURVEY

All that part of the Block 3 of Green Lake Park, according to the recorded plat thereof, Town of La Grange, County of Walworth, State of Wisconsin, described as follows: Commencing at the Southwest corner of said Block 3; thence North in the West line of said tract projecting to a point in the lake located 250 feet North of the place of beginning; thence East at right angles 275 feet to a point; thence South parallel to the West line of said Block 3, 250 feet to the South line of said Block 3; thence West on the South line of said Block 3, 275 feet to the place of beginning. EXCEPTING therefrom that part of the above described premises lying beneath the waters of Lauderdale Lakes.

ORDERED BY: KAREN OSTERMEIER
KEEFE REAL ESTATE
204 E. COMMERCE CT.
ELKHORN, WI 53121



LEGEND

- FOUND IRON PIPE
- FOUND IRON ROD
- FOUND CONCRETE MONUMENT
- SET IRON ROD, 18" LONG, WEIGHING 1.5 LBS./LINEAL FT., 3/4" DIA.
- RECORDED AS DIMENSION
- EXISTING WIRE FENCE

SCALE: 1 INCH = 40 FEET

"I hereby certify that the above described property has been surveyed by me or under my direction and that the above map is a true representation thereof and shows the size and location of the property, its exterior boundaries, the location of all visible structures and dimensions of all principal buildings thereon, boundary fences, apparent easements, roadways and visible encroachments, if any."
"This survey is made for the use of the present owners of the property, and also those who purchase, mortgage, or guarantee the title thereto within one year from date hereof."

Mark L. Miritz
MARK L. MIRITZ
WISCONSIN PROFESSIONAL
LAND SURVEYOR S-2582

DATE: JUNE 15, 2016 JOB NO. 16.508

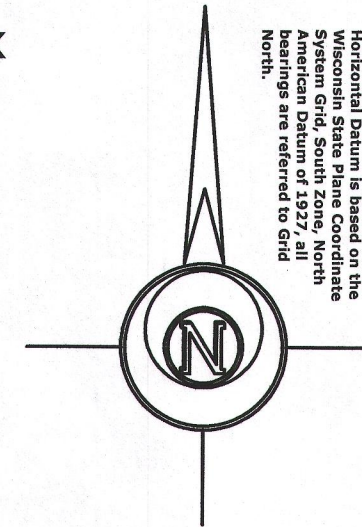

SURVEYOR'S NOTE:

THE SUBDIVISION PLAT OF GREEN LAKE PARK WAS DONE IN 1893 AND DOES NOT SHOW ANY ROAD ALONG THE SOUTH LINE OF BLOCK 3. THE SUBJECT PARCEL CONTAINS THE INTERSECTION OF EAST ROAD (AKA PARK ROAD) AND WEST SHORE DRIVE. THIS PARCEL IS SUBJECT TO A ROAD EASEMENT OF VARYING WIDTH.

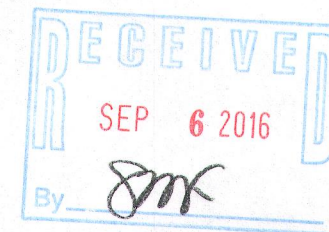

GREEN LAKE

THE STATE OF WISCONSIN OWNS ALL LAKE BEDS TO THE ORDINARY HIGH WATER (OHW) ELEVATION 884.61'. DETERMINED BY PAM SCHENSE, APRIL 1, 2010
WISCONSIN DEPARTMENT OF NATURAL RESOURCES

BLOCK 3, GREEN LAKE PARK

TAX KEY NO. HGP 00018A
33,278 SQ. FT.

100 YEAR FLOOD
ELEVATION 886.00'

WEST SHORE DRIVE
WIDTH VARIES

EAST ROAD

EXCEPTION
WARRANTY DEED
VOL. 295, P.84
DOC. #85080

THIS PORTION OF RIGHT-OF-WAY
RETRACES LLOYD L. JENSEN SURVEY
2/1/1960 WITH THE WIDTH AT 50'

HGP-18A

416-2855