

**PLAT OF SURVEY
TOPOGRAPHICAL MAPPING**

Lot 9, Block 2, Thansland as platted and recorded in the Register of Deeds office at Elkhorn, Wisconsin. Also the following Parcel of land; commencing at the Southwest corner of the above described Lot No. 9, thence South 137 feet to an Iron Stake, thence Northeasterly 46 1/2 feet to an Iron Stake, thence North 125 feet to the Southeast corner of Lot 9, thence West along the South Line of said lot to the place of beginning. All being a portion of Section 35, T4N, R16E, in the Town of La Grange, Walworth County, Wisconsin.



LEGEND
 ● IRON STAKE FOUND
 ○ IRON STAKE SET
 ▲ IRON STAKE FOUND IN REMNANT WALL
 [---] - RECORDED AS

NOTE: COPIES OF THIS MAP TO WHICH THE FOLLOWING CERTIFICATE WILL APPLY SHOW THE LOCATION OF THE PROPERTY AND ITS EXTERIOR BOUNDARIES. THIS SURVEY WAS CONDUCTED ON NOVEMBER 16, 2015. I HEREBY CERTIFY THAT THE ABOVE DESCRIBED PROPERTY HAS BEEN SURVEYED UNDER MY DIRECTION AND THAT THE ABOVE MAP IS A TRUE REPRESENTATION OF THE SURVEY AND LOCATION OF THE PROPERTY AND ITS EXTERIOR BOUNDARIES. THIS SURVEY WAS CONDUCTED IN ACCORDANCE WITH THE REQUIREMENTS OF THE SURVEYING ACT AND I AM A LICENSED SURVEYOR IN THE STATE OF WISCONSIN. THE DATE OF THIS SURVEY IS NOVEMBER 16, 2015.

PETER S. GORBOON P.L.S. 200

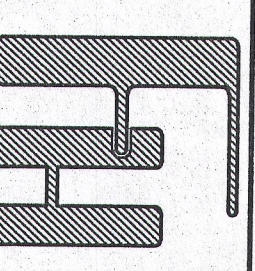
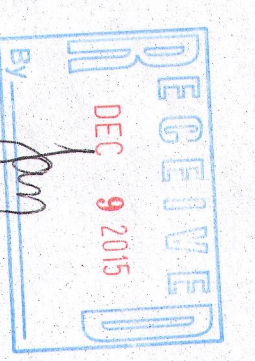
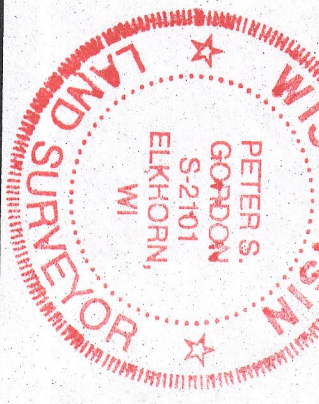

**PLAT OF SURVEY
TOPOGRAPHICAL MAPPING**
 TOWN OF LA GRANGE, WALWORTH COUNTY, WISCONSIN

WORK ORDERED BY -
 PAT & BILL REID
 3310 CHARLEMAGNE LANE
 ST. CHARLES, IL 60174

FARRIS, HANSEN & ASSOCIATES, INC.
 ENGINEERING - ARCHITECTURE - SURVEYING
 7 RIDGWAY COURT P.O. BOX 437
 ELKHORN, WISCONSIN 53121
 OFFICE: (262) 723-2098 FAX: (262) 723-5886

12/7/2015
 4:00 PM
 PROJECT NO. 9398
 DATE 11/16/2015
 SHEET NO. 1 OF 1

HTL-19 416-2811

