



WORK ORDERED BY:  
MIKE STRAW  
W5010 HAWK ROAD  
ELKHORN, WI. 53121

FARRIS, HANSEN & ASSOCIATES, INC.  
ENGINEERING - ARCHITECTURE - SURVEYING  
7 RIDGEWAY COURT P.O. BOX 437  
ELKHORN, WISCONSIN 53121  
OFFICE: (262) 723-2088 FAX: (262) 723-5886

REVISIONS

PROJECT NO.	9330
DATE:	08-05-2015
SHEET NO.	1 OF 1

PERMIT PLAT  
LOT 6 WALNUT HILLS SUBDIVISION  
LOCATED IN THE NW 1/4 OF THE NE 1/4 SECTION 36  
TOWN 4 NORTH, RANGE 16 EAST  
WALWORTH COUNTY, WI.

(S 88°55' E)  
S 88°55'29" E  
298.95' (298.87')

N 04°40'37" W  
C=48.15  
R=240.00

ASSIGNED SOUTH LINE LOT 6  
N 88°59'55" W

LOT 5

LOT 6

256.35' (256.20')  
S 01°11'12" W  
(S 01°08' W)

HAWK ROAD  
(66' WIDE)

(N 01°13' E)  
N 01°12'35" E  
208.82' (208.86')

62.6'

62.7'

62.9'

11.4'

23.9'

20.5'

EXISTING  
RESIDENCE

PORCH

AS BUILT  
BUILDING

WATER MAIN  
EASEMENT  
DOC. 49458

W / NO EL

294.11' (294.23')  
N 88°59'55" W  
(N 88°01'30" W)

6' UTILITY EASEMENT

16.2' X 12'  
SHED

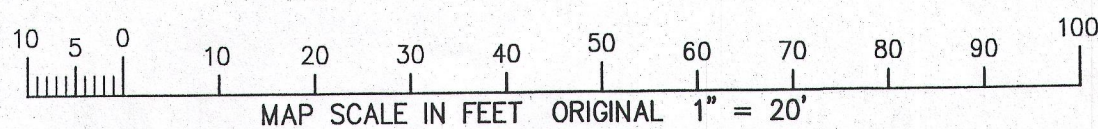

REVISED 09-29-2015  
TO SHOW AS BUILT  
GARAGE

NOTE: COPIES OF THIS MAP TO WHICH THE FOLLOWING CERTIFICATE WILL APPLY SHOW THE SURVEYOR'S ORIGINAL SEAL AND SIGNATURE IN RED INK. COPIES BY ANY OTHER MEANS MAY HAVE ALTERATIONS WHICH DO NOT REPRESENT THE SURVEYOR'S WORK PRODUCT.

I HEREBY CERTIFY THAT THIS PLAT IS A TRUE AND ACCURATE REPRESENTATION OF THE LOCATION OF THE PROPOSED BUILDING IN RELATION TO THE WEST AND SOUTH LINES OF LOT 6 AS FOUND TO BE MONUMENTED AS SHOWN TO THE BEST OF MY PROFESSIONAL KNOWLEDGE AND BELIEF. NOTE: THIS IS NOT A SURVEY AS DEFINED IN CHAPTER A-E 7 OF WISCONSIN ADMINISTRATIVE CODE.

DATED: AUGUST 10, 2015

PETER S. GORDON PLS 2101

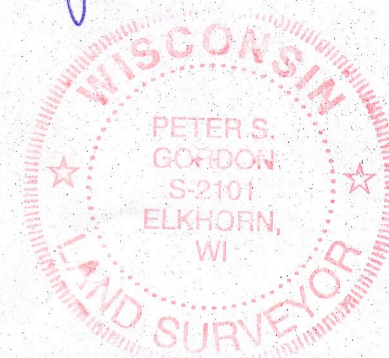
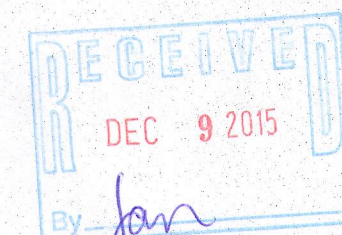

416-2804

9/29/2015 X:\Projects\9330\Record Survey

SEP 29 2015

HTLW-6