

Plat of Survey

of
A Portion of Lots 1 & 26 of Green Island,
 a subdivision located in the Southeast 1/4 of Section 26, Town 4 North,
 Range 16 East, Town of LaGrange, Walworth County, Wisconsin.

A parcel of land described in Title Commitment No. WA-1196 prepared by Chicago Title Insurance Company, dated October 31, 2013, as shown below:

A parcel of land located in Lots 1 and 26 of Green Island Subdivision, which Subdivision is located in Section 26, Town 4 North, Range 16 East of Walworth County, Wisconsin. described as follows, to-wit: Commencing at a point on the Westerly line of Lot 1 of said subdivision, which point is located 5.24 feet Northerly of the Southwest corner of said Lot; thence N 81°-21' E 35.23 feet to the place of beginning; thence N. 12° - 35' W 106 feet more or less to the shore of Green Lake; thence Southeastly along the shore 146.3 feet to a private road; thence S. 64° - 09' W 8.0 feet along said road; thence S. 81° - 21' W 73.92 feet along said road to the place of beginning.

Also commencing at a point on the Westerly line of Lot 1 of said Subdivision, which point is located 5.24 feet Northerly of the Southwest corner of said lot; thence N. 81° - 21' E, 35.23 feet to a point; thence S 61° - 05' E 40.54 feet to the place of beginning; thence S 28° - 40' E 21.73 feet to the shore of Middle Lake; thence Northeasterly along the shore 39.5 feet to a private road; thence S 81° - 33' W 41.78 feet along said road to the place of beginning.

Excepting therefrom any portion thereof as may be included in a Quit Claim Deed from Charles Bradley and Joan Bradley, etal, to the Town of LaGrange recorded July 7, 1967 in Volume 650 of Deeds on page 293 as Document No. 592993.

Surveyed for: **Century 21 Affiliated**
 217 South 7th Street * Unit B
 Delavan, Wisconsin. 53115

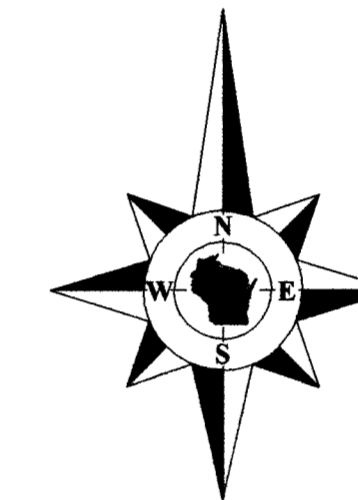

Bearings reference to prior surveys of record.

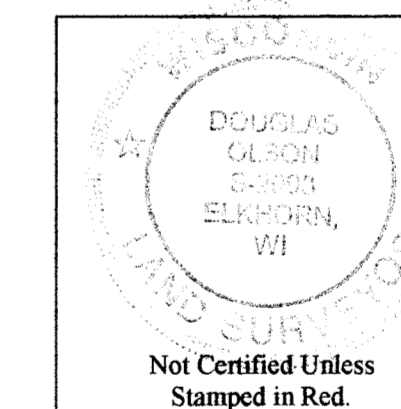

Notes:

- 1) This survey plat is not certified unless signed and sealed in red ink.
- 2) This survey is subject to Wisconsin lien laws. This Plat of Survey is the notice of intent to file lien. Lien waiver required.

Copyright 2013 by Jensen & Olson Land Surveying, LLC.

All rights reserved. No part of this survey plat may be reproduced or transmitted in any form by any means - graphic, electronic, or mechanical, including photocopying, tracing, or information storage and retrieval systems - without permission in writing from Douglas G. Olson, Jensen & Olson Land Surveying, LLC.

I hereby certify that I have surveyed the above described property and the map hereon is correct to the best of my professional knowledge and belief and shows the size and location of the property, its exterior boundaries, the location and dimensions of all visible structures thereon, boundary fences, apparent easements and roadways and visible encroachments, if any.
 This survey is made for the exclusive use of the present owners of the property, and also those who purchase, mortgage or guarantee title thereto, within one year from the date hereof.

Douglas G. Olson
 Wisconsin Registered Land Surveyor - 2093

HGI-5

HGI-6

416-2709

Jensen & Olson Land Surveying, LLC

45 South Wisconsin Street * P.O. Box 322 * Elkhorn, Wisconsin. 53121
 Telephone: (262) 723-3434 * Facsimile: (262) 723-8044
 Email: jensen.olson@elknet.net

- Legend**
- Found Iron Pipe
 - Found Iron Rod
 - Found Stake
 - Set Mag Nail
 - Recorded Information
 - Utility Pole
 - Manhole
 - PVC Pipe
 - Asphalt Surface
 - Brick Pavers or Patio Blocks

Sheet 1 of 1 Sheets
 Job Reference Number
2013.131

2013.131

Survey date: November 27, 2013.
 Revisions: No. 1 - Misc.
 No. 2 - Dec. No. 592993

