

West 1/4 Corner
Section 24-4-16
(N. 292,263.38)
(E. 2,385,735.26)

Plat of Survey

of

Lot 23 of Gladhurst,

a subdivision located in the Southwest 1/4 of Section 24 and
the Northwest 1/4 of Section 25, Town 4 North, Range 16
East, Town of LaGrange, Walworth County, Wisconsin.

Surveyed for: **Maurice & Carolyn Gualdron**

N8123 Rose Terrace
Elkhorn, Wisconsin. 53121

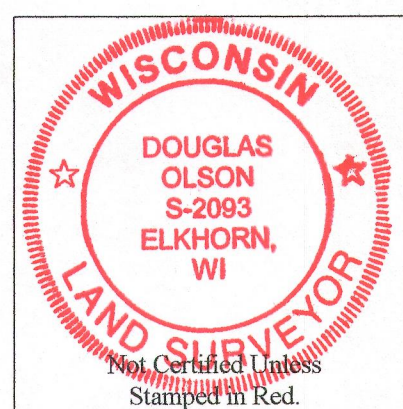

Notes:

- 1) This survey plat is not certified unless signed and sealed in red ink.
- 2) This survey is subject to Wisconsin lien laws. This Plat of Survey is the notice of intent to file lien. Lien waiver required.

(Quentin Court)
Rose Terrace

(66' Wide)

Southwest Corner
Section 24-4-16
(N. 289,621.40)
(E. 2,385,736.72)

Copyright 2013 by Jensen & Olson Land Surveying, LLC.

All rights reserved. No part of this survey plat may be reproduced or transmitted in any form by any means - graphic, electronic, or mechanical, including photocopying, tracing, or information storage and retrieval systems - without permission in writing from Douglas G. Olson, Jensen & Olson Land Surveying, LLC.

I hereby certify that I have surveyed the above described property and the map hereon is correct to the best of my professional knowledge and belief and shows the size and location of the property, its exterior boundaries, the location and dimensions of all visible structures thereon, boundary fences, apparent easements and roadways and visible encroachments, if any.

This survey is made for the exclusive use of the present owners of the property, and also those who purchase, mortgage or guarantee title thereto, within one year from the date hereof.

Douglas G. Olson
Wisconsin Registered Land Surveyor - 2093

Lot 24

Lot 23
Tax Parcel
HG 00023

1.824 Acres
79,469 Sq.Ft.

Lot 22

Lot 16 Pebble Beach

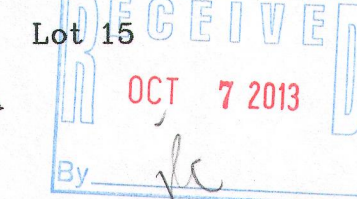

Lot 1
C.S.M. 806

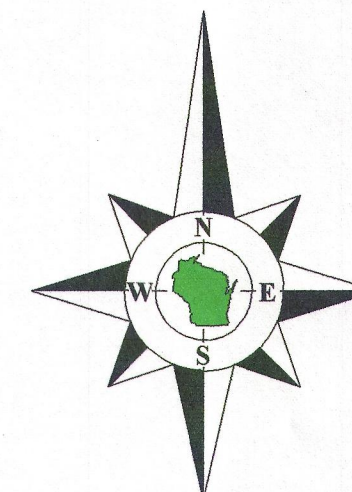

Survey Date: April 16, 2013.
Revisions:

Scale in Feet
1" = 40'
0' 20' 40' 80'

Jensen & Olson Land Surveying, LLC

45 South Wisconsin Street * P.O. Box 322 * Elkhorn, Wisconsin. 53121
Telephone: (262) 723-3434 * Facsimile: (262) 723-8044
Email: jensen.olson@elknet.net

Legend
Found County Section Corner
Found Iron Pipe
Found Iron Rod
Set Iron Pipe, 1" dia.
Recorded Information
Utility Pole
Utility Pedestal
Asphalt Surface

Sheet 1 of 1 Sheets

Job Reference Number

2013.030

2013.030

416-2669