

Plat of Survey

of
Lot 8 in Block 2 of Pebble Beach,
a subdivision located in the Northwest 1/4 of Section 25, Town 4 North,
Range 16 East, Town of LaGrange, Walworth County, Wisconsin.

Surveyed for: **Debra Curcio**
119 Saddlebrook Drive
Oakbrook, Illinois. 60521

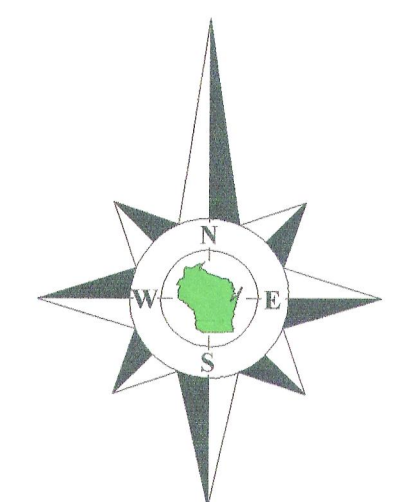

Bearings referenced to the West line of Lot 8
recorded as North on the plat of Pebble Beach.

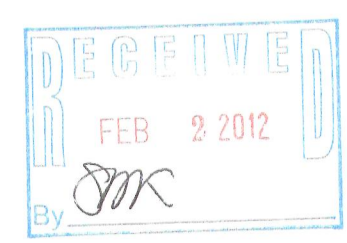

Copyright 2010 by Jensen & Olson Land Surveying, LLC.

All rights reserved. No part of this survey plat may be reproduced or transmitted in any form by any means - graphic, electronic, or mechanical, including photocopying, tracing, or information storage and retrieval systems - without permission in writing from Douglas G. Olson, Jensen & Olson Land Surveying, LLC.

I, Douglas G. Olson, Wisconsin Registered Land Surveyor, do hereby certify that this survey was performed by me, or under my direction in full compliance with the owner's/agent's instructions and Chapter A-E 7 of the Wisconsin Administrative Code "Minimum Standards for Property Surveys"; and that this map is an accurate representation thereof to the best of my knowledge and belief.

Douglas G. Olson
Wisconsin Registered Land Surveyor - 2093

- Notes:**
- 1) This survey plat is not certified unless signed and sealed in red ink.
 - 2) This survey is subject to Wisconsin lien laws. This Plat of Survey is the notice of intent to file lien. Lien waiver required.

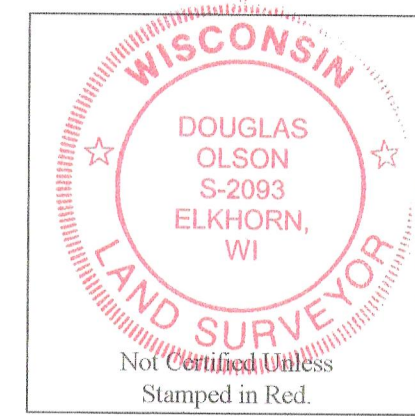

Survey Date: October 20, 2010.
Revisions: No. 1 - 1st Width @ House Addition
No. 2 - Proposed Deck
No. 3 - Proposed Deck
No. 4 - Foundation as-built

Scale in Feet
1" = 20'
0 10' 20' 40'

Jensen & Olson Land Surveying, LLC
45 South Wisconsin Street * P.O. Box 322 * Elkhorn, Wisconsin. 53121
Telephone: (262) 723-3434 * Facsimile: (262) 723-8044
Email: jensen.olson@elknet.net

Legend

- Found Concrete Monument
- Found In Pipe
- Recorded Information
- Utility Box or Pedestal
- Concrete Surface
- Asphalt Surface
- Concrete Surface
- Brick

Sheet 1 of 1 Sheets
Drawing Name: dslr16c-20101020-20101020Plat.sjg

Job Reference Number
2010.100

2010.100