

Plat of Survey

of
Part of Block 4 of Green Lake Park,
a subdivision located in the Southwest 1/4 of Section 26, Town 4 North,
Range 16 East, Town of LaGrange, Walworth County, Wisconsin.

A parcel of land described as Parcel A in a Warranty Deed recorded October 30, 1997 in Vol. 650 on Page 4782 as Document No. 367048, as shown below:

A parcel of land located in Block 4 of Green Lake Park Subdivision, which subdivision is located in the SW fractional 1/4 of Section 26, T4N, R16E, described as follows: to-wit: Commencing at the angle point in the easterly line of Lot 12 of Block 2 of said subdivision, thence South 74° 04' East 50.50 feet to a point on the Easterly line of the road; thence South 4° 30' West along the road 130.70 feet to the place of beginning; thence South 65° 17' East 160 feet to a point; thence South 4° 30' West 45 feet to a point; thence North 68° 43' West 156.84 feet to the road; thence North 4° 30' East 55 feet to the place of beginning.

Surveyed for: **Rob & Tess Densmore**
411 Tall Oaks Court
Elgin, Illinois. 60123

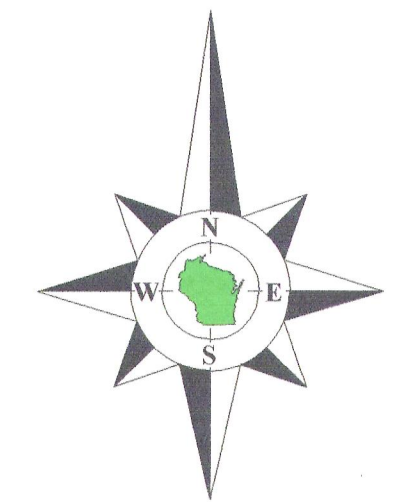

Bearings reference to the
plat of Green Lake Park.

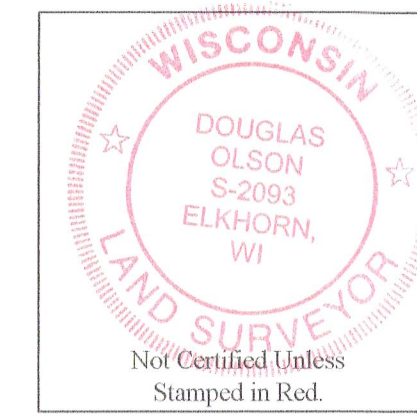

- Notes:**
- 1) This survey plat is not certified unless signed and sealed in red ink.
 - 2) This survey is subject to Wisconsin lien laws. This Plat of Survey is the notice of intent to file lien. Lien waiver required.

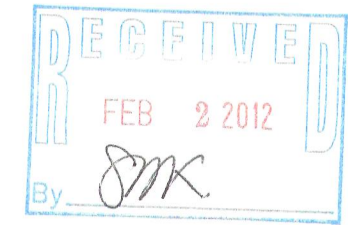

Copyright 2011 by Jensen & Olson Land Surveying, LLC.

All rights reserved. No part of this survey plat may be reproduced or transmitted in any form by any means - graphic, electronic, or mechanical, including photocopying, tracing, or information storage and retrieval systems - without permission in writing from Douglas G. Olson, Jensen & Olson Land Surveying, LLC.

I, Douglas G. Olson, Wisconsin Registered Land Surveyor, do hereby certify that this survey was performed by me, or under my direction in full compliance with the owner's/agent's instructions and Chapter A-E 7 of the Wisconsin Administrative Code "Minimum Standards for Property Surveys"; and that this map is an accurate representation thereof to the best of my knowledge and belief.

Douglas G. Olson
Wisconsin Registered Land Surveyor - 2093

Survey Date: September 2, 2011.
Revisions:

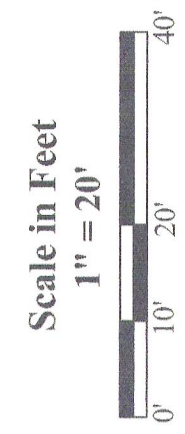

Jensen & Olson Land Surveying, LLC
45 South Wisconsin Street * P.O. Box 322 * Elkhorn, Wisconsin. 53121
Telephone: (262) 723-3434 * Facsimile: (262) 723-8044
Email: jensen.olson@elknet.net

- Legend**
- Found Iron Pipe
 - Found Iron Rod
 - Found Mag Nail
 - Recorded Information
 - Utility Pole
 - Concrete Cover
 - Asphalt Surface
 - Concrete Surface
 - Gravel

Sheet 1 of 1 Sheets
Drawing Name: d:\ar\6-2011\097\Plat.sg
Job Reference Number
2011.097

2011.097

HGP-34

416-2574