

Plat of Survey

of

Lots 20 and 21 of Bubbling Springs Subdivision,

located in the Southeast 1/4 of Section 34, Town 4 North, Range 16 East, Town of LaGrange, Walworth County, Wisconsin.

Surveyed for:

Ed Bole

711 Burr Oak Lane
Island Lakes, Illinois, 60042

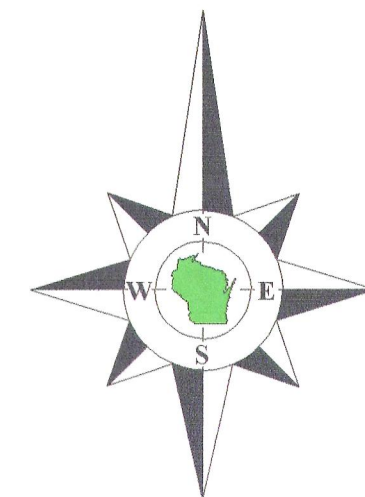

Bearings reference to the plat of
Bubbling Springs Subdivision.

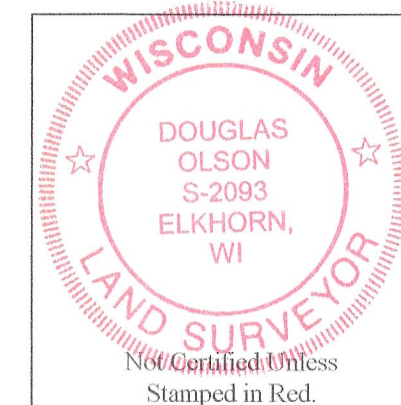

Notes:

- 1) This survey plat is not certified unless signed and sealed in red ink.
- 2) This survey is subject to Wisconsin lien laws. This Plat of Survey is the notice of intent to file lien. Lien waiver required.

Copyright 2011 by Jensen & Olson Land Surveying, LLC.

All rights reserved. No part of this survey plat may be reproduced or transmitted in any form by any means - graphic, electronic, or mechanical, including photocopying, tracing, or information storage and retrieval systems - without permission in writing from Douglas G. Olson, Jensen & Olson Land Surveying, LLC.

I, Douglas G. Olson, Wisconsin Registered Land Surveyor, do hereby certify that this survey was performed by me, or under my direction in full compliance with the owner's/agent's instructions and Chapter A-E 7 of the Wisconsin Administrative Code "Minimum Standards for Property Surveys", and that this map is an accurate representation thereof to the best of my knowledge and belief.

Douglas G. Olson
Wisconsin Registered Land Surveyor - 2093

Survey Date: July 1, 2011.
Revisions:

Scale in Feet
1" = 20'
0' 10' 20' 40'

Jensen & Olson Land Surveying, LLC

45 South Wisconsin Street * P.O. Box 322 * Elkhorn, Wisconsin, 53121
Telephone: (262) 723-3434 * Facsimile: (262) 723-8044
Email: jensen.olson@elknet.net

Legend
Found Iron Pipe
Found Iron Rod
Recorded Information
Utility Pedestal
Concrete Cover
Asphalt Surface
Concrete Surface
Gravel

Sheet 1 of 1 Sheets
Drawing Name: 444-160-2011-044-2011-044-Plat.sxd
Job Reference Number
2011.044

2011.044

HBS-20 HBS-21

416-2573