

Mill

Lake

Plat of Survey

of

Lot 1 of Certified Survey Map No. 4379,

recorded in Vol. 28 of Certified Survey Maps of Walworth County on Page 203 and located in the Northwest 1/4 of Section 36, Town 4 North, Range 16 East, Town of LaGrange, Walworth County, Wisconsin.

Surveyed for: **Sandra Hamilton**
21727 Sound Way #101
Estero, Florida. 33928

North 1/4 Corner
Section 36-4-16.
N. 284.423.24
E. 2,388,292.64

Center 1/4 Corner
Section 36-4-16.
N. 281,787.39
E. 2,388,358.92

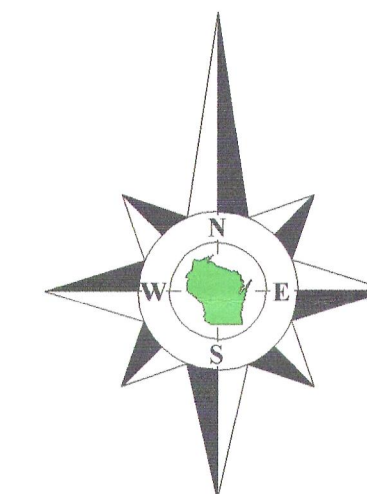

Bearings reference to the Wisconsin State Plane Coordinate System, South Zone.

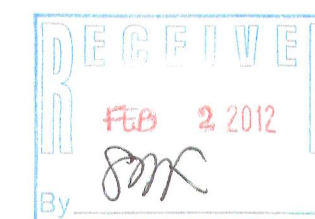

Elevations on this survey are referenced to a recorded elevation of 886.959 on Benchmark FX-P-9, a chiselled + on the Southwest wingwall of the Honey Creek dam. This elevation is referenced to the National Geodetic Vertical Datum of 1929 (NGVD29).

The flood elevation information shown on this survey is referenced to Flood Insurance Rate Map (FIRM) No. 55127C0065D and the Flood Insurance Study (FIS) report dated October 2, 2009 prepared by the Federal Emergency Management Agency (FEMA). These publications were prepared using the North American Vertical Datum of 1988 (NAVD88). Page 18 of the Flood Insurance Study gives the following conversion factor for Walworth County, NAVD88 + 0.2 feet = NGVD29.

A 100 year flood elevation of 886.2 NGVD29 was used on this survey based upon an elevation of 886 NAVD88 on the above mentioned FIRM and FIS.

Copyright 2011 by Jensen & Olson Land Surveying, LLC.

All rights reserved. No part of this survey plat may be reproduced or transmitted in any form by any means - graphic, electronic, or mechanical, including photocopying, tracing, or information storage and retrieval systems - without permission in writing from Douglas G. Olson, Jensen & Olson Land Surveying, LLC.

I, Douglas G. Olson, Wisconsin Registered Land Surveyor, do hereby certify that this survey was performed by me, or under my direction in full compliance with the owner's/agent's instructions and Chapter A-E 7 of the Wisconsin Administrative Code "Minimum Standards for Property Surveys"; and that this map is an accurate representation thereof to the best of my knowledge and belief.

Douglas G. Olson
Wisconsin Registered Land Surveyor - 2093

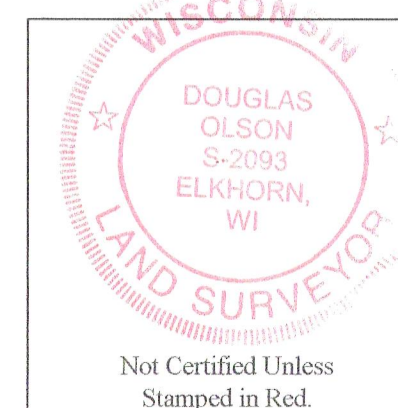

Notes:

- This survey plat is not certified unless signed and sealed in red ink.
- This survey is subject to Wisconsin lien laws. This Plat of Survey is the notice of intent to file lien. Lien waiver required.

No. 6 - Changed shoreyard setback, proposed addition, and proposed retaining wall & stoop.
No. 7 - Retaining Wall & Stoop

Survey Date: July 13, 2011.
Revisions: No. 1 - Proposed Lot Line Adjustments, Proposed Stoop, & Proposed Retaining Wall & Stoop.
No. 2 - Proposed Retaining Wall & Stoop.
No. 3 - Building Setback Lines.
No. 4 - Proposed Addition.
No. 5 - CSM recording info.
--- Continued above ---

Scale in Feet
1" = 20'



Jensen & Olson Land Surveying, LLC
45 South Wisconsin Street * P.O. Box 322 * Elkhorn, Wisconsin. 53121
Telephone: (262) 723-3434 * Facsimile: (262) 723-8044
Email: jensen.olson@elknet.net

Legend
Found County Section Corner
Found Iron Pipe
Found Iron Rod
Found Iron Stake
Found Iron Nail
Found Iron Bolt
Found Iron Screw
Found Iron Nut
Found Iron Washer
Found Iron Bracket
Found Iron Plate
Found Iron Band
Found Iron Chain
Found Iron Link
Found Iron Ring
Found Iron Ball
Found Iron Tube
Found Iron Pipe
Found Iron Rod
Found Iron Stake
Found Iron Nail
Found Iron Bolt
Found Iron Screw
Found Iron Nut
Found Iron Washer
Found Iron Bracket
Found Iron Plate
Found Iron Band
Found Iron Chain
Found Iron Link
Found Iron Ring
Found Iron Ball
Found Iron Tube

Sheet 1 of 1 Sheets
Drawing Name: HA4379-1 (6-2011) 1063-2011063 Plat (S)
Job Reference Number
2011.063
2011.063

HA4379-1

416-2570