

of
Lot 3 of Certified Survey Map No. 459,

recorded in Vol. 2 of Certified Survey Maps of Walworth County on Page 265 and located in the Southwest 1/4 of Section 36, Town 4 North, Range 16 East, Town of LaGrange, Walworth County, Wisconsin.

Surveyed for: **Keefe Real Estate, Inc.**
1040 North Wisconsin Street
Elkhorn, Wisconsin. 53121

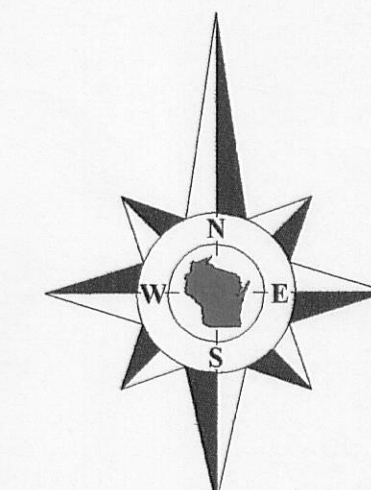

Bearings referenced to Certified
Survey Map No. 459

Note:
Building setback lines shown based upon
information provided by the Walworth
County Zoning office on May 9, 2011.

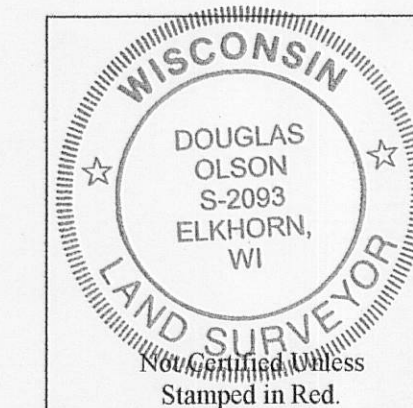

Notes:

- 1) This survey plat is not certified unless signed and sealed in red ink.
- 2) This survey is subject to Wisconsin lien laws. This Plat of Survey is the notice of intent to file lien. Lien waiver required.

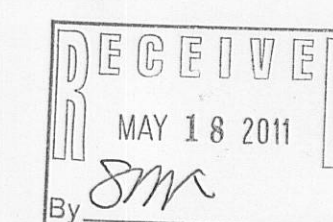

Copyright 2011 by Jensen & Olson Land Surveying, LLC.

All rights reserved. No part of this survey plat may be reproduced or transmitted in any form by any means - graphic, electronic, or mechanical, including photocopying, tracing, or information storage and retrieval systems - without permission in writing from Douglas G. Olson, Jensen & Olson Land Surveying, LLC.

I hereby certify that I have surveyed the above described property and the map hereon is correct to the best of my professional knowledge and belief and shows the size and location of the property, its exterior boundaries, the location and dimensions of all visible structures thereon, boundary fences, apparent easements and roadways and visible obstructions, if any.

This survey is made for the exclusive use of the present owners of the property, and also those who purchase, mortgage or guarantee title thereto, within one year from the date hereof.

Douglas G. Olson
Wisconsin Registered Land Surveyor - 2093

Survey date: May 7, 2011.
Revisions:

Scale in Feet
1" = 20'

Jensen & Olson Land Surveying, LLC

Legend

Sheet 1 of 1 Sheets

2011.035