

Plat of Survey

of

Unit 78 of Lauderdale Shores A Recreational Vehicle Condominium,

located in the Northwest 1/4 of Section 25, Town 4 North, Range
16 East, Town of LaGrange, Walworth County, Wisconsin.

Surveyed for: **Charles A. Schultz**
4016 South 58th Street
Milwaukee, Wisconsin. 53220

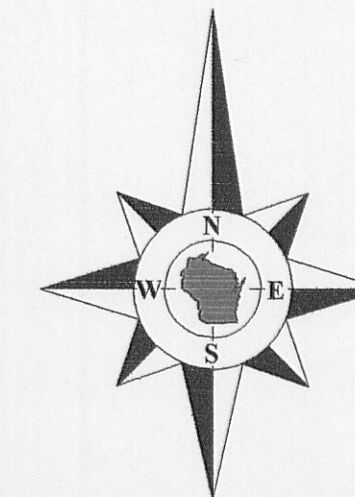

Bearings reference to the plat of
Lauderdale Shores A Recreational
Vehicle Condominium.

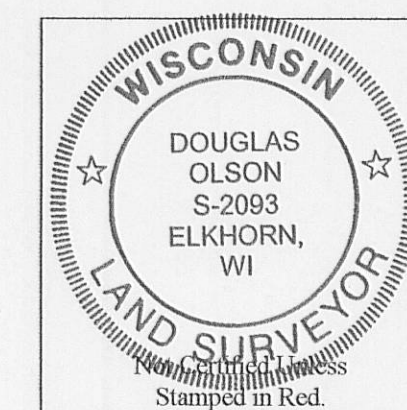

Notes:

- 1) This survey plat is not certified unless signed and sealed in red ink.
- 2) This survey is subject to Wisconsin lien laws. This Plat of Survey is the notice of intent to file lien. Lien waiver required.

Copyright 2009 by Jensen & Olson Land Surveying, LLC.

All rights reserved. No part of this survey plat may be reproduced or transmitted in any form by any means - graphic, electronic, or mechanical, including photocopying, tracing, or information storage and retrieval systems - without permission in writing from Douglas G. Olson, Jensen & Olson Land Surveying, LLC.

I, Douglas G. Olson, Wisconsin Registered Land Surveyor, do hereby certify that this survey was performed by me, or under my direction in full compliance with the owner's/agent's instructions and Chapter A-E 7 of the Wisconsin Administrative Code "Minimum Standards for Property Surveys"; and that this map is an accurate representation thereof to the best of my knowledge and belief.

Douglas G. Olson
Wisconsin Registered Land Surveyor - 2093

Survey Date: November 19, 2009.
Revisions:

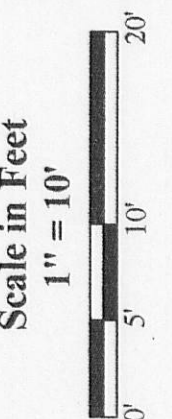

Jensen & Olson Land Surveying, LLC
45 South Wisconsin Street * P.O. Box 322 * Elkhorn, Wisconsin. 53121
Telephone: (262) 723-3434 * Facsimile: (262) 723-8044
Email: jensen.olson@elknet.net

Legend
● Found Iron Rod
● Found Railroad Spike
● Found Information
● Utility Box or Pedestal
○ PVC Pipe
○ Asphalt Surface
○ Concrete Surface
○ Gravel Surface
○ Water Spigot
○ Light

Sheet 1 of 1 Sheets
Drawing Name: 14416-201005-201005Plat.sxd
Job Reference Number
2010.005
2010.005