

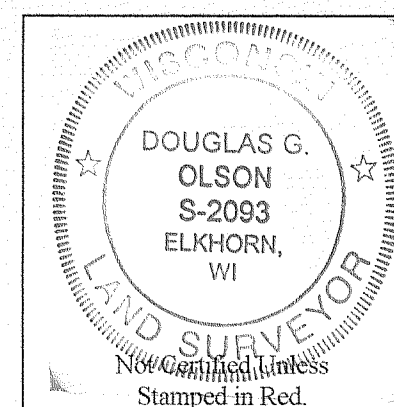

## of

located in the Southwest 1/4 of Section 35, Town 4 North, Range 16 East, Town of LaGrange, Walworth County, Wisconsin.

Surveyed for:

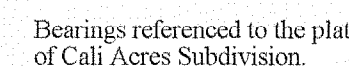

- 1) This survey plat is not certified unless signed and sealed in red ink.
- 2) This survey is subject to Wisconsin lien laws. This Plat of Survey is the notice of intent to file lien. Lien waiver required.

All rights reserved. No part of this survey plat may be reproduced or transmitted in any form by any means - graphic, electronic, or mechanical, including photocopying, tracing, or information storage and retrieval systems - without permission in writing from Douglas G. Olson, Jensen & Olson Land Surveying, LLC.

This survey is made for the exclusive use of the present owners of the property, and also those who purchase, mortgage or guarantee title thereto, within one year from the date hereof.

1

**Scale in Feet**  
**1" = 20'**

A horizontal scale bar with a black and white alternating pattern. It is marked with '0', '10'', '20'', and '40'' from left to right.

**Sheet 1 of 1 Sheets**

**Job Reference Number**  
**2009.073**

416-2415