

PLAT OF SURVEY
LOT 22 OF CALI ACRES SUBDIVISION
LOCATED IN THE SW 1/4 OF THE SW 1/4 OF SECTION 35,
TOWN 4 NORTH, RANGE 16 EAST, WALWORTH COUNTY, WISCONSIN

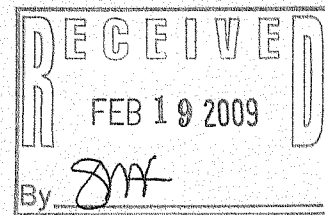

LOT 2 C.S.M. 4043

N 56°15'36" E 360.10'
N 56°13'18" E 359.98'

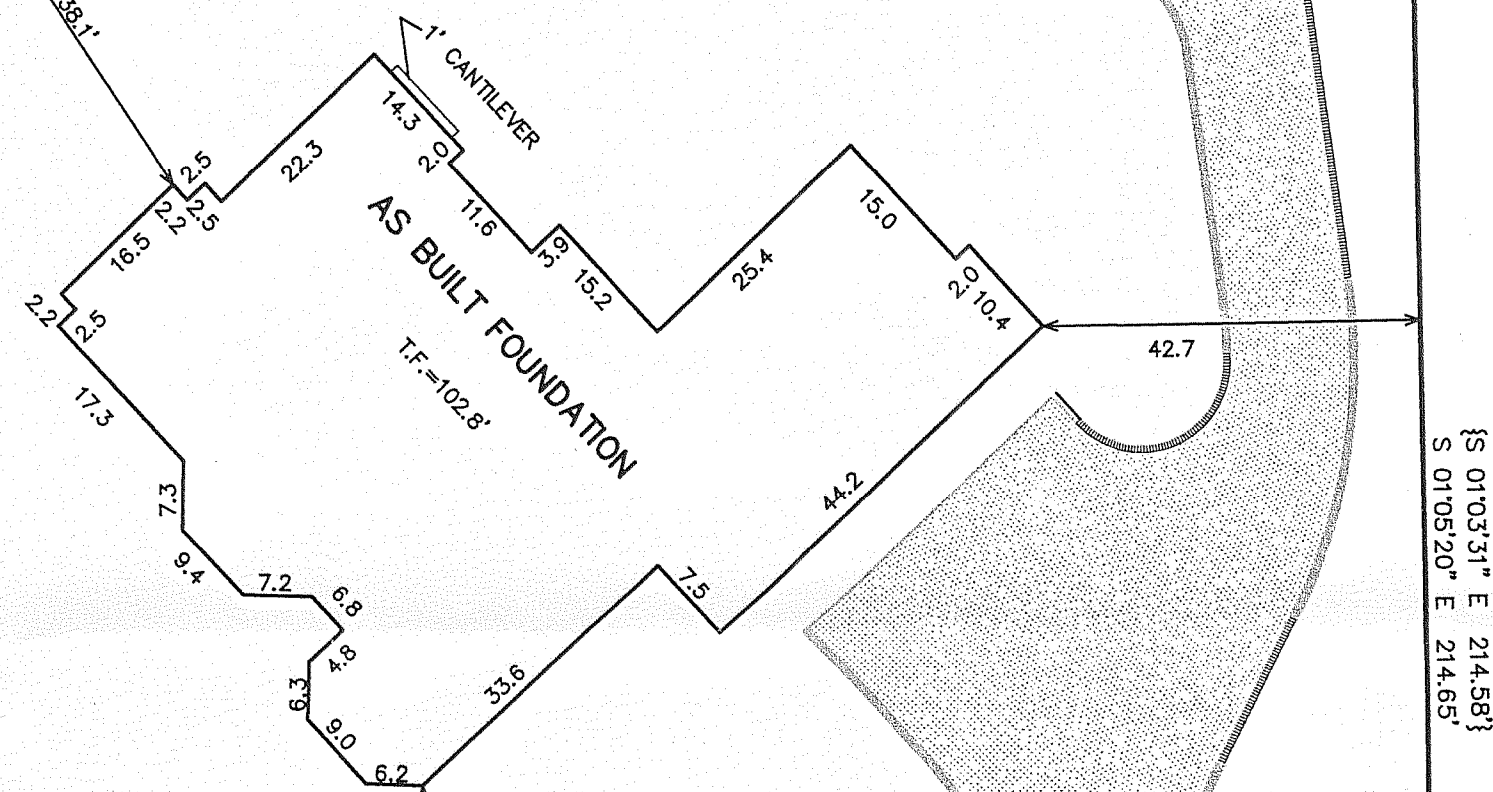

{S 01°03'31" E 214.58'}
{S 01°05'20" E 214.65'}

SEPTIC VENT



LOT 1
C.S.M.
4043

WIRE FENCE

N 22°03'00" W 100.00'
N 22°03'00" W 100.00'
N 22°03'00" W 100.00'

LOT 12 OF
BLOCK 8 OF
COOL HILL PARK
ADDITION NO. 1

BENCH MARK
RAILROAD SPIKE
IN FENCE POST
ELEV.=91.14'

— OWNER —
LUKE BURMEISTER

LEGEND

- = FOUND IRON PIPE STAKE
- = FOUND IRON REBAR STAKE
- {XXX} = RECORDED AS
- XXX--- = EXISTING LAND CONTOURS
- XXX— = PROPOSED LAND CONTOURS
- F.F. = FIRST FLOOR GRADE
- T.F. = TOP OF FOUNDATION GRADE
- L.O. = LOOK-OUT BASEMENT GRADE
- G.E. = GARAGE ENTRY GRADE
- BASE = BASEMENT GRADE

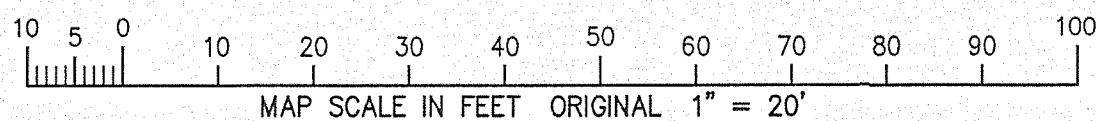

NOTE: COPIES OF THIS MAP TO WHICH THE FOLLOWING CERTIFICATE WILL APPLY SHOW THE SURVEYOR'S ORIGINAL SEAL AND SIGNATURE IN RED INK. COPIES BY ANY OTHER MEANS MAY HAVE ALTERATIONS WHICH DO NOT REPRESENT THE SURVEYOR'S WORK PRODUCT.

I HEREBY CERTIFY THAT THE ABOVE DESCRIBED PROPERTY HAS BEEN SURVEYED UNDER MY DIRECTION AND THAT THE ABOVE MAP IS A TRUE REPRESENTATION THEREOF AND SHOWS THE SIZE AND LOCATION OF THE PROPERTY AND ITS EXTERIOR BOUNDARIES. THIS SURVEY IS MADE FOR THE USE OF THE PRESENT OWNERS OF THE PROPERTY, AND ALSO THOSE WHO PURCHASE, MORTGAGE, OR GUARANTEE THE TITLE THERETO WITHIN ONE YEAR FROM THE DATE HEREOF.

DATED: 7/14/2008

REVISED 01-13-2009
TO SHOW SIZE & LOCATION OF
AS BUILT FOUNDATION

PETER S. GORDON R.L.S. 2101

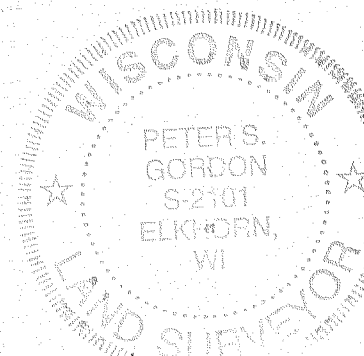

PLAT OF SURVEY

TOWN OF LA GRANGE, WALWORTH COUNTY, WISCONSIN

— WORK ORDERED BY —
J. TIMOTHY BUILDERS
W4732 PEBBLE DRIVE
ELKHORN, WI 53121

FARRIS, HANSEN & ASSOCIATES, INC.
ENGINEERING — ARCHITECTURE — SURVEYING
7 RIDGWAY COURT P.O. BOX 437
ELKHORN, WISCONSIN 53121
OFFICE: (262) 723-2098 FAX: (262) 723-5886

REVISIONS

7/16/2008-KB
SITE, GRADING,
DRAINAGE, &
EROSION
CONTROL PLAN
8/18/2008-KB
REVISED PRO.
RES. GRADES

PROJECT NO.
7678

DATE:
07/14/2008

SHEET NO.
1 OF 1

HC-22

416-2386