

Plat of Survey

of

A Proposed Abandonment of a portion of Lake Road lying West of Lot 9 of Block 2 of Cooper's Mid-Lakes Subdivision,

located in the Northwest 1/4 of Section 35, Town 4 North, Range 16 East, Town of LaGrange, Walworth County, Wisconsin.

Legal Description of Proposed Abandonment

Part of Lake Road lying between Block 2 and Block 3 of Cooper's Mid-Lakes Subdivision, located in the Northwest 1/4 of Section 35, Town 4 North, Range 16 East, Town of LaGrange, Walworth County, Wisconsin, more particularly described as follows: Begin at an iron pipe at the Northwest Corner of Lot 9 of said Block 2; thence South 0°00'54" East, along the West line of said Lot 9, 135.30 feet; thence North 48°00'00" West 20.57 feet; thence North 0°03'14" East 120.00 feet to a point on the South line of Forest Road; thence North 84°12'00" East, along said South line, 15.22 feet to the Point of Beginning. Said parcel contains 0.045 acre (1,943 sq.ft.) of land, more or less.

Surveyed for: **William Scherschel**

1956 Somerset Lane
Wheaton, Illinois. 60187

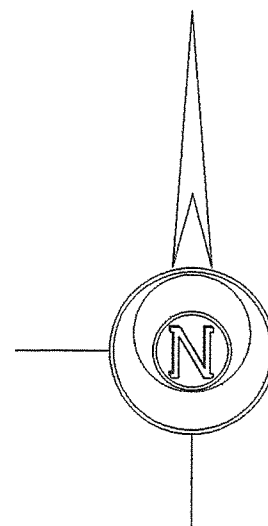

Bearings referenced to previous surveys.

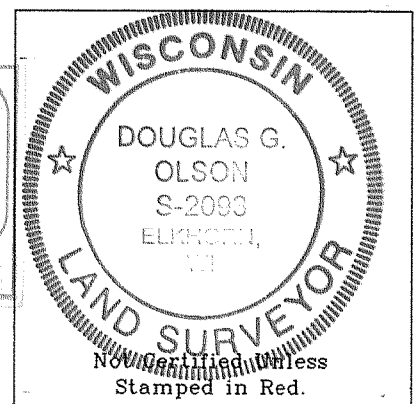
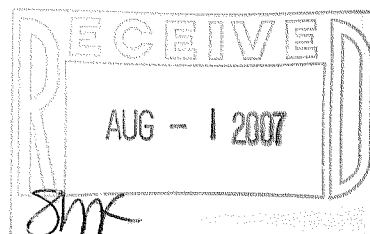

Notes: 1) This survey plat is not certified unless signed and sealed in red ink.

2) This survey is subject to Wisconsin lien laws. This Plat of Survey is the notice of intent to file lien. Lien waiver required.

I hereby certify that I have surveyed the above described property and the map hereon is correct to the best of my professional knowledge and belief and shows the size and location of the property, its exterior boundaries, the location and dimensions of all visible structures thereon, boundary fences, apparent easements and roadways and visible encroachments, if any.
This survey is made for the exclusive use of the present owners of property, and also those who purchase, mortgage or guarantee title thereto, within one year from the date hereof.

Douglas G. Olson
Wisconsin Registered Land Surveyor - 2093

Proposed Abandonment

0.045 Acre
1,943 Sq.Ft.

House
W5705

Proposed Deck

Tax Parcel
HCO 00010A

0.261 Acre
11,371 Sq.Ft.

Lot 9

Block 2

Lot 8

2

See Note Below

Vacated
Lake Road

This portion of Lake Road is shown as vacated by Circuit Court in a document recorded in Vol. 672 on Page 5872 as Document No. 448044.

Note: This vacation appears to have been nullified as documented in a Court of Appeals decision dated and filed on January 19, 2005.

S86°54'00"W 65.02'

44.66'

15.41'

49.81'

Timber

Shed

Wood Walk

Middle Lake

Pier

Legend

- Found Iron Pipe
- Found Iron Rod
- Recorded Information
- Concrete Cover
- Utility Pole
- Pedestal
- Septic Vent
- Asphalt Surface
- Brick Surface
- Gravel Surface

Jensen & Olson Land Surveying, LLC

45 South Wisconsin Street P.O. Box 322
Elkhorn, Wisconsin. 53121
Telephone: (262) 723-3434
Facsimile: (262) 723-8044

Scale: 1" = 20'

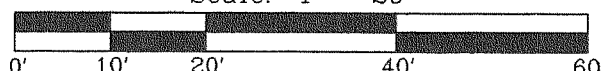

Survey date: August 16, 2006.

Revisions: No. 1 - Vacation Nullified
No. 2 - Proposed Abandonment

Sheet 1 of 1 Sheets.

Job Reference Number:

416-22932006.094

HCO-10A