

PREPARED FOR:  
JIM RADECKI  
P.O. BOX 24  
MARENGO IL  
60152

# PLAT OF SURVEY

- OF -

LOT 1 OF DON JEAN ESTATES A SUBDIVISION LOCATED IN THE SOUTHWEST  
1/4 OF THE SOUTHEAST 1/4 OF SECTION 36, TOWN 4 NORTH, RANGE 16 EAST,  
TOWN OF LAGRANGE, WALWORTH COUNTY, WISCONSIN.

**AFFIDAVIT OF CORRECTION FOR SURVEY FILED AT THE WALWORTH  
COUNTY SURVEYORS OFFICE ON 2/20/2003 AS SURVEY NO. 416-1868**

J.K. SURVEYING INC.  
N3705 WILLOWBEND LANE  
LAKE GENEVA, WI, 53147  
262-248-3697

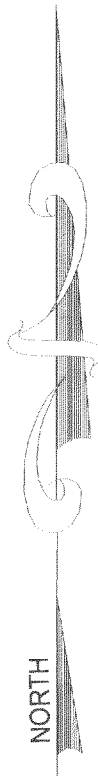

SCALE 1" = 40'

COMPARE LEGAL DESCRIPTION ABOVE AND DRAWING WITH DEED. FOR BUILDING RESTRICTIONS AND  
EASEMENTS NOT SHOWN REFER TO DEED, ABSTRACT SOURCES AND LOCAL MUNICIPAL CODES. NOTIFY  
THE SURVEYOR IMMEDIATELY OF ANY DISCREPANCY.

"I hereby certify that I have surveyed the above described property and that  
the above map is a true representation thereof and shows the size and  
location of all visible structures, apparent easements and encroachments  
if any."  
This survey is made for the present owners of the property, and those who  
purchase, mortgage, or guarantee the title thereto, within one year from  
the date hereof.

DATED THIS 9TH, DAY OF MAY, 2003

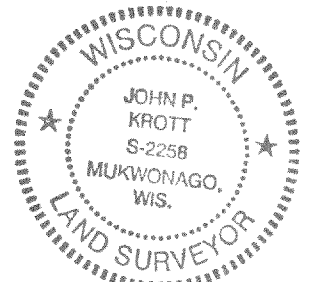
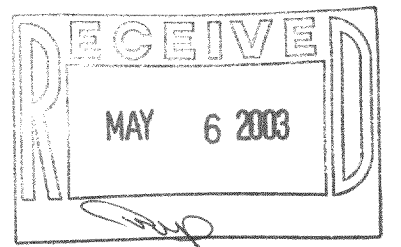

*John P. Krott*

JOHN KROTT S - 2258  
Wisconsin Registered Land Surveyor  
(original if signed in red)

SOUTHEAST CORNER OF  
DON JEAN ESTATES  
SOUTHEAST CORNER OF  
C.S.M. 1996

- ( ) = recorded as
- = found iron bar
- = found iron pipe
- = set iron pipe
- = set iron bar

SCALE 1" = 40'

JOB # 03-071z

TAX ID # HDJ00001

CENTER SEC. 36-4-16

N 0°46'56" E

1304.52'

S 89°13'04" E  
50.99'

NOTE: THIS LINE DOES NOT APPEAR TO  
BE THE ORIGINAL WEST LINE OF  
DON JEAN ESTATES.  
WI. D.O.T. MONUMENT

S 1°15'42" W  
125.98'

N 0°46'56" E  
192.19'

S 89°13'04" E  
49.93'

SET P.K. NAIL.

S 89°13'04" E  
32.83'

L=123.90'

R=97.00' L=123.90'

S 52°39'09" E  
115.65'

S 30°13'14" E  
109.50'

S 30°13'14" E  
109.50'

S 30°13'14" E  
109.50'

S 30°13'14" E  
109.50'

S 30°13'14" E  
109.50'

S 30°13'14" E  
109.50'

S 30°13'14" E  
109.50'

S 30°13'14" E  
109.50'

S 30°13'14" E  
109.50'

S 30°13'14" E  
109.50'

S 30°13'14" E  
109.50'

S 30°13'14" E  
109.50'

S 30°13'14" E  
109.50'

S 30°13'14" E  
109.50'

S 30°13'14" E  
109.50'

S 30°13'14" E  
109.50'

S 30°13'14" E  
109.50'

S 30°13'14" E  
109.50'

S 30°13'14" E  
109.50'

S 30°13'14" E  
109.50'

S 30°13'14" E  
109.50'

S 30°13'14" E  
109.50'

S 30°13'14" E  
109.50'

S 30°13'14" E  
109.50'

S 30°13'14" E  
109.50'

S 30°13'14" E  
109.50'

S 30°13'14" E  
109.50'

S 30°13'14" E  
109.50'

S 30°13'14" E  
109.50'

S 30°13'14" E  
109.50'

S 30°13'14" E  
109.50'

S 30°13'14" E  
109.50'

S 30°13'14" E  
109.50'

S 30°13'14" E  
109.50'

S 30°13'14" E  
109.50'

S 30°13'14" E  
109.50'

S 30°13'14" E  
109.50'

S 30°13'14" E  
109.50'

S 30°13'14" E  
109.50'

S 30°13'14" E  
109.50'

S 30°13'14" E  
109.50'

S 30°13'14" E  
109.50'

S 30°13'14" E  
109.50'

S 30°13'14" E  
109.50'

S 30°13'14" E  
109.50'

S 30°13'14" E  
109.50'

S 30°13'14" E  
109.50'

S 30°13'14" E  
109.50'

S 30°13'14" E  
109.50'

S 30°13'14" E  
109.50'

S 30°13'14" E  
109.50'

S 30°13'14" E  
109.50'

S 30°13'14" E  
109.50'

S 30°13'14" E  
109.50'

S 30°13'14" E  
109.50'

S 30°13'14" E  
109.50'

S 30°13'14" E  
109.50'

S 30°13'14" E  
109.50'

S 30°13'14" E  
109.50'

S 30°13'14" E  
109.50'

S 30°13'14" E  
109.50'

S 30°13'14" E  
109.50'

S 30°13'14" E  
109.50'

S 30°13'14" E  
109.50'

S 30°13'14" E  
109.50'

S 30°13'14" E  
109.50'

S 30°13'14" E  
109.50'

S 30°13'14" E  
109.50'

S 30°13'14" E  
109.50'

S 30°13'14" E  
109.50'

S 30°13'14" E  
109.50'

S 30°13'14" E  
109.50'

LOT 1

75' BUILDING SET BACK LINE

GRAVEL DRIVE

PROPOSED HOUSE

PROPOSED PORCH

24.00'

24.00'

24.00'

24.00'

24.00'

24.00'

24.00'

24.00'

24.00'

24.00'

24.00'

24.00'

24.00'

24.00'

24.00'

24.00'

24.00'

24.00'

24.00'

24.00'

24.00'

24.00'

24.00'

24.00'

24.00'

24.00'

24.00'

24.00'

24.00'

24.00'

24.00'

24.00'

24.00'

24.00'

24.00'

24.00'

24.00'

24.00'

24.00'

24.00'

24.00'

24.00'

24.00'

24.00'

24.00'

24.00'

24.00'

24.00'

24.00'

24.00'

24.00'

24.00'

24.00'

SOUTH 1/4 CORNER  
SEC. 36-4-16

LOT 2

LOT 3

274.01'

( N 89°50'50" E 287.00' )

S 89°50'50" W

682.00'

342.07'

( 342.00' )

52.94'

24.85'

207.24'

( S 46°11'42" E 207.13' )

S 46°11'42" E

99.88'

( CHD. N 72°36'35" E 99.99' )

( CHD. N 72°44'12.5" E 99.99' )

R=136.00' L=102.28'

N 85°08'20" W 70.00'

R=225.14'

( N 02°26'20" E 121.26' )

( N 02°26'20" E 121.26' )

( N 02°26'20" E 121.26' )

( N 02°26'20" E 121.26' )

( N 02°26'20" E 121.26' )

( N 02°26'20" E 121.26' )

( N 02°26'20" E 121.26' )

( N 02°26'20" E 121.26' )

( N 02°26'20" E 121.26' )

( N 02°26'20" E 121.26' )

( N 02°26'20" E 121.26' )

( N 02°26'20" E 121.26' )

( N 02°26'20" E 121.26' )

( N 02°26'20" E 121.26' )

( N 02°26'20" E 121.26' )

( N 02°26'20" E 121.26' )

( N 02°26'20" E 121.26' )

( N 02°26'20" E 121.26' )

RIGHT-OF-WAY ACCORDING TO THE  
PLAT OF DON JEAN ESTATES &  
WI. DOT PROJECT NO. 3120-00-20  
DATED FEB, 6, 1995

PLATTED AS BAY VIEW DRIVE

( N 62°16'14" E 139.82' )

( N 62°14'09" E 139.81' )

( N 62°14'09" E 139.81' )

( N 62°14'09" E 139.81' )

( N 62°14'09" E 139.81' )

( N 62°14'09" E 139.81' )

( N 62°14'09" E 139.81' )

( N 62°14'09" E 139.81' )

( N 62°14'09" E 139.81' )

( N 62°14'09" E 139.81' )

( N 62°14'09" E 139.81' )

( N 62°14'09" E 139.81' )

( N 62°14'09" E 139.81' )

( N 62°14'09" E 139.81' )

( N 62°14'09" E 139.81' )

( N 62°14'09" E 139.81' )

( N 62°14'09" E 139.81' )

( N 62°14'09" E 139.81' )

( N 62°14'09" E 139.81' )

( N 62°14'09" E 139.81' )

( N 62°14'09" E 139.81' )

( N 62°14'09" E 139.81' )

( N 62°14'09" E 139.81' )

( N 62°14'09" E 139.81' )

( N 62°14'09" E 139.81' )

( N 62°14'09" E 139.81' )

( N 62°14'09" E 139.81' )

( N 62°14'09" E 139.81' )

( N 62°14'09" E 139.81' )

( N 62°14'09" E 139.81' )

( N 62°14'09" E 139.81' )

( N 62°14'09" E 139.81' )

( N 62°14'09" E 139.81' )

( N 62°14'09" E 139.81' )

( N 62°14'09" E 139.81' )

( N 62°14'09" E 139.81' )

( N 62°14'09" E 139.81' )

( N 62°14'09" E 139.81' )

( N 62°14'09" E 139.81' )

( N 62°14'09" E 139.81' )

( N 62°14'09" E 139.81' )

( N 62°14'09" E 139.81' )

( N 62°14'09" E 139.81' )

( N 62°14'09" E 139.81' )

( N 62°14'09" E 139.81' )