

ABERNATHY and ASSOCIATES

Kenneth B. Abernathy Jr.

Wisconsin Registered Land Surveyor S-1594

W4056 BRAY RD.  
ELKHORN, WI. 53121  
PHONE: (262) 723-4260 (OFFICE)  
(262) 723-7209 (FAX)  
Email: abernathy@elknet.net

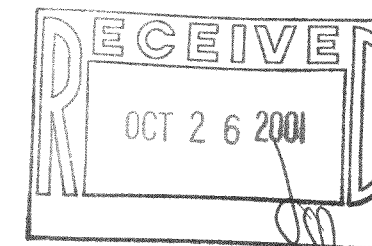

PLAT OF SURVEY

LOT 5 OF BLOCK 1 OF BAY VIEW  
MANOR SUBDIVISION, LOCATED IN  
SECTION 26, TOWN 4 NORTH, RANGE  
16 EAST, TOWN OF LAGRANGE,  
WALWORTH COUNTY, WISCONSIN.

ORDERED BY: SCHAUDER BUILDING, INC.  
4115 HIGHWAY 51 NORTH  
JANESVILLE, WISCONSIN  
53545-9674

CLIENT REFERENCE: WOJCIK

- NOTES
1. WOOD STAKES HAVE BEEN PLACED AT BUILDING CORNERS. BUILDER IS TO VERIFY DIMENSIONS WHICH HAVE BEEN ROUNDED TO THE NEAREST TENTH OF A FOOT TO INSURE PROPER PLAN INTERPRETATION AND CONTACT THIS OFFICE IMMEDIATELY IF ANY DISCREPANCY EXISTS.
  2. LOT WIDTH PARALLEL WITH THE RIGHT-OF-WAY AT THE FRONT OF THE RESIDENCE = 65 FEET. 16% OF THIS DIMENSION = 10.4' WHICH IS THE MINIMUM SIDEYARD SETBACK.

100 YEAR FLOOD ELEV. = 886.00'  
LAKE ELEV. = 884.60' ON 6/29/01

MILL LAKE  
STERLINGWORTH BAY

Legend

- FOUND IRON PIPE
- FOUND IRON ROD
- FOUND BRASS CAPPED MONUMENT
- FOUND CONCRETE MONUMENT
- CHISEL CUT IN CONCRETE
- SET IRON ROD, 24" LONG, WEIGHING 1.5 LBS./LINEAL FT., 3/4" DIA.
- SET IRON ROD, 30" LONG, WEIGHING 4.5 LBS./LINEAL FT., 1-11/16" DIA.
- RECORDED AS DIMENSION
- EXISTING FENCE



SCALE: 1" = 30 FEET

"I hereby certify that the above described property has been surveyed by me or under my direction and that the above map is a true representation thereof and shows the size and location of the property, its exterior boundaries, the location of all visible structures and dimensions of all principal buildings thereon, boundary fences, apparent easements, roadways and visible encroachments, if any."  
"This survey is made for the use of the present owners of the property, and also those who purchase, mortgage, or guarantee the title thereto within one year from date hereof."

*Kenneth B. Abernathy, Jr.*  
KENNETH B. ABERNATHY, JR.  
WISCONSIN REGISTERED LAND SURVEYOR,  
S-1594

Date: AUGUST 6, 2001 Job No. 01-604

ABERNATHY and ASSOCIATES

Kenneth B. Abernathy Jr.

Wisconsin Registered Land Surveyor S-1594

W4056 BRAY RD.  
ELKHORN, WI. 53121  
PHONE: (262) 723-4260 (OFFICE)  
(262) 723-7209 (FAX)  
Email: abernathy@elknet.net

PLAT OF SURVEY

LOT 5 OF BLOCK 1 OF BAY VIEW  
MANOR SUBDIVISION, LOCATED IN  
SECTION 26, TOWN 4 NORTH, RANGE  
16 EAST, TOWN OF LAGRANGE,  
WALWORTH COUNTY, WISCONSIN.

ORDERED BY: SCHAUDER BUILDING, INC.  
4115 HIGHWAY 51 NORTH  
JANESVILLE, WISCONSIN  
53545-9674

CLIENT REFERENCE: WOJCIK

NOTE  
LOT WIDTH PARALLEL WITH THE RIGHT-OF-WAY AT THE  
FRONT OF THE RESIDENCE = 65 FEET. 16% OF THIS  
DIMENSION = 10.4' WHICH IS THE MINIMUM SIDEYARD  
SETBACK.

100 YEAR FLOOD ELEV. = 886.00'  
LAKE ELEV. = 884.60' ON 6/29/01

REVISED OCTOBER 7, 2001 TO SHOW EXISTING RESIDENCE "AS BUILT".

Legend

- FOUND IRON PIPE
- FOUND IRON ROD
- FOUND BRASS CAPPED MONUMENT
- FOUND CONCRETE MONUMENT
- CHISEL CUT IN CONCRETE
- SET IRON ROD, 24" LONG, WEIGHING  
1.5 LBS./LINEAL FT., 3/4" DIA.
- SET IRON ROD, 30" LONG, WEIGHING  
4.5 LBS./LINEAL FT., 1-11/16" DIA.
- (xx) RECORDED AS DIMENSION
- EXISTING FENCE

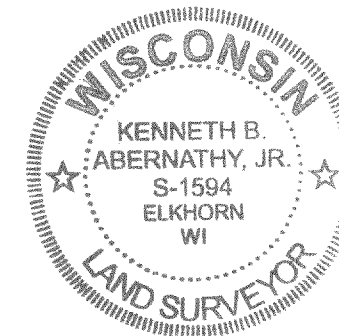

SCALE: 1"=30 FEET

"I hereby certify that the above described property has been surveyed  
by me or under my direction and that the above map is a true  
representation thereof and shows the size and location of the property,  
its exterior boundaries, the location of all visible structures and  
dimensions of all principal buildings thereon, boundary fences, apparent  
easements, roadways and visible encroachments, if any."

"This survey is made for the use of the present owners of the property,  
and also those who purchase, mortgage, or guarantee the title thereto  
within one year from date hereof."

KENNETH B. ABERNATHY, JR.  
WISCONSIN REGISTERED LAND SURVEYOR,  
S-1594

Date: 10/7/01 Job No. 01.604